



# CITY OF SANTA ROSA

## IMPROVEMENT PLANS FOR

# FOUNTAINGROVE PKWY WATER MAIN UPSIZE SOUTH RIDGE DR. AND FIR RIDGE DR.

### GENERAL NOTES

1. ALL WORKMANSHIP, MATERIALS AND CONSTRUCTION SHALL CONFORM TO THE CITY OF SANTA ROSA STANDARD PLANS, THE CONSTRUCTION SPECIFICATIONS FOR PUBLIC IMPROVEMENTS, THE SPECIAL PROVISIONS FOR THIS PROJECT AND THE STATE STANDARD SPECIFICATIONS AND STANDARD PLANS. THE CONTRACTOR IS RESPONSIBLE FOR UNDERSTANDING ALL STANDARDS PERTAINING TO THIS PROJECT.
2. THE CONTRACTOR SHALL CALL UNDERGROUND SERVICE ALERT (USA) AT 1-800-227-2600 NO LESS THAN 2 WORKING DAYS PRIOR TO ANY EXCAVATION FOR MARK OUTS OF EXISTING UNDERGROUND FACILITIES IN ACCORDANCE WITH SECTION 8-1.10 OF THE SPECIAL PROVISIONS.
3. THE LOCATIONS OF UNDERGROUND UTILITIES AND OTHER OBSTACLES SHOWN ON THE PLANS ARE BASED ON THE BEST AVAILABLE INFORMATION. THE CONTRACTOR SHALL POTHOLE AND DETERMINE THE EXACT LOCATION OF ALL POTENTIAL CONFLICTS IN ACCORDANCE WITH U.S.A. LAWS AND THESE SPECIAL PROVISIONS AND THE STANDARD SPECIFICATIONS. IF ANY UNMARKED UTILITIES ARE ENCOUNTERED, OR IF UNABLE TO LOCATE A MARKED UTILITY AFTER POT HOLING, THE CONTRACTOR SHALL IMMEDIATELY NOTIFY THE OWNER OF THAT UTILITY AND THE ENGINEER.
4. ALL SEWER MANHOLES, MAINLINE CLEANOUTS AND WATER VALVES THAT ARE ON ACTIVE SYSTEMS SHALL BE ACCESSIBLE TO CITY PERSONNEL AT ALL TIMES AND SHALL BE BROUGHT TO GRADE WITHIN 48 HOURS OF PAVING.
5. THE CONTRACTOR SHALL PROTECT AND PRESERVE CITY MONUMENTS. THE CONTRACTOR SHALL COORDINATE WITH THE CITY ENGINEER 10 WORKING DAYS IN ADVANCE FOR REFERENCING OF EXISTING MONUMENTS TO BE DISTURBED. THE CONTRACTOR SHALL RECONSTRUCT DISTURBED MONUMENTS IN ACCORDANCE WITH CITY STANDARD 280.
6. OVERHEAD UTILITY SERVICE DROPS ARE NOT SHOWN ON THE PLANS. THE CONTRACTOR SHALL INVESTIGATE THE SITE AND BE AWARE OF LIMITED CLEARANCES UNDER OVERHEAD UTILITY LINES AND LOW HANGING TREE BRANCHES. THE CONTRACTOR'S TRUCKS AND EXCAVATION EQUIPMENT SHALL BE SIZED SO THAT OVERHEAD WIRES AND TREE BRANCHES ARE NOT DAMAGED.
7. ALL EXCAVATED MATERIAL SHALL BE DISPOSED OF AS GENERATED AND AT NO TIME SHALL THE CONTRACTOR PLACE EXCAVATED MATERIAL AT THE WORK SITE.
8. THE CONTRACTOR SHALL ONLY REMOVE EXISTING TREES OR SHRUBS AS NOTED ON THE PLANS OR AS DIRECTED BY THE ENGINEER.
9. FOR CLARITY OF EXISTING SUBSURFACE CONDITIONS, NOT ALL CROSSWALKS, STOP BARS, OR EXISTING PAVEMENT MARKINGS ARE SHOWN ON THE PLANS. TRAFFIC STRIPES, RAISED PAVEMENT MARKERS AND PAVEMENT MARKINGS DAMAGED DUE TO THE CONTRACTOR'S OPERATIONS SHALL BE REPLACED PER CITY OF SANTA ROSA TRAFFIC STANDARDS PART III, TRAFFIC MARKINGS. PATCHING OF DAMAGED MARKINGS WILL NOT BE ALLOWED WITHOUT PRIOR APPROVAL FROM THE ENGINEER. ALL DAMAGED RAISED PAVEMENT (NON-REFLECTIVE) MARKERS MUST BE CERAMIC.

CONTRACT No. C01631

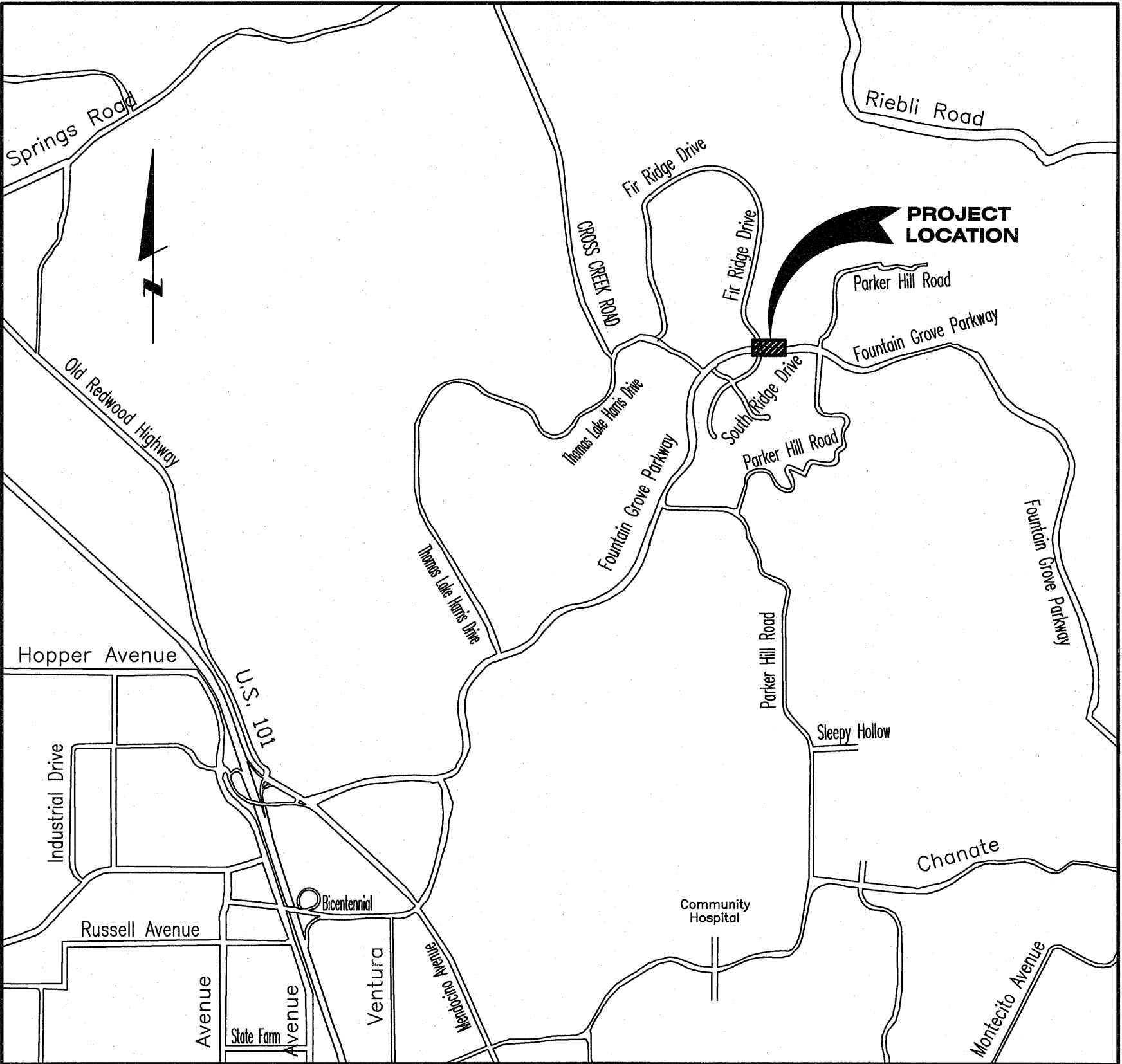

LOCATION MAP  
NOT TO SCALE

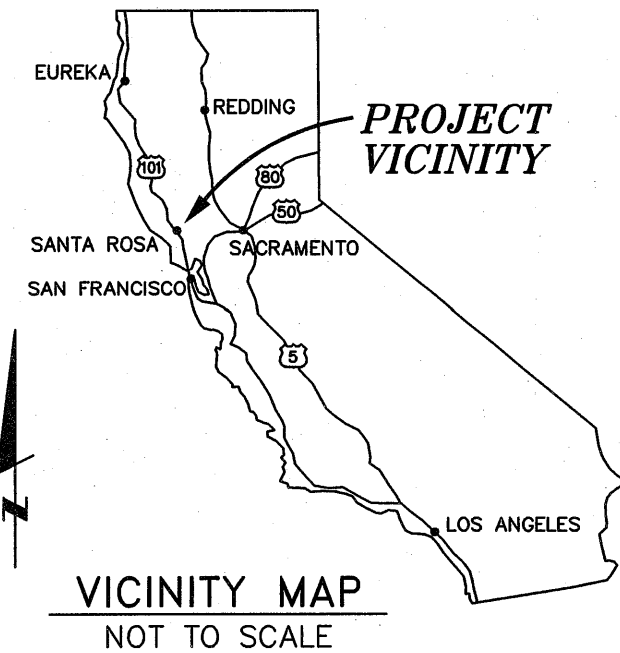

VICINITY MAP  
NOT TO SCALE

### INDEX TO SHEETS

SHEET NO.	TITLE
1.	COVER SHEET
2.	PLAN, LEGEND, ABBREVIATIONS & DETAILS

### BENCH LEVEL DATA

- C-289 FOUNTAINGROVE PKWY., 75 FT. E/O FIR RIDGE, CITY DISK IN WELL  
742.638 MONUMENT, ON ♀ FOUNTAINGROVE, AT A PRC 5/90
- C-288 FOUNTAINGROVE PKWY., SOUTHRIDGE AND FIR RIDGE, CITY DISK IN WELL MONUMENT  
732.772 AT ♀ INTERSECTION (COORDINATE MONUMENT G-473). 5/90

### ABBREVIATIONS

AB	AGGREGATE BASE	LP	LIP OF GUTTER
A.C.	ASPHALT CONCRETE	JNT	JOINT UTILITY TRENCH
BM	BENCHMARK	MAINT.	MAINTENANCE
BSW	BACK OF SIDEWALK	MIN.	MINIMUM
CB	CATCH BASIN	MON	MONUMENT
CL	CENTERLINE	N.I.C.	NOT IN CONTRACT
CONC.	CONCRETE	NTS	NOT TO SCALE
CY	CUBIC YARDS	O.C.	ON CENTER
C.S.P.	CALTRANS STANDARD PLANS	PT	POINT
CSR	CITY OF SANTA ROSA	RC	RELATIVE COMPACTION
DI	DROP INLET	RCP	REINFORCED CONCRETE PIPE
EL/ELEV.	ELEVATION	R/W	RIGHT OF WAY
E	ELECTRICAL	SCWA	SONOMA COUNTY WATER AGENCY
EX.	EXISTING	SD	STORM DRAIN
EG	EXISTING GROUND	SDMH	STORM DRAIN MANHOLE
EP	EDGE OF PAVEMENT	SL	STREET LIGHT
FC	FACE OF CURB	SS	SANITARY SEWER
FG	FINISH GRADE	SSMH	SANITARY SEWER MANHOLE
FL	FLOWLINE	STA	STATION
FSW	FRONT OF SIDEWALK	STD.	STANDARD
FT	FEET	TEL./T	TELEPHONE LINES
G	GAS	TS	TRAFFIC SIGNAL
GV	GATE VALVE	TYP.	TYPICAL
IC	INTERCONNECT (TRAFFIC SIGNAL)	VLT.	VAULT
IG	INVERT GRADE	WTR	WATER
IRR	IRRIGATION	WV	WATER VALVE

### RECORD PLAN DATA

PROJECT START:	WATER SERVICE TYPE: NONE
PROJECT END:	MANUFACTURER: N/A
GEN. CONTRACTOR:	FIRE HYDRANT TYPE: NONE
SUPERINTENDENT:	MANUFACTURER: N/A
UNDERGROUND CONTRACTOR:	INSPECTOR:
FOREMAN:	CONSTRUCTION MANAGER:
SEWER PIPE TYPE: NONE	RECORD PLANS BY:
MANUFACTURER: N/A	ADDITIONAL INFO:
SEWER FITTINGS MANUFACTURER: NONE	
M.H. MANUFACTURER: NONE	
WATER PIPE TYPE:	
MANUFACTURER:	
WATER VALVE MANUFACTURER:	
WATER FITTINGS MANUFACTURER: NONE	

BEFORE EXCAVATING  
CALL U.S.A.  
UNDERGROUND SERVICE ALERT  
800-642-2444  
TWO WORKING DAYS BEFORE ALL  
PLANNED WORK OPERATIONS



Design/Const.	Survey	TPW	Field Svc's	Utilities Op's	Traffic	Parks	Signature	Dept.	Revision	By	Date

DATE: AUGUST 24, 2016	SCALE: 1" = 20'	DWN BY: CDA	CHK BY: CCC
APPROVED: Deputy Director - Engineering By: <i>Colleen Ferguson</i> Date: 8/24/2016			

CITY OF SANTA ROSA	FOUNTAINGROVE PKWY WATER MAIN UPSIZE	COVER SHEET
--------------------	--------------------------------------	-------------

CONTRACT NO. C01631
SHEET 01 OF 02
FILE NO. 2016-0014



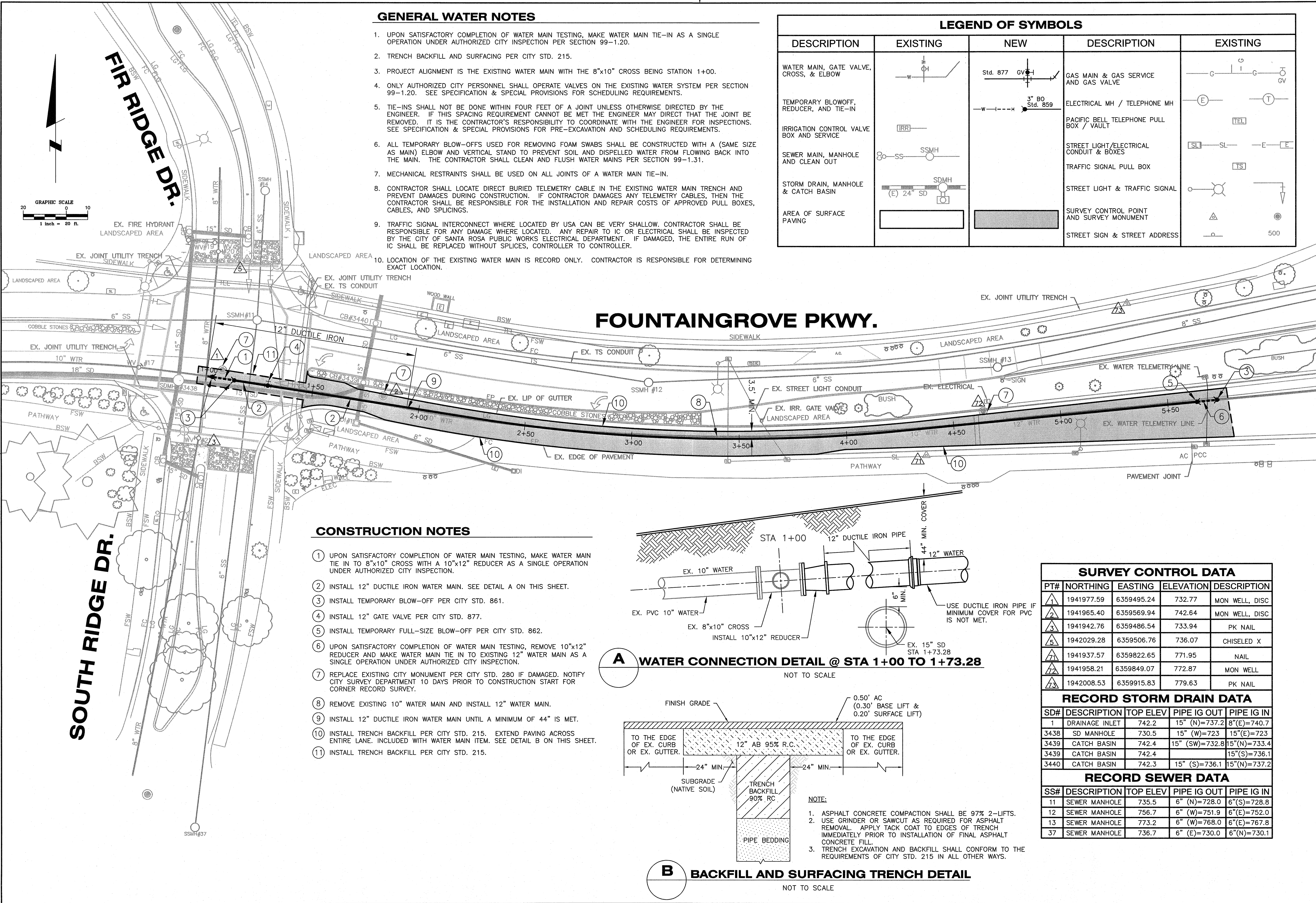

GENERAL WATER NOTES

- UPON SATISFACTORY COMPLETION OF WATER MAIN TESTING, MAKE WATER MAIN TIE-IN AS A SINGLE OPERATION UNDER AUTHORIZED CITY INSPECTION PER SECTION 99-1.20.
- TRENCH BACKFILL AND SURFACING PER CITY STD. 215.
- PROJECT ALIGNMENT IS THE EXISTING WATER MAIN WITH THE 8"x10" CROSS BEING STATION 1+00.
- ONLY AUTHORIZED CITY PERSONNEL SHALL OPERATE VALVES ON THE EXISTING WATER SYSTEM PER SECTION 99-1.20. SEE SPECIFICATION & SPECIAL PROVISIONS FOR SCHEDULING REQUIREMENTS.
- TIE-INS SHALL NOT BE DONE WITHIN FOUR FEET OF A JOINT UNLESS OTHERWISE DIRECTED BY THE ENGINEER. IF THIS SPACING REQUIREMENT CANNOT BE MET THE ENGINEER MAY DIRECT THAT THE JOINT BE REMOVED. IT IS THE CONTRACTOR'S RESPONSIBILITY TO COORDINATE WITH THE ENGINEER FOR INSPECTIONS. SEE SPECIFICATION & SPECIAL PROVISIONS FOR PRE-EXCAVATION AND SCHEDULING REQUIREMENTS.
- ALL TEMPORARY BLOW-OFFS USED FOR REMOVING FOAM SWABS SHALL BE CONSTRUCTED WITH A (SAME SIZE AS MAIN) ELBOW AND VERTICAL STAND TO PREVENT SOIL AND DISPELLED WATER FROM FLOWING BACK INTO THE MAIN. THE CONTRACTOR SHALL CLEAN AND FLUSH WATER MAINS PER SECTION 99-1.31.
- MECHANICAL RESTRAINTS SHALL BE USED ON ALL JOINTS OF A WATER MAIN TIE-IN.
- CONTRACTOR SHALL LOCATE DIRECT BURIED TELEMETRY CABLE IN THE EXISTING WATER MAIN TRENCH AND PREVENT DAMAGES DURING CONSTRUCTION. IF CONTRACTOR DAMAGES ANY TELEMETRY CABLES, THEN THE CONTRACTOR SHALL BE RESPONSIBLE FOR THE INSTALLATION AND REPAIR COSTS OF APPROVED PULL BOXES, CABLES, AND SPLICINGS.
- TRAFFIC SIGNAL INTERCONNECT WHERE LOCATED BY USA CAN BE VERY SHALLOW. CONTRACTOR SHALL BE RESPONSIBLE FOR ANY DAMAGE WHERE LOCATED. ANY REPAIR TO IC OR ELECTRICAL SHALL BE INSPECTED BY THE CITY OF SANTA ROSA PUBLIC WORKS ELECTRICAL DEPARTMENT. IF DAMAGED, THE ENTIRE RUN OF IC SHALL BE REPLACED WITHOUT SPLICES, CONTROLLER TO CONTROLLER.
- LOCATION OF THE EXISTING WATER MAIN IS RECORD ONLY. CONTRACTOR IS RESPONSIBLE FOR DETERMINING EXACT LOCATION.

LEGEND OF SYMBOLS

DESCRIPTION	EXISTING	NEW	DESCRIPTION	EXISTING
WATER MAIN, GATE VALVE, CROSS, & ELBOW			GAS MAIN & GAS SERVICE AND GAS VALVE	
TEMPORARY BLOWOFF, REDUCER, AND TIE-IN			ELECTRICAL MH / TELEPHONE MH	
IRRIGATION CONTROL VALVE BOX AND SERVICE			PACIFIC BELL TELEPHONE PULL BOX / VAULT	
SEWER MAIN, MANHOLE AND CLEAN OUT			STREET LIGHT/ELECTRICAL CONDUIT & BOXES	
STORM DRAIN, MANHOLE & CATCH BASIN			TRAFFIC SIGNAL PULL BOX	
AREA OF SURFACE PAVING			STREET LIGHT & TRAFFIC SIGNAL	
			SURVEY CONTROL POINT AND SURVEY MONUMENT	
			STREET SIGN & STREET ADDRESS	

FOUNTAINGROVE PKWY.

CONSTRUCTION NOTES

- UPON SATISFACTORY COMPLETION OF WATER MAIN TESTING, MAKE WATER MAIN TIE IN TO 8"x10" CROSS WITH A 10"x12" REDUCER AS A SINGLE OPERATION UNDER AUTHORIZED CITY INSPECTION.
- INSTALL 12" DUCTILE IRON WATER MAIN. SEE DETAIL A ON THIS SHEET.
- INSTALL TEMPORARY BLOW-OFF PER CITY STD. 861.
- INSTALL 12" GATE VALVE PER CITY STD. 877.
- INSTALL TEMPORARY FULL-SIZE BLOW-OFF PER CITY STD. 862.
- UPON SATISFACTORY COMPLETION OF WATER MAIN TESTING, REMOVE 10"x12" REDUCER AND MAKE WATER MAIN TIE IN TO EXISTING 12" WATER MAIN AS A SINGLE OPERATION UNDER AUTHORIZED CITY INSPECTION.
- REPLACE EXISTING CITY MONUMENT PER CITY STD. 280 IF DAMAGED. NOTIFY CITY SURVEY DEPARTMENT 10 DAYS PRIOR TO CONSTRUCTION START FOR CORNER RECORD SURVEY.
- REMOVE EXISTING 10" WATER MAIN AND INSTALL 12" WATER MAIN.
- INSTALL 12" DUCTILE IRON WATER MAIN UNTIL A MINIMUM OF 44" IS MET.
- INSTALL TRENCH BACKFILL PER CITY STD. 215. EXTEND PAVING ACROSS ENTIRE LANE. INCLUDED WITH WATER MAIN ITEM. SEE DETAIL B ON THIS SHEET.
- INSTALL TRENCH BACKFILL PER CITY STD. 215.

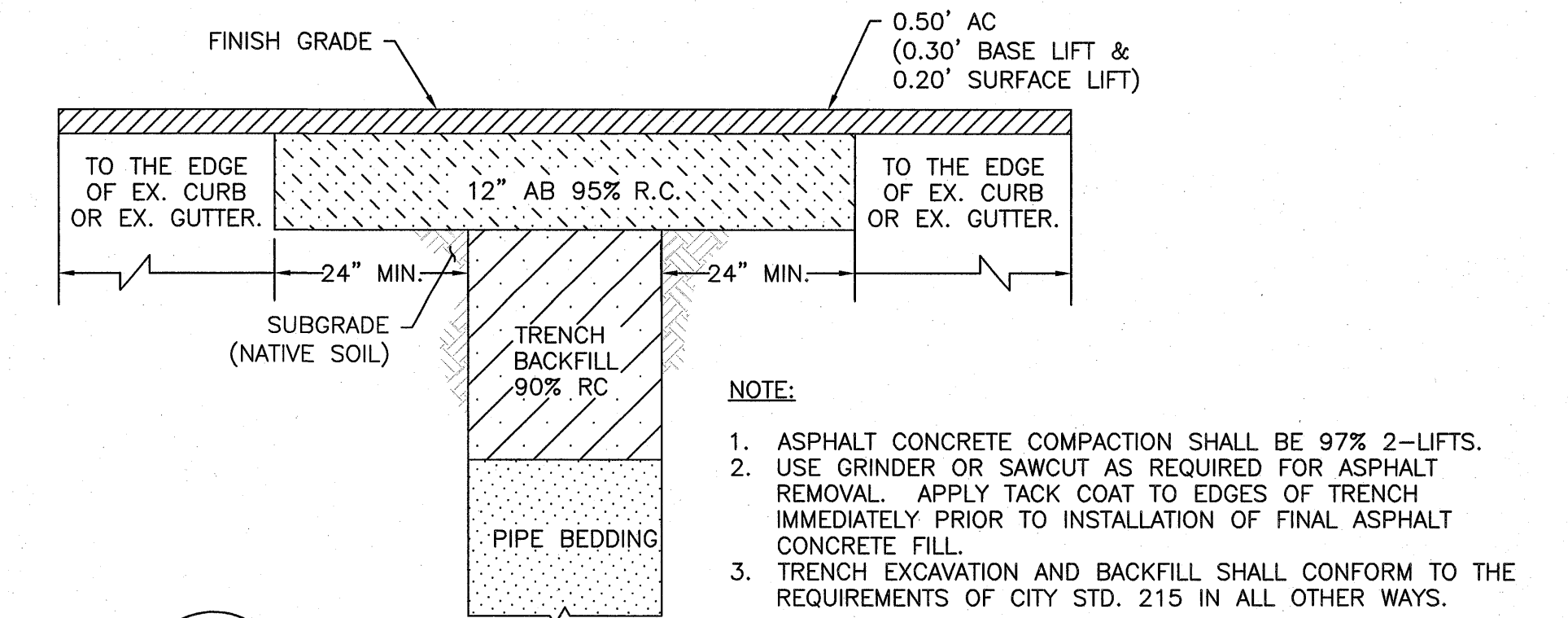
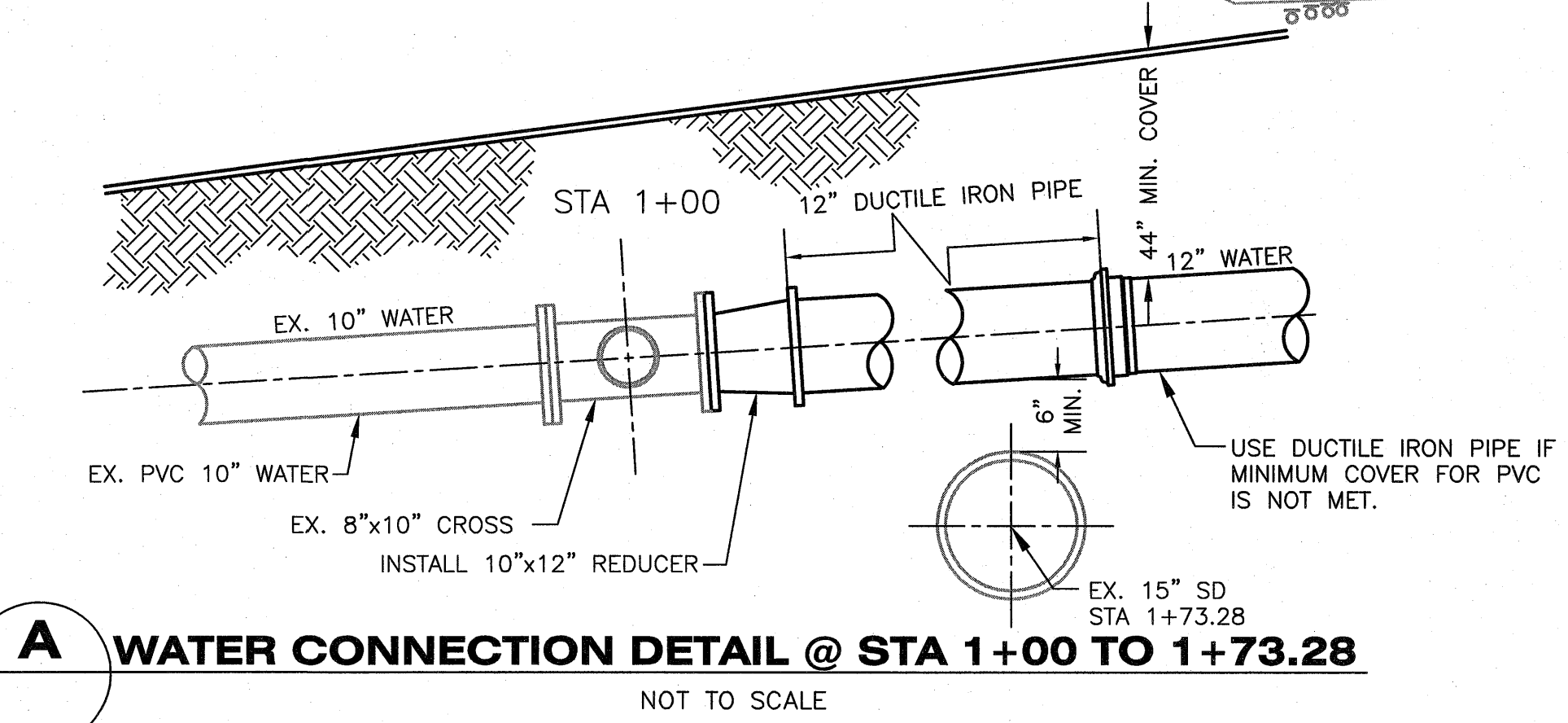

SURVEY CONTROL DATA				
PT#	NORTHING	EASTING	ELEVATION	DESCRIPTION
1	1941977.59	6359495.24	732.77	MON WELL, DISC
2	1941965.40	6359569.94	742.64	MON WELL, DISC
3	1941942.76	6359486.54	733.94	PK NAIL
4	1942029.28	6359506.76	736.07	CHISELED X
5	1941937.57	6359822.65	771.95	NAIL
6	1941958.21	6359849.07	772.87	MON WELL
7	1942008.53	6359915.83	779.63	PK NAIL

RECORD STORM DRAIN DATA				
SD#	DESCRIPTION	TOP ELEV	PIPE IG OUT	PIPE IG IN
1	DRAINAGE INLET	742.2	15" (N)=737.2	8"(E)=740.7
3438	SD MANHOLE	730.5	15" (W)=723	15"(E)=723
3439	CATCH BASIN	742.4	15" (SW)=732.8	15"(N)=733.4
3439	CATCH BASIN	742.4		15"(S)=736.1
3440	CATCH BASIN	742.3	15" (S)=736.1	15"(N)=737.2

RECORD SEWER DATA				
SS#	DESCRIPTION	TOP ELEV	PIPE IG OUT	PIPE IG IN
11	SEWER MANHOLE	735.5	6" (N)=728.0	6"(S)=728.8
12	SEWER MANHOLE	756.7	6" (W)=751.9	6"(E)=752.0
13	SEWER MANHOLE	773.2	6" (W)=768.0	6"(E)=767.8
37	SEWER MANHOLE	736.7	6" (E)=730.0	6"(N)=730.1

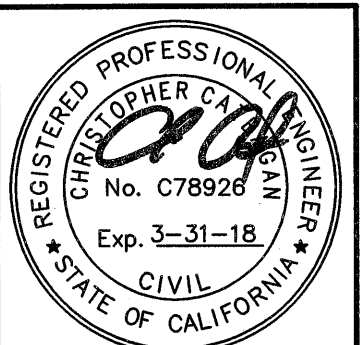

City of Santa Rosa

NO.	DATE	REVISION	BY

SCALE: 1"=20'	DATE: AUGUST 24, 2016	CHK BY: CCC
DWN BY: CDA		
APPROVED: Deputy Director - Engineering		
By: <i>Colleen Ferguson</i> Date: 8/24/2016		

CITY OF SANTA ROSA	CONTRACT NO. C01631
FOUNTAINGROVE PKWY WATER MAIN UPSIZE	SHEET 02 OF 02
PLAN, LEGEND, ABBREVIATIONS & DETAILS	FILE NO. 2016-0014