



MENDOCINO AVE AND McCONNELL AVE INTERSECTION PEDESTRIAN IMPROVEMENTS

MENDOCINO AVE AND MCCONNELL AVE INTERSECTION PEDESTRIAN IMPROVEMENTS		SCALE: NONE		DATE: 6-11-2018	
COVER SHEET		APPROVED: Deputy Director - Engineering By: <u>Lori Urbanek</u> Date <u>6/18/18</u> LORI URBANEK			
CONTRACT NO. C02059		DESIGN/CONST SURVEY TPW, FIELD SVCS TRAFFIC STORM WATER NO. DATE BY REVISION SIGNATURE DATE			
SHEET 1 OF 4		6/12/18 6/12/18 6/18/18 6/19/18 N/A			
FILE # 2018-0033					

ABAN	AGGREGATE BASE	FDC	FIRE DEPARTMENT CONNECTION	PT	POINT
ABANDONED		FES	FLARED END SECTION	PVC	POLYVNYL CHLORIDE
ABS	ACRYLONITRILE-BUTADIENE-STYRENE	FG	FINISHED GRADE	PVMT	PAVEMENT
AC	ASPHALT CONCRETE	FH	FIRE HYDRANT	R	RADIUS
ACP	ASBESTOS CONCRETE PIPE	FL	FLOWLINE	RC	RELATIVE COMPACTION
ADD'L	ADDITIONAL	FSW	FRONT OF SIDEWALK	REF	REFERENCE
ANG	ANGLE	FT	FOOT or FEET	REINF	REINFORCING
AP	ANGLE POINT	FTG	FOOTING	REQ'D	REQUIRED
APN	ASSESSORS PARCEL NUMBER	GALV	GALVANIZED	RCP	REINFORCED CONCRETE PIPE
APPROX	APPROXIMATELY	GB	GRADE BREAK	RD	ROAD
ARV	AIR RELIEF VALVE	GV	GATE VALVE	ROW	RIGHT OF WAY
ASNS	ADVANCED STREET NAME SIGN	HD	HEAVY DUTY	RPM	RAISED PAVEMENT MARKER
AVE	AVENUE	HDPE	HIGH DENSITY POLYETHYLENE	RT	RIGHT
AVG	AVERAGE	HORIZ	HORIZONTAL	S	SLOPE
BC	BEGIN CURVE	HP	HIGH POINT	(S)	SOUTH
BFP	BACK FLOW PREVENTER	HPS	HIGH PRESSURE SODIUM	SD	STORM DRAIN
BLDG	BUILDING	HT	HEIGHT	SDMH	STORM DRAIN MANHOLE
BLVD	BOULEVARD	IC	INTERCONNECT	SF	SQUARE FEET
BM	BENCH MARK	ID	INSIDE DIAMETER	SG	SUBGRADE
BO	BLOW OFF	INV	INVERT ELEVATION	SHT	SHEET
BOC	BACK OF CURB	IP	IRON PIPE	SIG	SIGNAL
BRC	BEGIN REVERSE CURVE	IRR	IRRIGATION	SIM	SIMILAR
BSW	BACK OF SIDEWALK	JB	JUNCTION BOX	SL	STREET LIGHT
BW	BOTTOM OF WALL	JP	JOINT POLE	SPEC	SPECIFICATION
BVC	BEGIN VERTICAL CURVE	JT	JOINT TRENCH	SQ	SQUARE
CB	CONDUIT	KV	KILOVOLT	SS	SANITARY SEWER
C	CATCH BASIN	L	LENGTH	SSCO	SANITARY SEWER CLEANOUT
C&G	CURB AND GUTTER	LAT	LATERAL	SSMH	SANITARY SEWER MANHOLE
ODF	CONTROLLED DENSITY FILL	LED	LIGHT EMITTING DIODE	ST	STREET
QIP	CAST IRON PIPE	LF	LINEAL FOOT	STA	STATION
CL	CENTERLINE	LG	LIP OF GUTTER	STD	STANDARD
CLR	CLASS	LL	LANE LINE	SVC	SERVICE
CMP	CLEAR	LMA	LUMINAIRE MAST ARM	SW	SIDEWALK
CMP	CORRUGATED METAL PIPE	LN	LANE	SWL	SOLID WHITE LINE
CMU	CONCRETE MASONRY UNIT	LP	LOW POINT	TEL	TELEPHONE
CO	CLEANOUT	LT	LEFT	TAN	TANGENT
CONC	CONCRETE	LUM	LUMINAIRE	TBM	TEMPORARY BENCHMARK
CONST	CONSTRUCTION	MAX	MAXIMUM	TC	TOP OF CONCRETE
CONT	CONTINUOUS	MB	MAIL BOX	TCC	TOP OF CURB ELEVATION
CP	CONTROL POINT	MH	MAN HOLE	TCE	TEMPORARY CONSTRUCTION EASEMENT
CT	COURT	MIN	MINIMUM	THK	THICK
CTB	CEMENT TREATED BASE	MISC	MISCELLANEOUS	TG	TOP OF GRATE
CTR	CENTER	MON	MONUMENT	TOC	TOP OF CURB
CY	CUBIC YARD	(N)	NORTH	TP	TOP OF WALL
DCV	DETECTOR CHECK VALVE	N/A	NOT AVAILABLE/APPLICABLE	TI	TOP OF PIPE
DI	DROP INLET	NIC	NOT IN CONTRACT	TS	TRAFFIC SIGNAL
DIP	DUCTILE IRON PIPE	NO	NUMBER	TWLT	TWO WAY LEFT TURN LANE
DH	DETECTOR HANDHOLE	NTS	NOT TO SCALE	TYP	TYPICAL
DIA	DIAMETER	OC	ON CENTER	UC	UTILITY CHASE
DLC	DETECTOR LOOP CONDUIT	OD	OUTSIDE DIAMETER	UC	UNDERGROUND
DR	DRIVE	OH	OVERHEAD	UNO	UNLESS NOTED OTHERWISE
DWG	DRAWING	PB	PULL BOX	V	VOLT
DWR	DASHED WHITE PAVEMENT MARKER	PCC	PORTLAND CEMENT CONCRETE	VC	VERTICAL CURVE
DWY	DRIVEWAY	PEC	PHOTO ELECTRIC CONTROL	VCP	VITRIFIED CLAY PIPE
DY	DOUBLE YELLOW	PED	PEDESTRIAN	VERT	VERTICAL
YR	DASHED YELLOW PAVEMENT MARKER	PI	POINT OF INTERSECTION	VG	VALLEY GUTTER
(E)	EAST	PIV	POST INDICATOR VALVE	VL	VAULT
EX	EXISTING	PL	PROPERTY LINE	W	WATT OR WALK
EJA	EACH	POC	POINT ON CURVE	(W)	WEST
EC	END OF CURVE	POCC	POINT OF COMPOUND CURVE	W/	WITH
EG	EXISTING GROUND	POVC	POINT ON VERTICAL CURVE	W/O	WITHOUT
ELEC	ELECTRICAL	PVI	POINT OF VERTICAL INTERSECTION	WBD	WALL BACK DRAIN
ELEV	ELEVATION	PP	POWER POLE	WM	WATER METER
EP	EDGE OF PAVEMENT	PPB	PEDESTRIAN PUSH BUTTON	WS	WATER SERVICE
EQ	EQUAL	PR	PAIR	WSS	WATER SAMPLING STATION
ESMT	EASEMENT	PRV	PRESSURE REDUCING VALVE	WTR	WATER
EVC	END VERTICAL CURVE	PSD	PERFORATED SUBDRAIN	WV	WATER VALVE
FIRE	FLARE	PUE	PUBLIC UTILITY EASEMENT	WWF	WELDED WIRE FABRIC
FC	FACE OF CURB			WY	WAY
				YD	YARD

	EXISTING	PROPOSED
DOUBLE YELLOW LINE	=====	=====
ELECTRIC	---E-----E---	
GAS	---G-----G---	
INTERCONNECT CONDUIT	---IC-----IC---	---IC-----IC---
LANE LINE	=====	
PROPERTY LINE	=====	
TELEPHONE	---TEL-----TEL---	
TRAFFIC SIGNAL CONDUIT	---TSC-----TSC---	---TSC-----TSC---
TWO WAY LEFT TURN LANE	=====	
STORM DRAIN	=====	
WATER	---W-----W---	

1. Locate traffic signal standards as shown on the plans and in the pole schedule.
2. The Contractor shall install conduit and conductors into the P.G.&E. splice box prior to P.G.&E. service splice per City Std. 733A at the location shown on the plans.
3. All loops shall be installed a minimum of two feet from the nearest edge of any manhole, valve, or monument.
4. Install conduit with minimum cover per the special provisions. Where signal conduit cannot be installed with minimum cover above existing utilities, it must be installed under existing utilities.
5. Trenches less than 12" wide shall be backfilled per City Std. 215, Narrow Trench, except that the CDF shall be a two sack cement sand slurry. Mendocino Ave is an Arterial, and McConnell Ave is a Local.
6. Trenches 12" and wider shall be backfilled per City Std. 215. Mendocino Ave is an Arterial, and McConnell Ave is a Local.
7. All spoils shall be removed as they are generated and disposed of off-site as required in the Special Provisions.
8. The Contractor shall hand dig trenches at crossings with existing conduit and other utilities.
9. Record plans indicate the existing street sections are composed of the following; Mendocino Ave, 1.0' of asphalt concrete over 0.5' of class two base.
10. Pedestrian heads shall be LED with count down feature in compliance with the provisions of MUTCD section 4E.07, "Countdown Pedestrian Signals". LED symbols shall be solid LED patterns. "Outline" patterns are not acceptable. Numerical units shall have a width of two LEDs, minimum 9 " tall. Single width numbers are not permitted.
11. Pedestrian push buttons shall be ADA compatible, IN2 2-Wire Polara Navigator System or approved equal.
12. Two 2" conduits shall be installed for traffic signal interconnect at the locations shown on the plans. One conduit shall contain a pull tape per State std. section 86-2.05C and the other shall contain two-25 pair of twisted shielded 19 gauge copper IMSA 40-2 cable with copper shielding the around the cable core. Each pair shall be color coded or numbered by pairs per 40-2 specification and installed with no splices. Terminal strips shall be installed in the new and existing controller cabinet(s), and the cable attached to the terminal strips in an organized and neat and consistent manner so communication through the system is complete after installation.
13. Optical detector Global Traffic Technologies (GTT) Opticom Model 721, or approved equal shall be provided and installed by the Contractor ten feet from the approved traffic signal mastarm at the locations shown on the plans. A phase selector GTT Opticom Model 764 four channel or approved equal shall be provided by the Contractor and installed by the City. Lead-in cable GTT Model 138 or approved equal shall be installed at the locations indicated on the Contractor Schedule.
14. Existing equipment not to be reused shall become the property of the Contractor, except for equipment called out on the plans to be salvaged shall be returned to the City Municipal Services Center, 55 Stony Point Road,
15. Existing street name and regulatory signs mounted on traffic signal mastarms and signal poles will be remounted on new signal mastarms and poles by the City. New G-7 street name and regulatory signs and brackets will be provided and installed on the signal mast arms by the City at the locations shown on the plans. New street name signs and traffic regulatory signs and hardware which are not to be mounted on traffic signal mastarms or signal poles shall be provided and installed by the Contractor at the locations shown on the plans per City and State stds. Existing street name signs and traffic regulatory signs which are not on traffic signal mastarms or signal poles shall be relocated by the Contractor as directed by the Engineer.

C-135 Carr Ave. and Slater St.; City Disk in well monument on CL Carr Ave., 5ft W/o
159.438 CL Slater St. 4/81

CONTROL DATA				
POINT	NORTHING	EASTING	ELEV	DESCRIPTION
CP #1	1928207.995	6356233.861	160.74	CUT "X" MIDDLE MEDIAN ISLAND, MENDOCINO AVE S/O McCONNELL
CP #2	1928463.210	6356211.554	159.59	CUT "X" @ TC, W/S MENDOCINO AVE; 44' N/O LGT POLE 4123
CP #3	1928910.287	6356229.663	159.63	CUT "X" @ TC, W/S MENDOCINO AVE, CL CARR AVE EXTENDED



City of
Santa Rosa

[illegible]

SCALE: NONE DATE: 6-11-2018

APPROVED: Deputy Director – Engineering

By Sam J. J. J. Date 6/18/18

LORI URBANEK

**MENDOCINO AVE AND McCONNELL AVE
INTERSECTION PEDESTRIAN IMPROVEMENTS**

Abbreviation and Notes

CONTRACT NO.
C02059

SHEET 2 OF 4

FILE # 2018-0030

CONDUCTOR SCHEDULE									
AWG	CIRCUIT	CONDUIT RUNS							
		1	2	3	4	5	6	7	
No.14	VEH ϕ 1								
	VEH ϕ 2								
	VEH ϕ 3								
	VEH ϕ 4				3		3	3	
	VEH ϕ 5								
	VEH ϕ 6								
	VEH ϕ 7								
	VEH ϕ 8				3	3			
	PED ϕ 2				4	2	2	2	
	PED ϕ 4								
	PED ϕ 6								
	PED ϕ 8								
	PPB ϕ 2				4	2	2	2	
	PPB ϕ 4								
	PPB ϕ 6								
	PPB ϕ 8								
No.8	PPB NEUTRAL				2	1	1	1	
	SIGNAL NEUTRAL					1	1	1	
	P.E.C.	3		3		3			
	SPARES				3		3		
	TOTAL No.14	3		3	19	12	12	9	
No.6	STREET LIGHT	2		2		2	2	2	
	SIGNAL NEUTRAL				1				
	EQUIP. GROUND			1	1	1	1	1	
	TOTAL No.8	2		3	2	3	3	3	
No.4	EQUIP. GROUND	1	1						
	SERVICE	2	2						
No.4	OPTICOM CABLE				2	1	1	1	
	DETECTOR LEAD-IN CABLE								
	VIDEO CABLE				1	1			
CIRCUIT	CONDUIT SIZE	2"	2"	2"	2-3"	2"	3"	2"	
	CONDUIT RUNS	1	2	3	4	5	6	7	

EQUIPMENT SCHEDULE			
LOC	EQUIPMENT	TYPE	DESCRIPTION
①	CONTROLLER	MODEL 2070	PROVIDED BY THE CITY WITH TYPE 332 CABINET
②	SERVICE CABINET	TESCO III BF	EXISTING
③	PULL BOX	30"x48"	CITY TRAFFIC STD. AND DETAIL THIS SHEET
④	PULL BOXES (2 REQ'D)	No. 5	CITY TRAFFIC STD. AND DETAIL THIS SHEET
⑤	PULL BOXES (2 REQ'D)	36"x24"	CLASS 3 COMPOSITE, FLARED SIDEWALL, MIN DEPTH 30 INCHES
⑥	ETHERNET SWITCH	ML684D	PROVIDED BY THE CITY WITH TYPE 332 CABINET
⑦	ETHERNET EXTENDER	ML604D	PROVIDED BY THE CITY WITH TYPE 332 CABINET

POLE SCHEDULE									
LOC	STANDARD TYPE	H.T.	MAST ARM SIG	LUM	LUMINAIRE	SIGNAL MOUNTING			PPB
						VEHICLE	PED	NOTES	
①	19-4-100	30'	25'	12'	LED	SV-1-T SEE DETAIL THIS SHEET	MAT-3 SEE DETAIL THIS SHEET	MAS-3 SEE DETAIL THIS SHEET	SP-1-T
②	19-4-100	30'	25'	12'	LED	SV-1-T SEE DETAIL THIS SHEET	MAT-3 SEE DETAIL THIS SHEET	MAS-3 SEE DETAIL THIS SHEET	SP-1-T

SIGNAL NOTES:

- ALL EXISTING CONDUITS WITH TRAFFIC SIGNAL CONDUCTORS SHALL BE ABANDONED AND HAVE THE CONDUCTORS REMOVED. EXISTING CONDUITS WITH STREETLIGHT CONDUCTORS SHALL REMAIN AND BE OPERATIONAL AT ALL TIMES.

INTERCONNECT NOTES:

- TRAFFIC SIGNAL INTERCONNECT WHERE LOCATED BY USA CAN BE VERY SHALLOW. CONTRACTOR SHALL BE RESPONSIBLE FOR ANY DAMAGE WHERE LOCATED. ANY REPAIR TO INTERCONNECT OR ELECTRICAL SHALL BE INSPECTED BY THE CITY OF SANTA ROSA PUBLIC WORKS ELECTRICAL DEPARTMENT. IF DAMAGED, THE ENTIRE RUN OF INTERCONNECT CABLE SHALL BE REPLACED WITHOUT SPLICE, CONTROLLER TO CONTROLLER, AT THE CONTRACTORS EXPENSE.
- ALL NEW ELBOWS INSTALLED ON EXISTING OR NEW INTERCONNECT CONDUITS SHALL BE 36 INCH LONG RADIUS ELBOWS.

CONSTRUCTION NOTES:

- REMOVE SIGNAL POLE AND MASTARMS. ABANDON FOUNDATION 6" BELOW FINISH SIDEWALK GRADE. W-11 LED SIGN, LUMINAIRE, RADIO ANTENNA AND MOUNT, AND BEACONS ARE TO BE SALVAGED TO THE CITY OF SANTA ROSA AT 55 STONY POINT RD. THE SIGNAL POLE, ARMS AND OTHER EQUIPMENT BECOME THE PROPERTY OF THE CONTRACTOR. SIGNS TO BE RELOCATED, SEE SHEET 4.
- REMOVE SIGNAL POLE. ABANDON FOUNDATION 6" BELOW FINISH SIDEWALK GRADE. CHIRPER IS TO BE SALVAGED TO THE CITY OF SANTA ROSA AT 55 STONY POINT RD. THE SIGNAL POLE, ARMS AND OTHER EQUIPMENT BECOME THE PROPERTY OF THE CONTRACTOR.
- REMOVE SIGNAL POLE. CUT FOUNDATION BOLTS AND CONDUIT FLUSH WITH SIDEWALK. FILL CONDUIT WITH GROUT AND MAKE FLUSH WITH SIDEWALK. GRIND SIDEWALK SMOOTH AS NEEDED. BEACONS, AND CHIRPER ARE TO BE SALVAGED TO THE CITY OF SANTA ROSA AT 55 STONY POINT RD. THE SIGNAL POLE, AND OTHER EQUIPMENT BECOME THE PROPERTY OF THE CONTRACTOR. SIGNS TO BE RELOCATED, SEE SHEET 4.
- REMOVE PEDESTRIAN PUSH BUTTON POLE. CUT FOUNDATION BOLTS AND CONDUIT FLUSH WITH CONCRETE. FILL CONDUIT WITH GROUT AND MAKE FLUSH WITH CONCRETE. GRIND CONCRETE SMOOTH AS NEEDED. THE POLE IS TO BE SALVAGED TO THE CITY OF SANTA ROSA AT 55 STONY POINT RD. ALL OTHER EQUIPMENT BECOME THE PROPERTY OF THE CONTRACTOR.
- REMOVE EXISTING PULL BOX AND INSTALL NEW NUMBER 5 PULL BOX, PER STANDARDS AND DETAIL THIS SHEET.
- REMOVE CONTROLLER CABINET. ABANDON FOUNDATION 6" BELOW FINISH SIDEWALK GRADE. CABINET AND ALL INTERIOR EQUIPMENT ARE TO BE SALVAGED TO THE CITY OF SANTA ROSA AT 55 STONY POINT RD.
- INSTALL 2 - 2 INCH CONDUITS.
- PULL THE EXISTING INTERCONNECT CABLES OUT OF THE EXISTING CONDUITS BETWEEN THE FIRST INTERCONNECT BOX NORTH OF McCONNELL AVE AND THE CONTROLLER AT MENDOCINO AVE / PACIFIC AVE **DO NOT CUT CABLES**. REINSTALL CABLES INTO NEW CONDUITS TO THE NEW CONTROLLER CABINET AT McCONNELL. ALL CONDUCTORS SHALL BE LANDED IN BOTH CONTROLLERS PER THE CITY STANDARDS AND THE SPECIAL PROVISIONS. EXCESS CABLE SHALL BE CUT OFF AND BECOME THE PROPERTY OF THE CONTRACTOR.
- INSTALL TWO NEW 25 PAIR INTERCONNECT CABLES PER SPECIAL PROVISIONS, IN THE EXISTING AND NEW CONDUITS BETWEEN THE NEW CONTROLLER AT MENDOCINO AVE / McCONNELL AVE AND THE EXISTING TRAFFIC SIGNAL CONTROLLER AT MENDOCINO AVE / PACIFIC AVE. ALL CONDUCTORS SHALL BE LANDED IN BOTH CONTROLLERS PER THE CITY STANDARDS AND THE SPECIAL PROVISIONS.
- THE EXISTING INTERCONNECT CONDUITS ARE 2 - 3 INCH CONDUITS.
- PROTECT SIDEWALK DRAIN IN PLACE.
- RELOCATE THE GAS ANODE OUT SIDE OF SIGNAL POLE FOUNDATION.

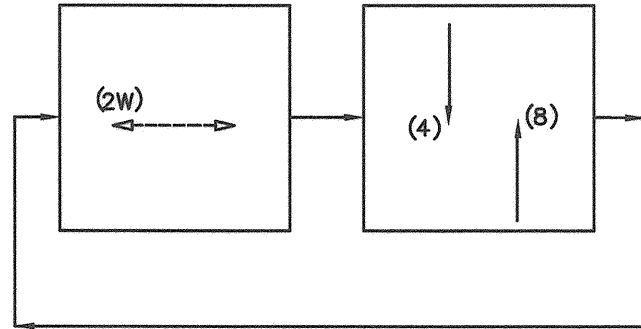

PROPOSED PHASE DIAGRAM

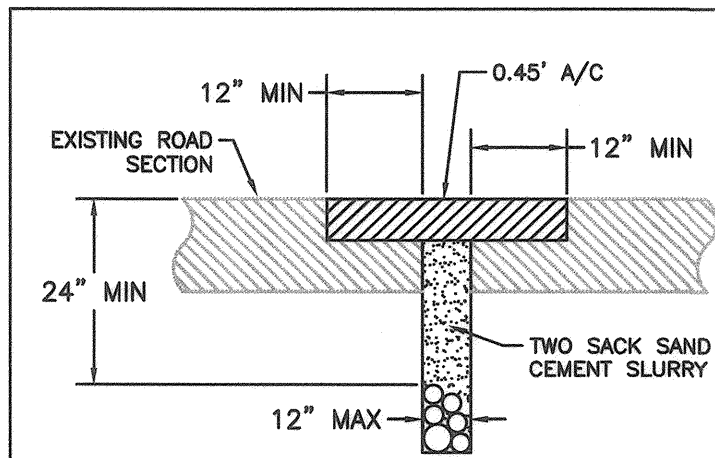
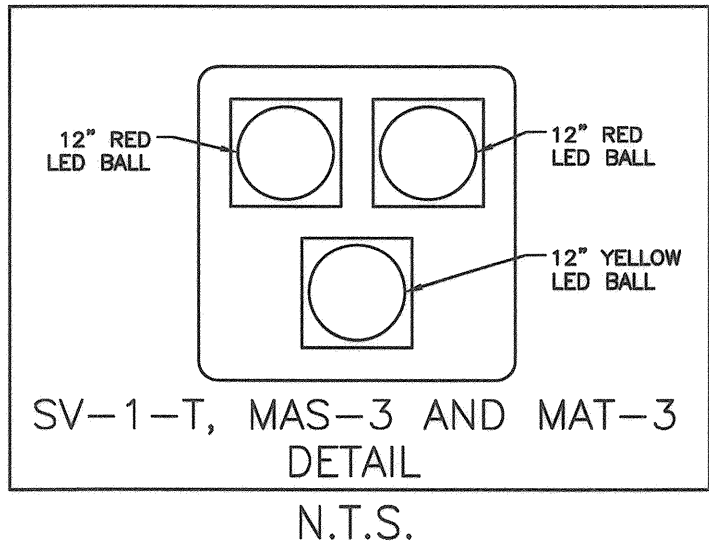

NARROW TRENCH DETAIL
ALL STREET CROSSINGS
AND NOT ADJACENT TO CURB

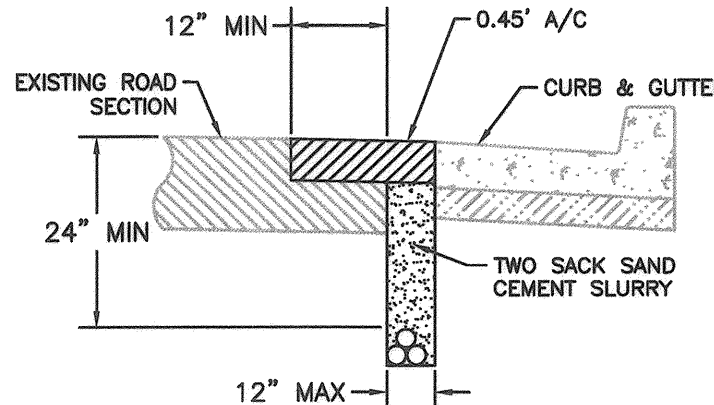

NARROW TRENCH DETAIL
ADJACENT TO CURBS
WITH NO BIKE LANES

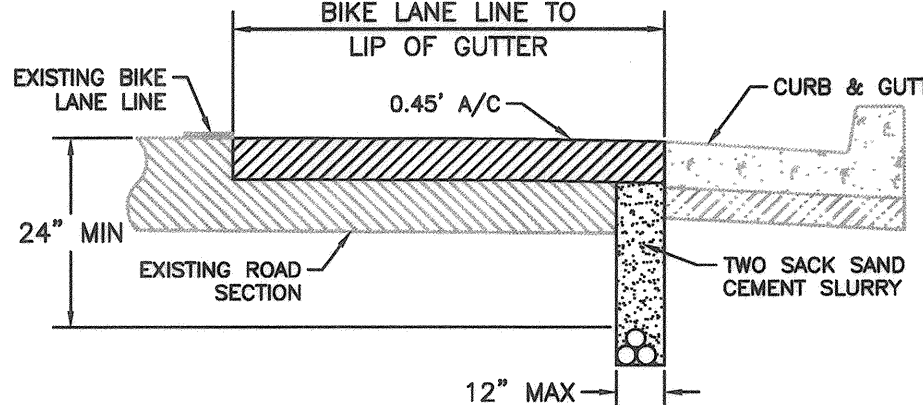

NARROW TRENCH DETAIL
ADJACENT TO CURBS
WITH BIKE LANES

N.T.S.

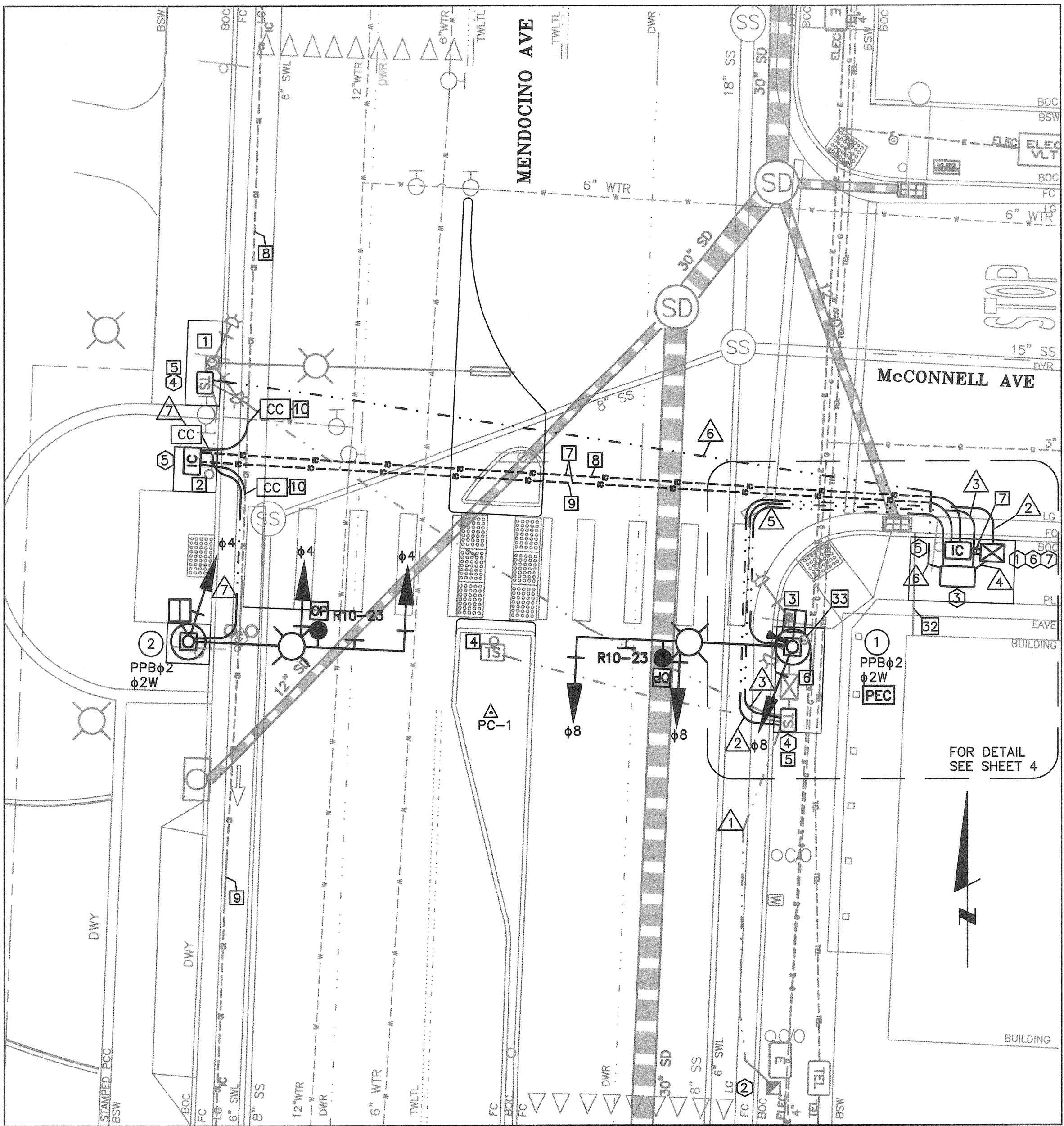

ELECTRICAL PLAN
1" = 10'

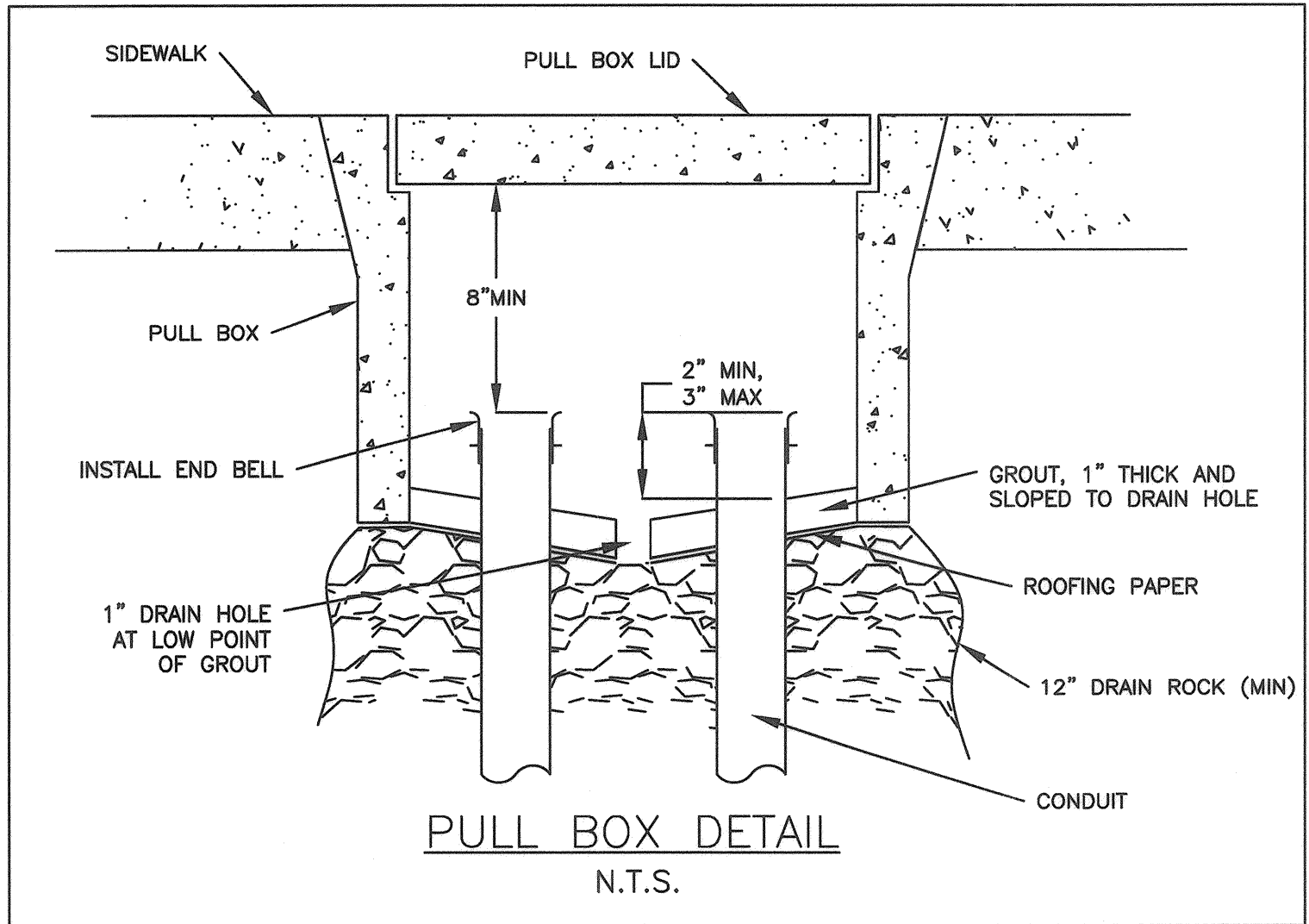

PULL BOX DETAIL
N.T.S.



City of
Santa Rosa

NO.	DATE	REVISION	BY

SCALE: 1" = 10' DATE: 6-11-2018

APPROVED: Deputy Director - Engineering
By *Lori Urbanek* Date *6/18/18*
LORI URBANEK

MENDOCINO AVE AND McCONNELL AVE
INTERSECTION PEDESTRIAN IMPROVEMENTS

CONTRACT NO.
C02059

SHEET 3 OF 4

FILE # 2018-0030

Electrical Plan

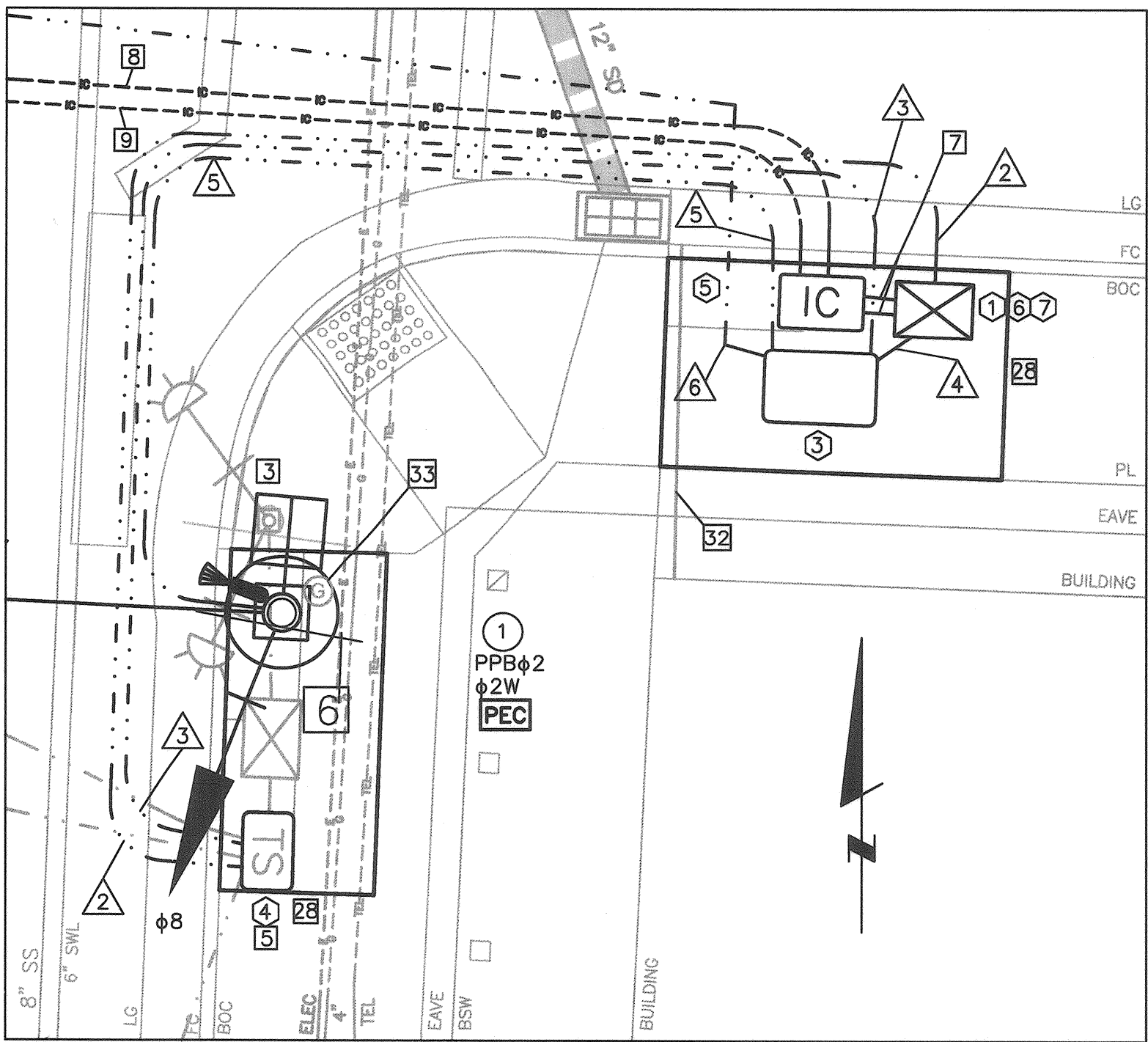

CORNER DETAIL
1" = 5'

SIGNING AND STRIPING NOTES

- 1 RELOCATE SIGN(S) TO NEW SIGNAL POLE AS SHOWN AND AS DIRECTED BY THE ENGINEER.
- 2 RELOCATE SIGN TO EXISTING 2 INCH POLE AS SHOWN AND AS DIRECTED BY THE ENGINEER. A POLE EXTENSION MAY BE NEEDED.
- 3 REMOVE SIGNS AND POLE. SIGNS SHALL BE SALVAGED TO THE CITY OF SANTA ROSA AT 55 STONY POINT RD, THE POLES BECOME THE PROPERTY OF THE CONTRACTOR.
- 4 INSTALL NEW SIGN ON NEW 2 INCH POLE AS SHOWN AND AS DIRECTED BY THE ENGINEER, ON THE ISLAND. THE SIZE OF THE R3-2 SIGN SHALL BE 24"x24".
- 5 INSTALL NEW SIGN ON EXISTING 2 INCH POLE AS SHOWN AND AS DIRECTED BY THE ENGINEER. THE SIZE OF THE R3-SR SIGN SHALL BE 30"x36".
- 6 REMOVE LEFT TURN ARROW.
- 7 INSTALL WHITE THERMOPLASTIC ARROW. MATCH EXISTING ARROW STYLE AND SIZE.
- 8 REMOVE YIELD LINE.
- 9 INSTALL 12 INCH WHITE THERMOPLASTIC STOP BAR.
- 10 INSTALL ISLAND NOSE TREATMENT PER CITY STANDARD, EXCEPT THAT PAINT COLOR AND RPMs SHALL BE YELLOW, AND THE PAINT LIMITS SHALL BE EXTENDED AS SHOWN.
- 11 INSTALL TYPE H RPM EVERY 10 FEET ON THE ASPHALT AS SHOWN AND AS DIRECTED BY THE ENGINEER.
- 12 REMOVE 2-INCH SIGN POST. POST TO BECOME PROPERTY OF THE CONTRACTOR.
- 13 INSTALL TYPE G RPM EVERY 10 FEET ON THE ASPHALT AS SHOWN AND AS DIRECTED BY THE ENGINEER.
- 14 INSTALL 5 SURFACE MOUNT TYPE Q MARKERS, STARTING 3 FEET FROM THE ISLAND NOSE AND 3 FEET ON CENTER.
- 15 INSTALL DETAIL 33, FROM END OF EXISTING TO ISLAND NOSE.
- 16 INSTALL DETAIL 23, AS SHOWN AND AS DIRECTED BY THE ENGINEER.
- 17 INSTALL 12 SURFACE MOUNT TYPE Q MARKERS, STARTING AT THE ISLAND NOSE AND CONTINUING 3 FEET ON CENTER.
- 18 REMOVE R1-5 SIGN. SIGN SHALL BE SALVAGED TO THE CITY OF SANTA ROSA AT 55 STONY POINT RD. INSTALL NEW SIGN ON EXISTING 2 INCH POLE AS SHOWN AND AS DIRECTED BY THE ENGINEER. THE SIZE OF THE R10-6 SIGN SHALL BE 24"x24".

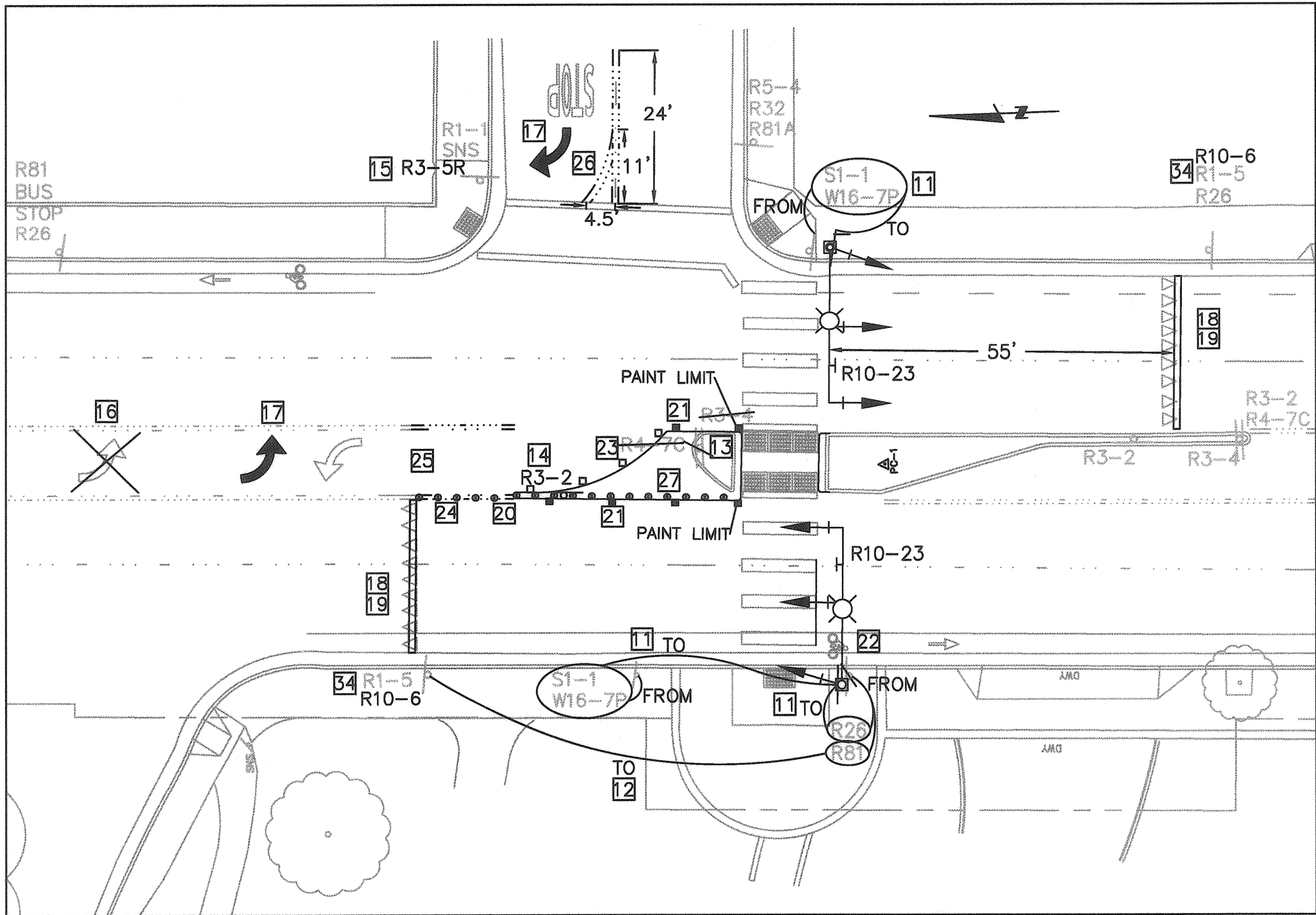

SIGNING AND STRIPING PLAN
1" = 20'

SITE NOTES

- 28 CUT SIDEWALK AT JOINTS. REPLACE SIDEWALK AND MATCH JOINT PATTERNS AND FINISH.
- 29 REMOVE EXISTING ISLAND AND PLUG ASPHALT.
- 30 INSTALL CONCRETE ISLAND EXTENSION, FROM END OF EXISTING ISLAND TO EDGE OF TRUNCATED DOMES. HEIGHT OF CURB SHALL MATCH THE HEIGHT OF EXISTING ISLAND. DOWEL HORIZONTALLY INTO EXISTING ISLAND AND VERTICALLY INTO THE SURFACE. DOWELS SHALL BE #4 BARS, 9" LONG AND PLACED 2.5' ON CENTER.
- 31 INSTALL 7" TALL CONCRETE ISLAND. DOWEL ISLAND INTO THE ASPHALT. DOWELS SHALL BE VERTICAL #4 BARS, 9" LONG AND PLACED 2.5' ON CENTER IN BOTH DIRECTIONS STARTING NO FURTHER THAN 6" FROM EDGE OF ISLAND.

POINT TABLE				
POINT	NORTHING	EASTING	DESCRIPTION	
101	1928218.2571	6356299.8819	TOC BC	
102	1928218.7331	6356230.4074	TOC EC	
103	1928218.3095	6356238.5400	TOC BC	
104	1928217.7834	6356239.0133	TOC EC	
201	1928231.1410	6356229.4720	TOC BC	
202	1928231.6651	6356228.9974	TOC EC	
203	1928266.8481	6356230.7420	TOC BC	
204	1928267.3233	6356231.2414	TOC MID POINT CURVE	
205	1928266.7986	6356231.7408	TOC EC	
206	1928266.8233	6356231.2414	RADIUS POINT, 0.5'R	
207	1928262.8414	6356231.5445	TOC BC	
208	1928262.8414	6356259.5445	RADIUS POINT, 28'R	
209	1928242.1756	6356240.0778	TOC EC/BC	
210	1928242.3338	6356240.2297	TOC EC	
211	1928231.0981	6356239.7248	TOC BC	
212	1928230.6256	6356239.1989	TOC EC	

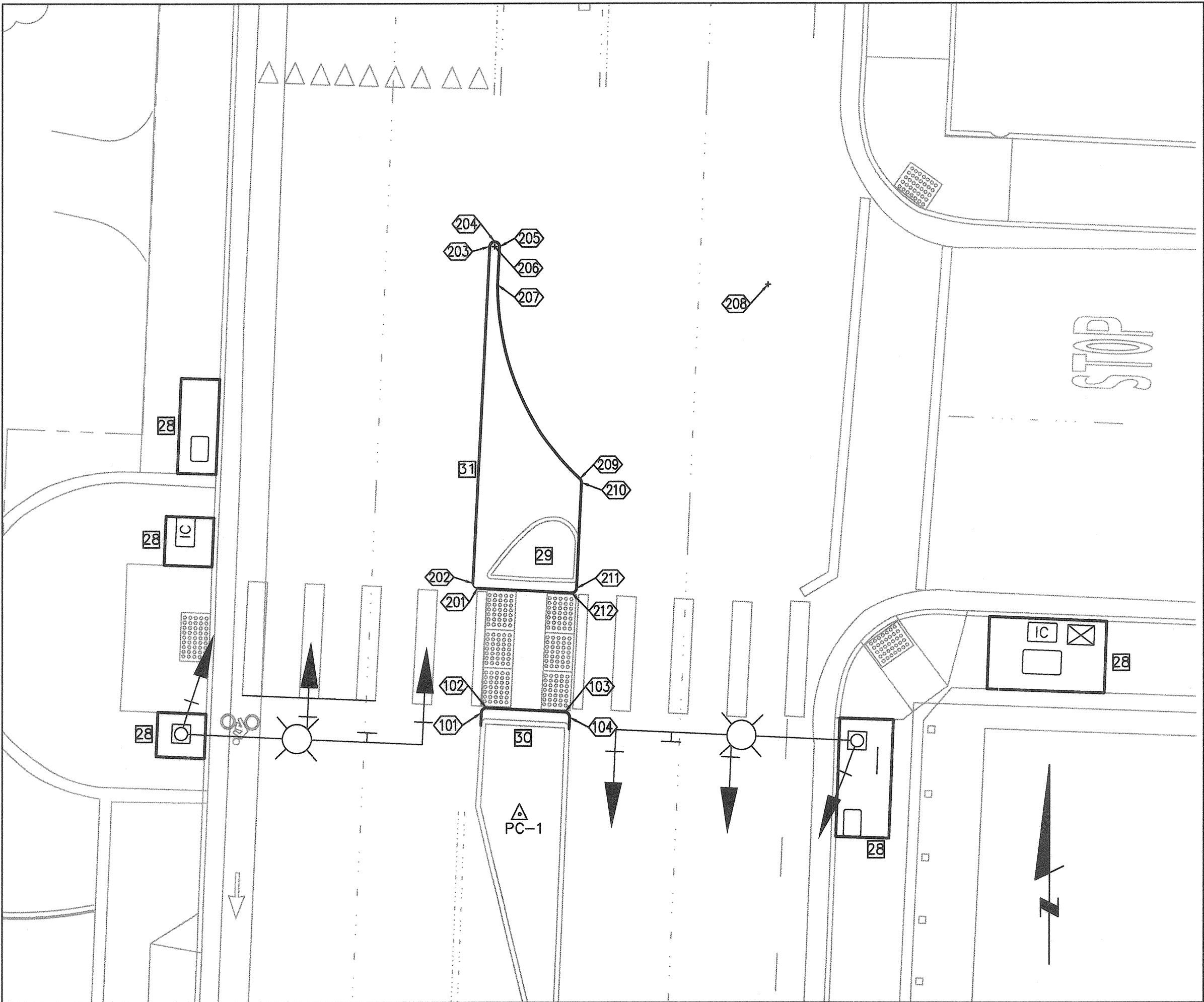

SITE PLAN
1" = 10'

REGISTERED PROFESSIONAL ENGINEER
STEPHEN L. DITTMER
No. 43888
EXP. 6-30-19
CIVIL
STATE OF CALIFORNIA

City of Santa Rosa

DATE: 6-11-2018

APPROVED: Deputy Director - Engineering
By: Lori Urbanek

DATE: 6/18/18

MENDOCINO AVE AND MCCONNELL AVE
INTERSECTION PEDESTRIAN IMPROVEMENTS

SIGNING AND STRIPING PLAN,
Site Plan

CONTRACT NO.
C02059

SHEET 4 OF 4

FILE # 2018-0030

SCALE: AS SHOWN

DATE: 6-11-2018

APPROVED: Deputy Director - Engineering
By: Lori Urbanek

DATE: 6/18/18

MENDOCINO AVE AND MCCONNELL AVE
INTERSECTION PEDESTRIAN IMPROVEMENTS

SIGNING AND STRIPING PLAN,
Site Plan

CONTRACT NO.
C02059

SHEET 4 OF 4

FILE # 2018-0030