



March 15, 2017

**ANNUAL SLURRY SEAL 2017**

CIP Project Number: C02099

Residents/Property Owner:

The City of Santa Rosa will be applying a coat of slurry seal to selected streets (please see the attached map) this summer between late July and early August. Slurry seal is preventive maintenance which involves applying an emulsified asphalt mixture over the existing street surface. It helps protect streets from water penetration, provides a new surface with improved skid-resistance, and extends the life of the roadway. Slurry seal is part of the City's ongoing pavement maintenance program to help seal cracks and preserve the pavement of our streets.

Between now and July City personnel will be working in your neighborhood to seal cracks in the roadway and make necessary pavement repairs to prepare the road surface for the slurry seal application.

The streets to be slurry sealed are selected based on the condition of the pavement identified by the City's Pavement Management Program and are grouped into neighborhoods for efficient application. For more information on slurry seal and the City's Pavement Management Program, please go to [www.srcity.org/slurryseal](http://www.srcity.org/slurryseal).

A second notice will be mailed to you, announcing the name of the contractor who will be conducting the work and the anticipated work schedule. Three days prior to the slurry seal application, City personnel will knock on the door of each affected residence and distribute a flyer with information about parking restrictions and dates. If you are not home, they will leave the flyer on your door. During construction traffic will be subject to delays. Access to businesses, homes and parking will be restricted.

For general questions please call the Transportation and Public Works Department at (707) 543-3881. For more specific questions or if you feel you have any special access needs for your business during construction or for any other questions or concerns, you can contact Ed Skultety at (707) 543-3877 or e-mail at [eskultety@srcity.org](mailto:eskultety@srcity.org).

Sincerely,

CLAY THISTLE  
Associate Civil Engineer

Attachment: Location Map

SEE AREA 2

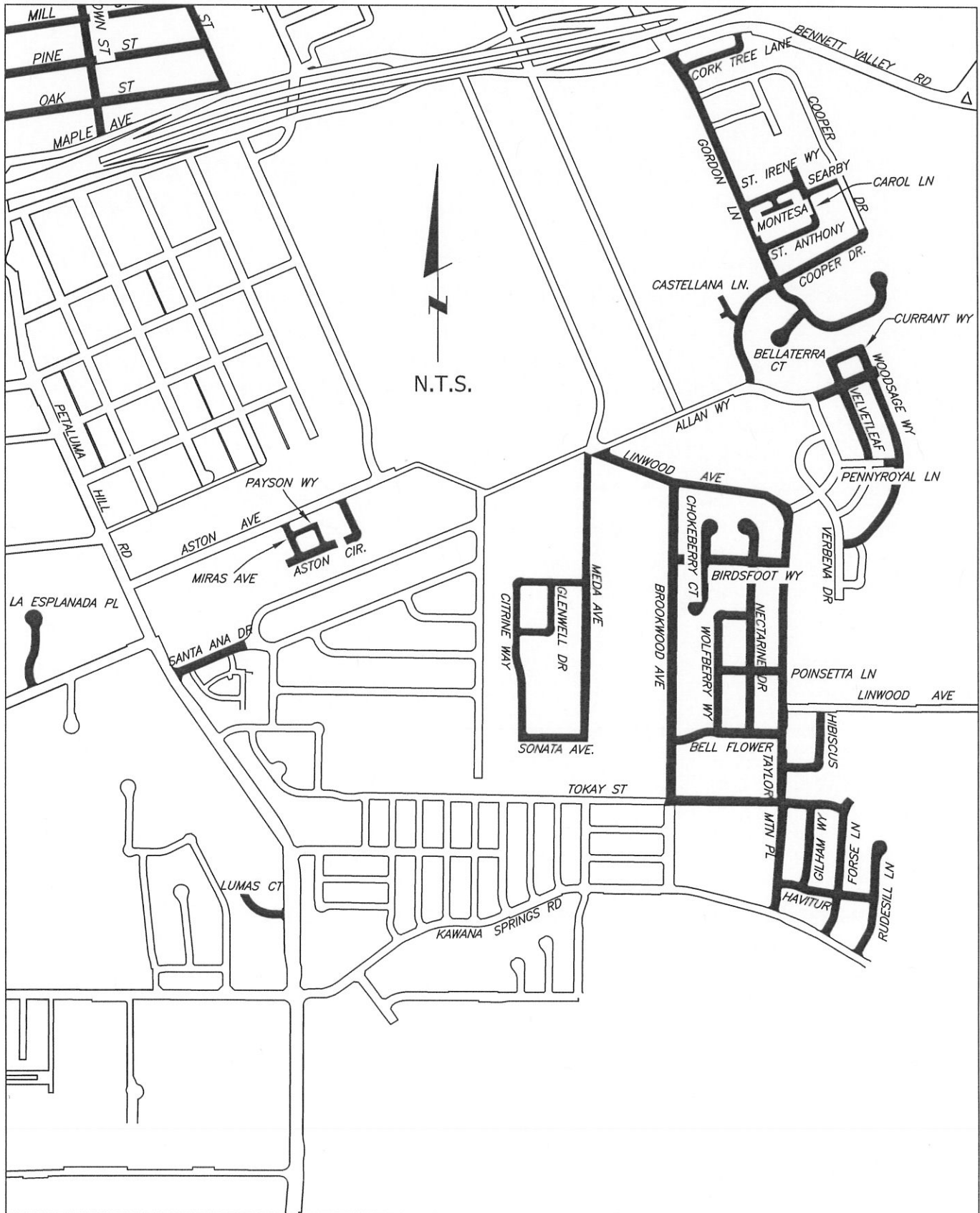

**LEGEND:**

**————** STREETS TO BE SLURRIED

CITY OF SANTA ROSA  
2017 SLURRY SEAL CONTRACT

**AREA 3 of 3**

CONTRACT #CO2099