

CITY OF SANTA ROSA

IMPROVEMENT PLANS FOR

FOUNTAINGROVE PARKWAY AT STAGECOACH ROAD

TRAFFIC SIGNAL INSTALLATION

GENERAL NOTES:

- All workmanship, materials, and construction shall conform to the City of Santa Rosa Standard Plans, The Construction Specifications for Public Improvements, the Special Provisions for this project, and the State Standard Specifications and Standard Plans.
- The contractor shall call Underground Service Alert (USA) at (800) 227-2600 for markouts of existing underground facilities at least two working days prior to any excavation.
- The contractor shall possess a valid "C-10" Electrical Contractor's License on the day of the bid opening.
- The locations of P. G. & E., Pacific Bell and Cable TV underground utilities shown on the plans are based on the best available information. The City only assumes responsibility for the accuracy of the location of its own underground utilities.

CONTRACT No. 2006-002

RECORD PLAN DATA

PROJECT START	5-22-06
PROJECT END	8-7-06
CONTR.	Richard A. Mepps Elec.
SUPER.	Richard Anderson
UN. GR. CONT.	
SUPER.	
SEWER PIPE	
WATER PIPE	
WATER VALVES	
TEES, WYES, FTGS.	
FIRE HYDRANT	
INSPECTOR	David Stolte
RECORD PLANS BY	David Stolte
OTHER	

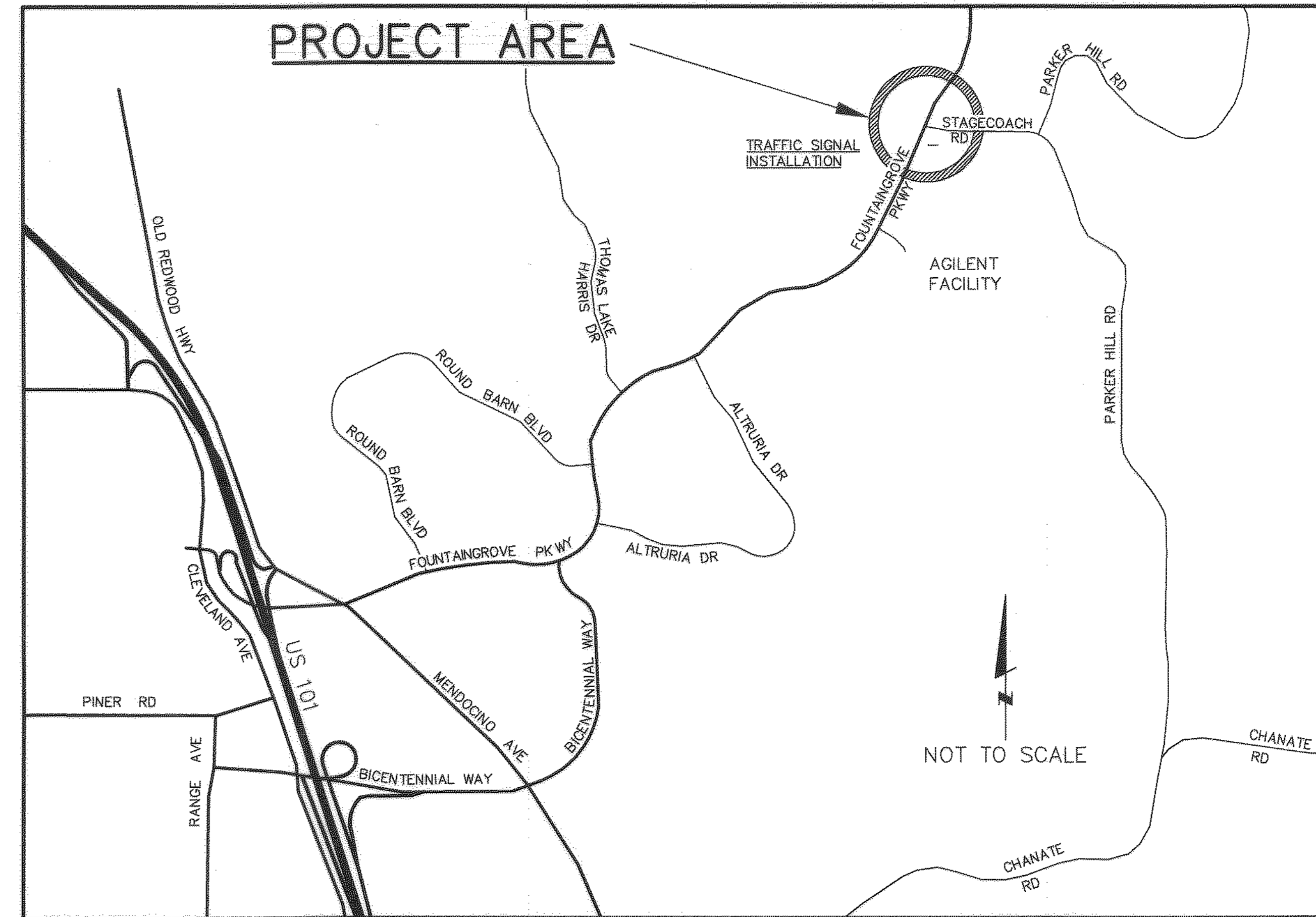

CONSTRUCTION NOTES:

- Locate traffic signal standards with center of poles 24" behind the face of curb at the back of the crosswalk per City Std. 240 or as shown on the plans.
- The Contractor shall install conduit and conductors into the splice box installed by P.G.&E. prior to P.G.&E. service splice per City Std. 733A at the location shown on the plans.
- Install Type "B" traffic signal detector loops as shown per City Std. 732 and State Stds. ES-5A and ES-5B. All loops shall be installed a minimum of two feet from the nearest edge of any manhole, valve, or monument.
- Rockwheeled trenches less than 12" wide shall be backfilled with four sack concrete to not less than 0.17 foot below the pavement surface and the top 0.17 foot shall be asphalt concrete.
- Trenches 12" and wider shall be backfilled per City Std. 215.
- All trench spoils shall be removed as they are generated and disposed of off-site as required in the Special Provisions.
- The Contractor shall hand dig trenches at crossings of existing conduit and other utilities.
- Record plans indicate the existing street section of Fountaingrove Parkway is two-2" lifts of asphalt concrete (westbound), and three-2" lifts (eastbound), both over 14.5" of aggregate base; and the existing street section of Stagecoach Road is 3" of asphalt concrete over 12" of Class II aggregate base.
- Pedestrian heads shall be international symbol, illuminated by LED's per Special Provisions section 86-4.06.
- A double channel optical detector (3M Opticom Model 722) shall be provided and installed by the Contractor two feet from the end of the traffic signal mast arm at the locations shown on the plans. A phase selector (3M Opticom Model 752) shall be provided by the Contractor and installed by the City in the Type 170 controller.
- Contractor shall install a video detection system as shown and per the Specifications.
- All signal faces shall be 12" in diameter and shall have back plates. Red, yellow and green signal sections shall be equipped with LED indicators per the special provisions.
- Existing equipment to be removed and salvaged shall be returned to the City Municipal Services Center at 55 Stony Point Road.
- The locations shown for installation of conduit and pullboxes are schematic only and will vary as field conditions require.
- The contractor shall verify overhead and underground clearances of existing utilities before construction.
- Any pavement delineation damaged during construction shall be replaced at the contractor's expense to the satisfaction of the engineer.
- Pullboxes shall be grouted per City STD. 730 prior to the pulling of any conductors.
- All existing conduits shown to be used for installation of conductors shall be cleaned per Section 86-2.05c of the State Standard Specification prior to conductors being installed.
- Pedestrian Push Buttons shall be per Special Provisions.
- Landscaping and irrigation damaged during construction shall be repaired or replaced in kind by the Contractor to the satisfaction of the Engineer.

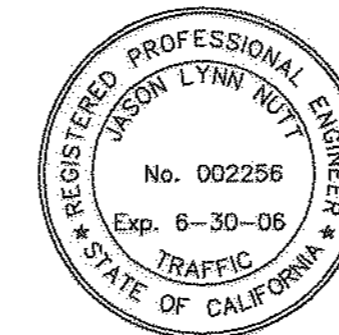

APPROVED: JASON LYNN NUTT,
Deputy Director - Traffic T002256 - Exp. 6-30-06
By: _____ DATE: 1/9/06

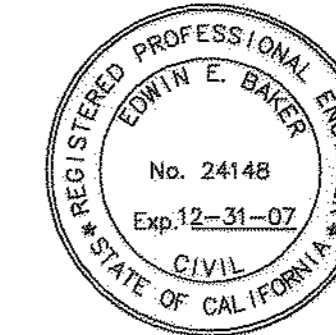

RECORD PLANS

CONTRACT NO. 2006-002

BASIS OF BEARING: CITY MONUMENTS G-466 TO G-467
N24°26'44"E - 1059.64' (MEASURED). SEE SHT 2

Department	Signature	Date	No.	Date	Revision	By
Design/Construction	<i>[Signature]</i>	1/9/06				
Survey	<i>[Signature]</i>	1/6/06				
Field Services	<i>[Signature]</i>	1/6/06				
Utilities	<i>[Signature]</i>	1/9/06				
Traffic	<i>[Signature]</i>	1/9/06				
Parks	N/A					

CITY OF SANTA ROSA		Date: JANUARY 2006	Scale: N/A
FOUNTAINGROVE PARKWAY AT STAGECOACH ROAD		APPROVED: Deputy Director of Public Works - Engineering	
TRAFFIC SIGNAL INSTALLATION		By: <i>[Signature]</i> Date: 1/10/06	
COVER SHEET		DWN <i>gth</i>	CHK <i>pag</i>
		Sheet 1 of 4	File Number: 2005-0137

FOUNTAINGROVE PARKWAY ALIGNMENT TABLE

NORTHING	EASTING	STATION	LENGTH	BEARING	RADIUS	DELTA
298295.509	1796370.471	63+10.95	CURVE	839.67	4400.00	10°56'02"
299051.620	1796732.695	71+50.62	LINE	221.64		
299259.722	1796808.974	73+72.26	LINE	66.21	N 20°07'49" E	
299321.886	1796831.760	74+38.47	CURVE	316.10	750.00	24°08'53"
299587.378	1796998.977	77+54.57	CURVE	646.47	750.00	49°23'12"
300177.766	1797209.031	84+01.04				

FOUNTAINGROVE COUNTRY CLUB ALIGNMENT TABLE

NORTHING	EASTING	STATION	LENGTH	BEARING	RADIUS	DELTA
299259.722	1796808.974	0+00	LINE	80.00	N 69°53'00" W	
299287.237	1796733.855	0+80.00				

STAGECOACH ROAD ALIGNMENT TABLE

NORTHING	EASTING	STATION	LENGTH	BEARING	RADIUS	DELTA
299259.722	1796808.974	0+00	CURVE	272.29	782.00	19°57'01"
299212.019	1797075.658	2+72.29				

SURVEY CONTROL:

CITY MONUMENT G-466 Northing = 298294.381 Easting = 1796372.342
 MONUMENT Northing = 299050.932 Easting = 1796734.573
 CITY MONUMENT G-467 Northing = 299259.034 Easting = 1796810.852

NOTES:

- The coordinate data for this drawing which is referenced to the Basis of Bearing shown, are different (± 0.8') from coordinate data referred to by the City of Santa Rosa NAD 27 coordinate monuments.
- Monuments lie to the right of centerline alignment.

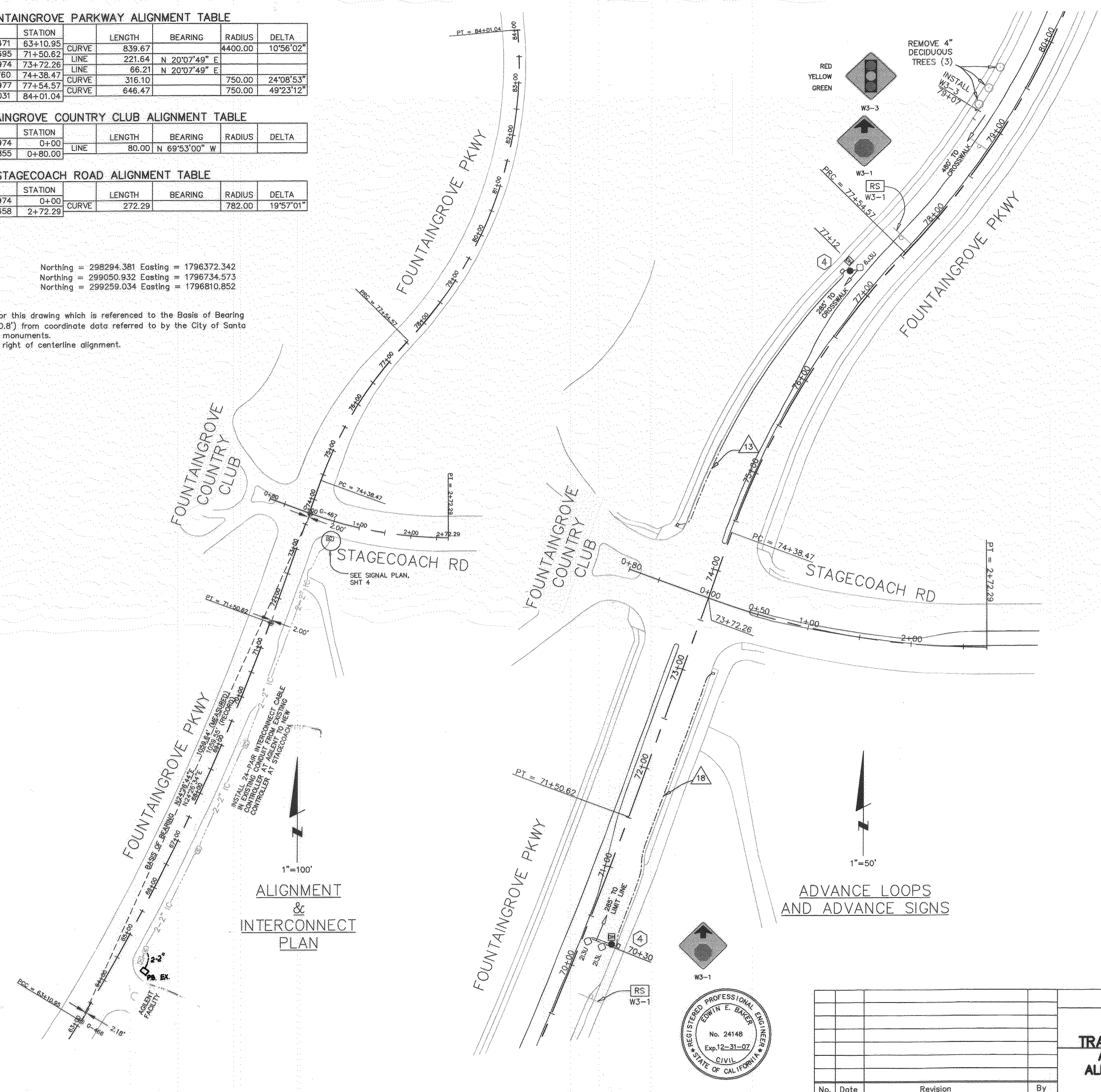

LEGEND

-
-
-
-
-
-

ABBREVIATIONS:

- AC ASPHALT CONCRETE
- DLC DETECTOR LEAD-IN CABLE
- E ELECTRIC
- EX EXISTING
- G GAS
- JT JOINT TRENCH - GAS, ELEC, TEL, TV
- LMA LUMINAIRE MASTARM
- MH MANHOLE
- O.C. ON CENTER
- PPB PEDESTRIAN PUSH BUTTON
- PC POINT OF CURVE
- PRC POINT OF REVERSE CURVE
- PT POINT OF TANGENT
- RPM RAISED PAVEMENT MARKER
- SL STREET LIGHT
- SL2 STREET LIGHT 2" CONDUIT (EX)
- SNS STREET NAME SIGN
- SS SANITARY SEWER
- TS TRAFFIC SIGNAL
- TS3 TRAFFIC SIGNAL 3" CONDUIT (EX)
- TEL TELEPHONE
- TV TELEVISION
- W WATER

ALIGNMENT & INTERCONNECT PLAN

ADVANCE LOOPS AND ADVANCE SIGNS

RECORD PLANS

CONTRACT NO. 2006-002

CITY OF SANTA ROSA
FOUNTAINGROVE PARKWAY AT STAGECOACH ROAD
TRAFFIC SIGNAL INSTALLATION
ADVANCE LOOPS AND SIGN, ALIGNMENT AND INTERCONNECT, LEGEND

Date:	JANUARY 2006	Scale:	AS NOTED
APPROVED:	Deputy Director of Public Works - Engineering	By:	<i>Edwin E. Baker</i>
Date:	1/10/06	Sheet:	2 of 4
DWN:	gth	CHK:	pag
File Number:	2005-0137		

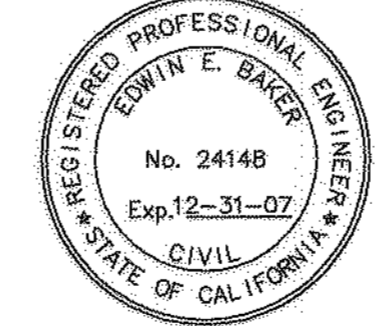

No.	Date	Revision	By

SIGN AND STRIPING NOTES AND LEGEND:

- 1 INSTALL LINES OF NON-REFLECTIVE RPM, 4' O.C., 30 DEGREES OFF ALIGNMENT.
- 2 REMOVE EXISTING STOP SIGNS (7). RETURN TO CITY SIGN SHOP, 55 STONY POINT RD.
- R4-7 INSTALL K-1 MARKER AND R4-7 ON EXISTING STOP SIGN POLE. CUT POLE TO CORRECT HEIGHT.
- /// REMOVE.
- ← EXISTING THERMOPLASTIC ARROW.
- INSTALL THERMOPLASTIC ARROW.

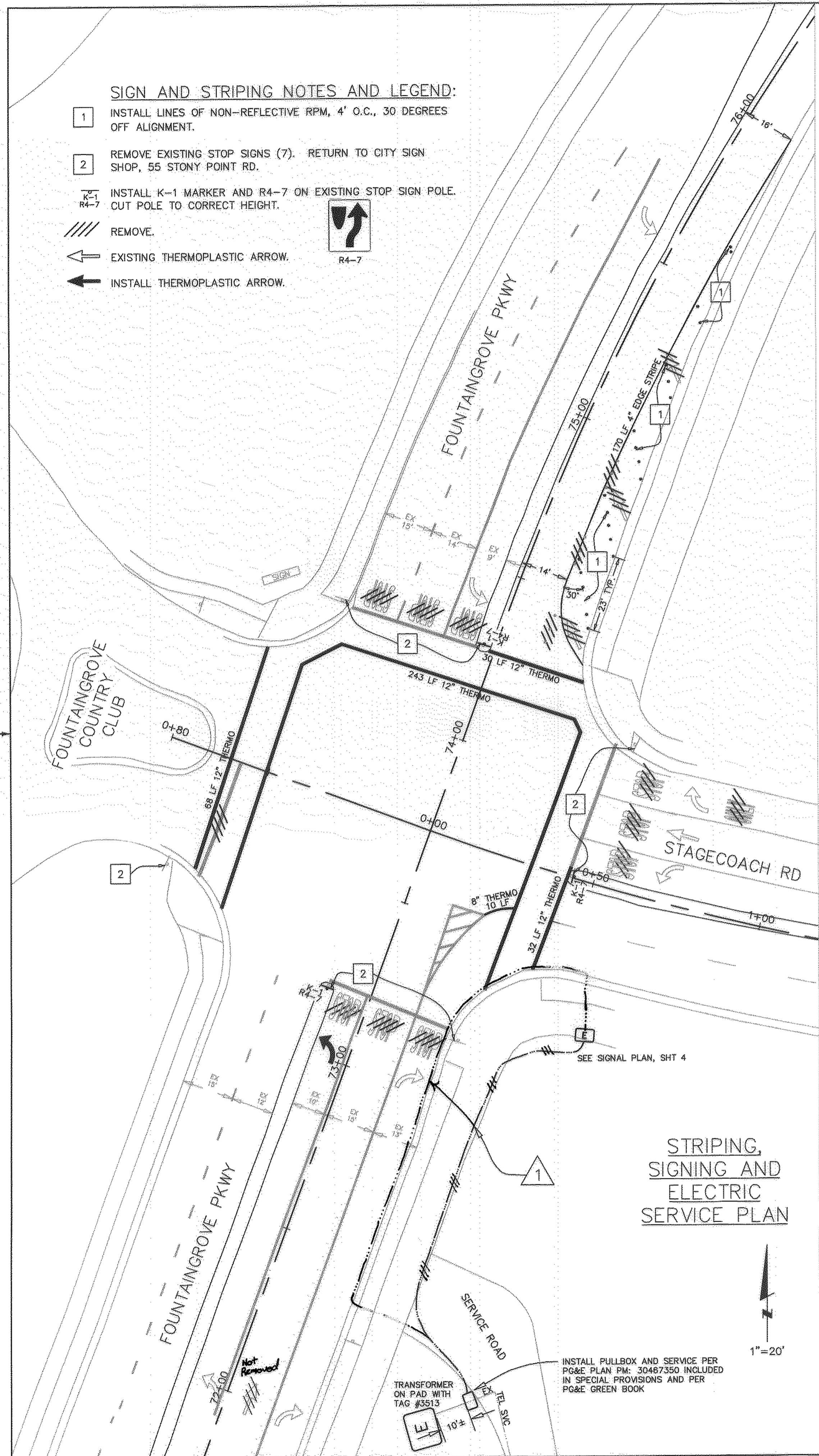

STRIPING, SIGNING AND ELECTRIC SERVICE PLAN

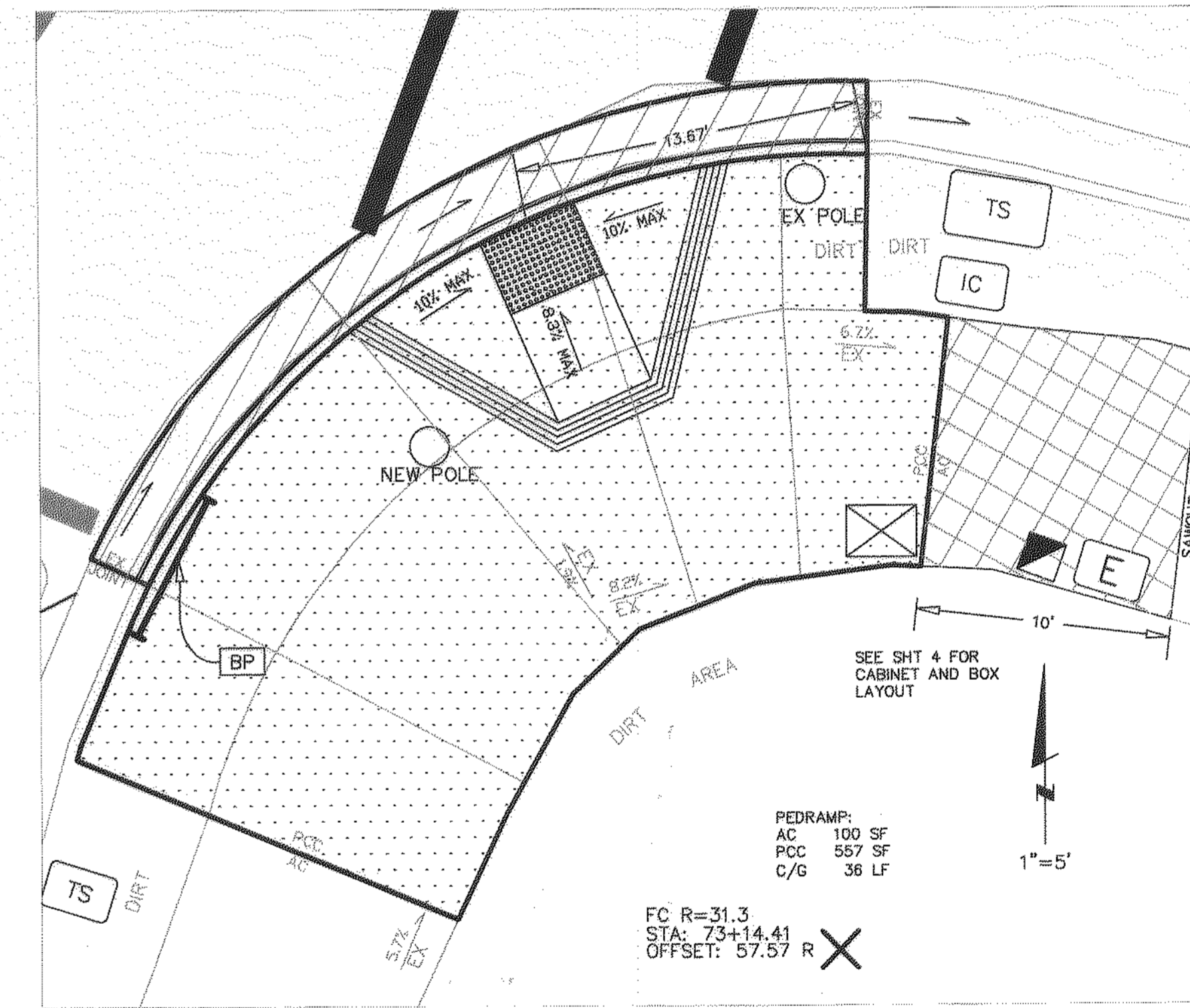
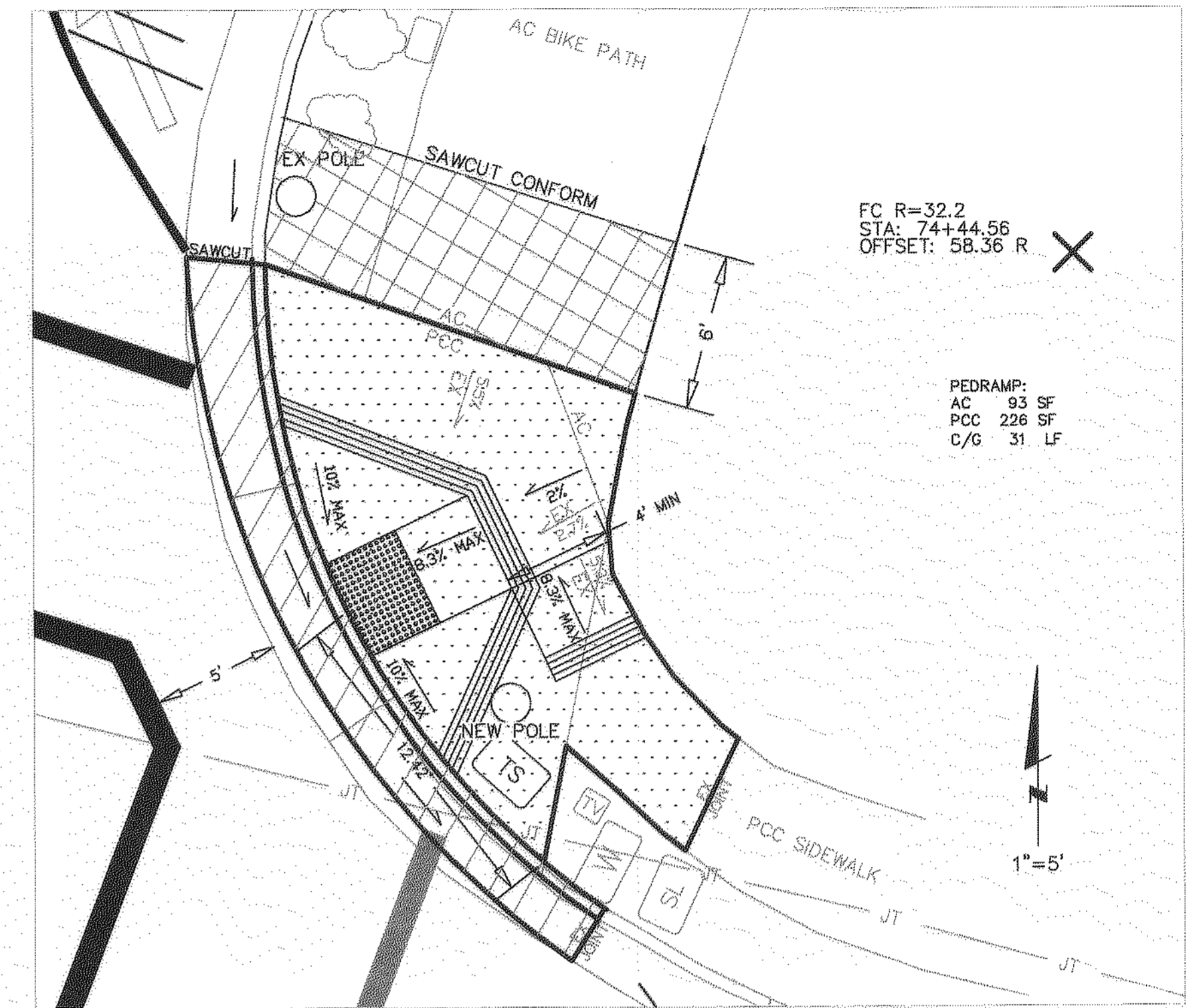
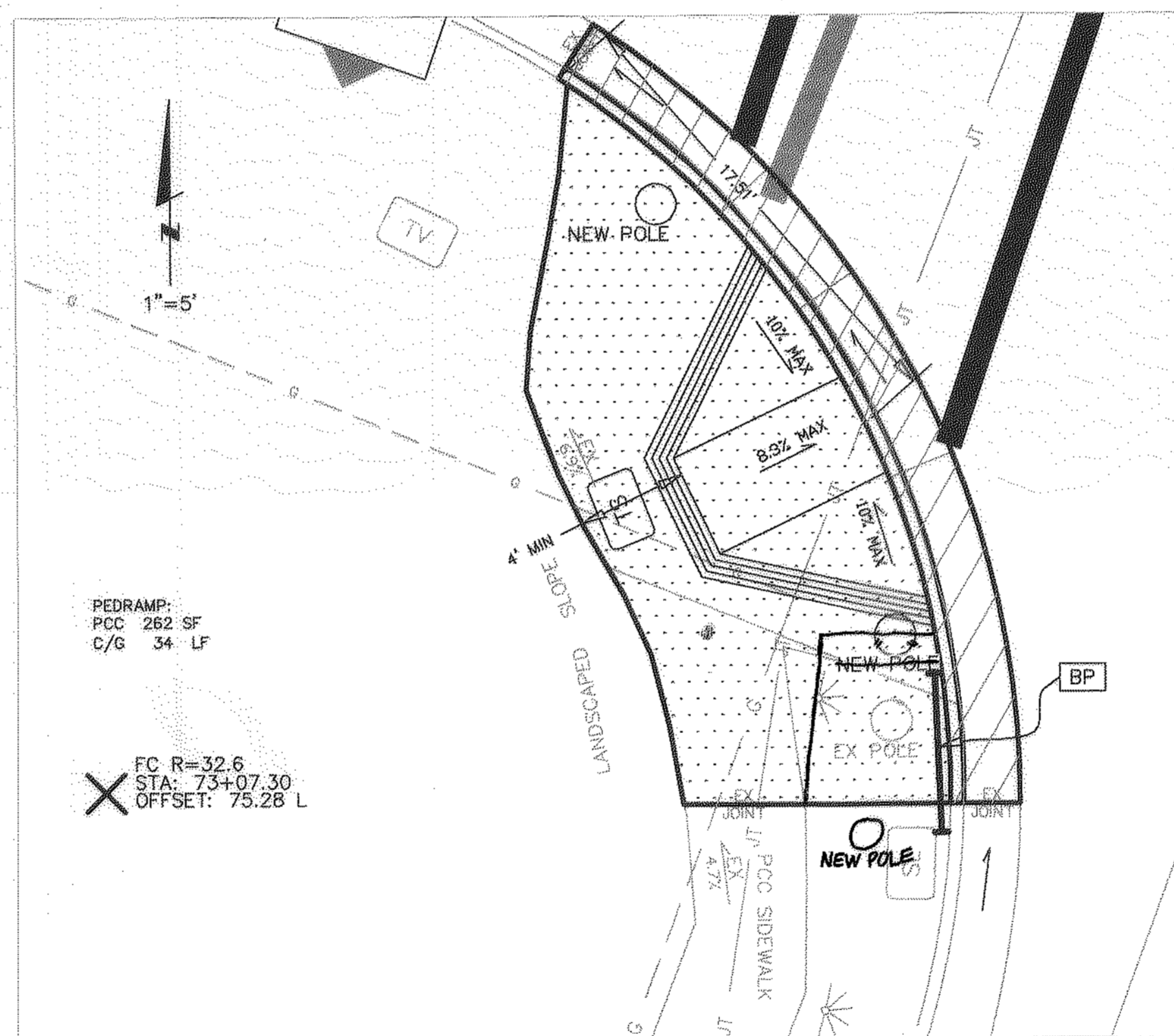
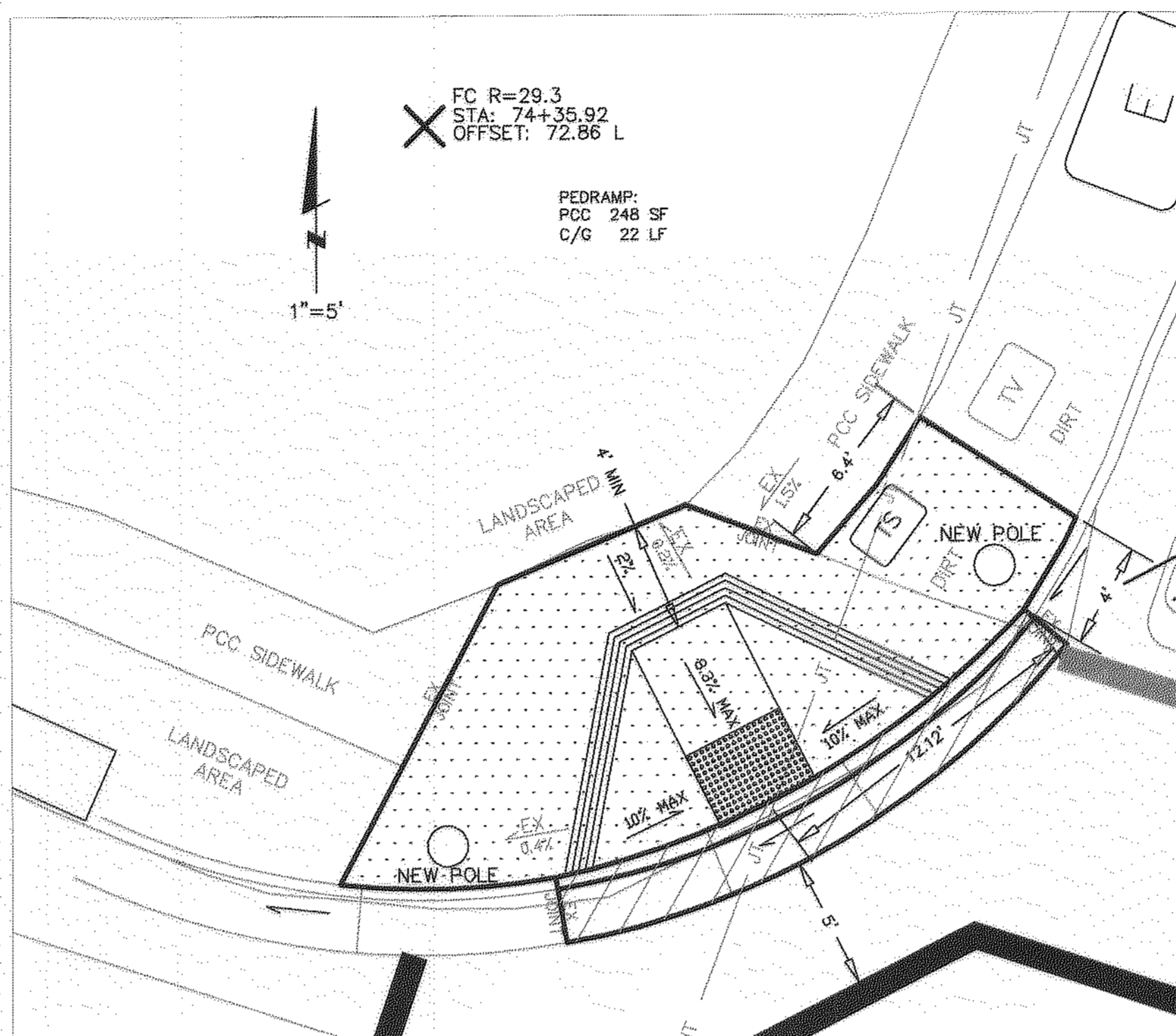

PEDESTRIAN RAMPS PLANS 1"=5'

- REMOVE PCC CURB AND GUTTER. INSTALL NEW PCC CURB AND GUTTER PER CITY STANDARD 241.
- REMOVE PCC SIDEWALK. REPLACE WITH PCC SIDEWALK. INSTALL PED RAMP SIMILAR TO CITY STANDARD 232A.
- INSTALL ASPHALT CONCRETE CONFORM. REMOVE 0.33 FEET MIN OF EXISTING SECTION. REPLACE WITH 0.33 FEET OF ASPHALT TO CONFORMS, AS DIRECTED BY THE ENGINEER.

3'x4' DETECTABLE WARNING SURFACE PER SPECIAL PROVISIONS

INSTALL PEDESTRIAN BARRICADE, TYPE 1 WITH R9-3a SIGN.

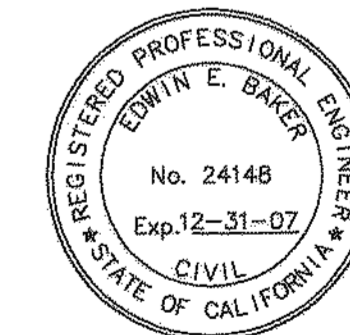

RECORD PLANS

CONTRACT NO. 2006-002

CITY OF SANTA ROSA
FOUNTAINGROVE PARKWAY AT
STAGECOACH ROAD
TRAFFIC SIGNAL INSTALLATION
STRIPING, SERVICE, SIGNING PLAN
PED RAMP PLANS

Date: JANUARY 2006	Scale: AS NOTED
APPROVED: Deputy Director of Public Works - Engineering	
By: <i>Edwin E. Baker</i>	Date: 1/10/06
DWN <i>gth</i> · CHK <i>paq</i>	Sheet 3 of 4 Sheets
	File Number: 2005-0137

No.	Date	Revision	By

CONDUCTOR SCHEDULE		CONDUIT RUNS																					
AWG	CIRCUIT	1	2	3	4	5	6	7	8	9	10	11	12	13	14	15	16	17	18				
	VEH #1 (FUTURE)					6			3								3	3	3				
	VEH #2					6			6	3		3	3										
	VEH #3																						
	VEH #4					6	3		3		3												
	VEH #5 (FUTURE)					6			6	3		3	3										
	VEH #6					9			3	3		3	3			3	3	3					
	VEH #7																						
	VEH #8					9	3		3		3	3			3	3	3						
	PED #2					4			2	2	2												
	PED #4																						
	PED #6					4			2		2	2			2	2	2						
	PED #8					4			4		2	2	2										
	PPB #2					2	1		1	1	1												
	PPB #4																						
	PPB #6					2			1		1	1	1	1	1	1	1	1					
	PPB #8					2			2	1	1	1	1	1	1	1	1	1					
	PPB COMMON					1	1		1	1	1	1	1	1	1	1	1	1					
	SIGNAL NEUTRAL								1	1	1	1	1	1	1	1	1	1					
	P.E.C.					3			3														
	SPARES					9			6		3				3	3							
	TOTAL No.14					3	70	12	9	40	11	8	22	14	8	16	16	5	10				
No.8	STREET LIGHT					2			2	2	2	2	2	2	2	2	2	2					
	SIGNAL NEUTRAL					1	1	1	1	1	1	1	1	1	1	1	1	1					
	EQUIP. GROUND					1	1	1	1	1	1	1	1	1	1	1	1	1	1				
	TOTAL No.8					3	2	4	1	4	3	1	4	1	3	4	4	1	3				
No.6	EQUIP. GROUND					1																	
No.4	SERVICE					3	2																
	OPTICON CABLE					3	1		2	2													
	VIDEO CAMERA CABLE					4	1		2	1	1	1	1	1	1	1	1	1					
	DETECTOR LEAD-IN CABLE					3			1		1	1	2						2				
	CONDUIT SIZE					2"	2"	2"	2"	2"	2"	2"	2"	2"	2"	2"	2"	2"	2"				
	CIRCUIT					1	2	3	4	5	6	7	8	9	10	11	12	13	14	15	16	17	18

- LEGEND**
- IC 2 - 2" INTERCONNECT CONDUITS AND PULL BOX
 - TS TRAFFIC SIGNAL CONDUIT AND PULL BOX
 - OR OPTICOM RECEIVER MODEL 722
 - ISC INTERNATIONAL SYMBOL COUNTDOWN PED HEAD WITH AUDIBLE SIGNAL PER SPECIAL PROVISIONS
 - VDC VIDEO DETECTION CAMERA, MOUNTED 1' FROM END OF LUMINAIRE MASTARM
 - DH DETECTOR HANDHOLE PER STATE STD. ES-SE, TYPE A
 - CC CONTROLLER CABINET
 - SC SERVICE CABINET
 - PEC PHOTOELECTRIC CONTROL
 - AB ABANDON STREET LIGHT CIRCUIT. REMOVE CONDUCTORS BACK TO NEXT PULLBOX.
 - BC INSTALL PULLBOX ON EXISTING CONDUIT
 - BP INSTALL PEDESTRIAN BARRICADE, TYPE 1
 - CC CONNECT NEW AND EXISTING CONDUITS
 - FA REMOVE FOUNDATION TO 6" BELOW GRADE
 - RC REMOVE. TO BECOME PROPERTY OF CONTRACTOR.
 - RP REMOVE AND REPLACE PULLBOX

SIGN NOTE:
THE CITY WILL PROVIDE AND INSTALL ALL SIGNS ON THE SIGNAL POLES AND MASTARMS.

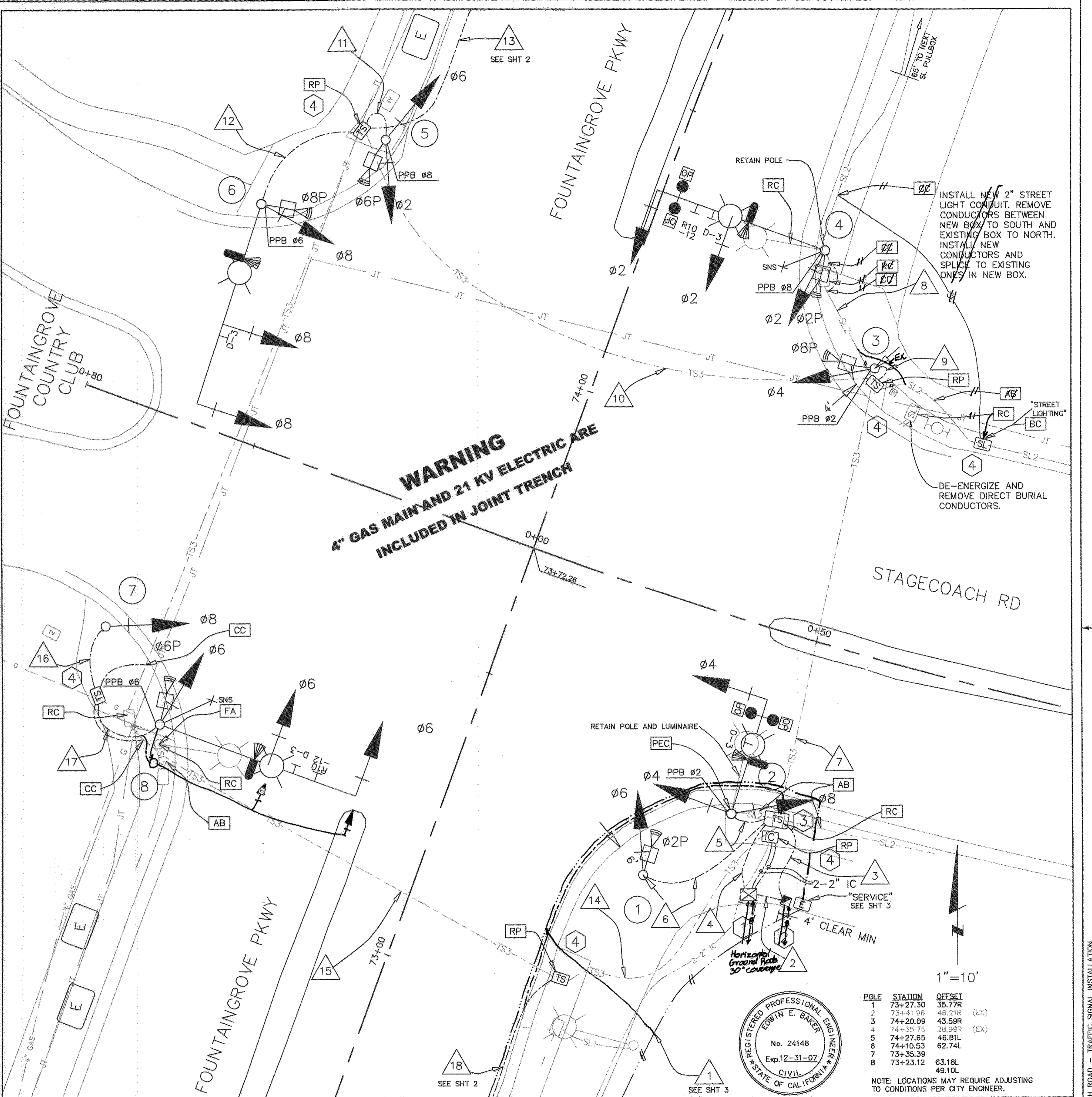

POLE SCHEDULE									
LOC	STANDARD TYPE	HT.	MAST ARM SIG LUM	LUMINAIRE	SIGNAL MOUNTING VEHICLE	PED	PPB	COMMENTS	
1	1A	10	-	-	-	-	TV-1-T	SP-1-T	-
2	19A-3-70 (EX)	35	20	10 (EX)	250W HPS MAS	-	SV-2-TA	-	#2 CONTRACTOR SHALL VERIFY DIMENSIONS OF EXISTING MASTARM MOUNTING BRACKETS BEFORE ORDERING MASTARMS.
3	1A	10	-	-	-	-	TV-1-T	SP-1-T	#2
4	19A-3-70 (EX)	35	30	15 (EX)	250W HPS MAS	MAS	SV-1-T	SP-1-T	#8 REMOVE EX LUMINAIRE. CONTRACTOR SHALL VERIFY DIMENSIONS OF EXISTING MASTARM MOUNTING BRACKETS BEFORE ORDERING MASTARMS. F=13.4'
5	1A	10	-	-	-	-	TV-2-T	SP-1-T	#8
6	24A-3-129	35	35	20	250W HPS MAS	MAS	SV-1-T	SP-1-T	#6 F=14.0'
7	1A	10	-	-	-	-	TV-1-T	-	-
8	24A-4-129	35	35	20	250W HPS MAS	MAS	SV-1-T	SP-1-T	- F=15.6'

EQUIPMENT SCHEDULE				
LOC	EQUIPMENT	TYPE	DESCRIPTION	COMMENTS
1	CONTROLLER	MODEL 170	PROVIDED BY THE CITY WITH TYPE 332 CABINET	
2	SERVICE CABINET	TYPE III-BF	CITY TRAFFIC STD. V-E & STD.-731	
3	PULL BOX (1 REQ'D)	30"X48"	CITY TRAFFIC STD. V-E & STD.-730	
4	PULL BOXES (9 REQ'D)	No. 5	CITY TRAFFIC STD. V-E & STD.-730	ONE LID TO READ "SERVICE". ONE LID TO READ "INTERCONNECT". ONE LID TO READ "STREET LIGHTING".
5	PULL BOXES (1 REQ'D)	No. 2	TO MEET PG&E SPECIFICATIONS	TRAFFIC-RATED LID TO READ "ELECTRIC"

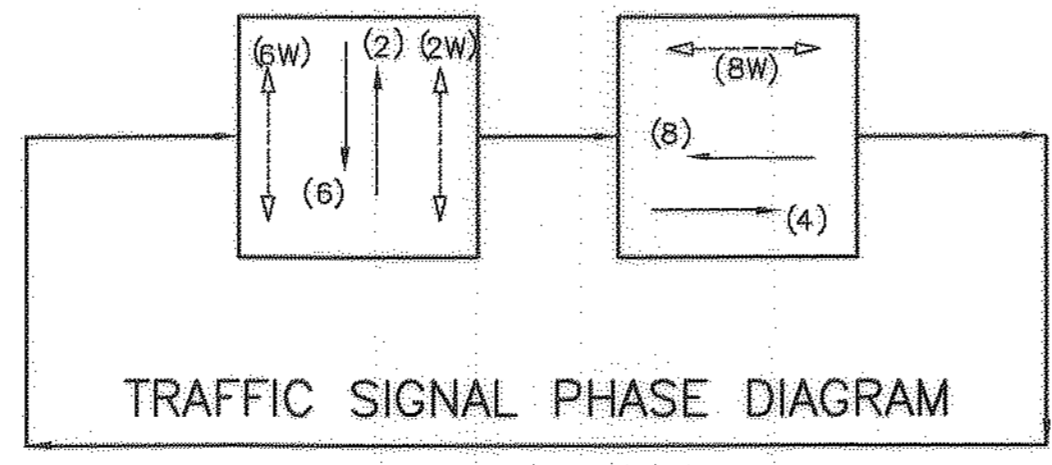

No.	Date	Revision	By

CITY OF SANTA ROSA
FOUNTAINGROVE PARKWAY AT STAGECOACH ROAD
TRAFFIC SIGNAL INSTALLATION

SIGNAL PLAN SCHEDULE

POLE	STATION	OFFSET
1	73+27.30	35.77R
2	73+41.98	46.91R (EX)
3	74+20.09	43.59R
4	74+35.75	28.99R (EX)
5	74+27.85	46.81L
6	74+10.53	62.74L
7	73+35.39	63.18L
8	73+23.12	49.10L

NOTE: LOCATIONS MAY REQUIRE ADJUSTING TO CONDITIONS PER CITY ENGINEER.

RECORD PLANS CONTRACT NO. 2006-002

Date: JANUARY 2006 Scale: 1"=10'

APPROVED: Deputy Director of Public Works - Engineering
By: *Edwin E. Baker* Date: 1/10/06

DWN gth CHK pag Sheet 4 of 4 Sheets File Number: 2005-0137

Stagecoach.dwg 04Jan06 th

FOUNTAINGROVE PARKWAY AT STAGECOACH ROAD - TRAFFIC SIGNAL INSTALLATION