



July 9, 2018

PAVEMENT PREVENTIVE MAINTENANCE 2018

Dear Residents:

The City of Santa Rosa will be making road repairs and applying a coat of slurry seal to selected streets this year (see attached Project Limits). We are anticipating work to begin in October. Slurry seal is preventive maintenance which involves applying an emulsified asphalt mixture over the existing street surface. It helps protect streets from water penetration, provides a new surface with improved skid-resistance, and extends the life of the roadway. Slurry seal is part of the City's ongoing pavement maintenance program to help seal cracks and preserve the pavement of our streets. Prior to placement of slurry seal, pavement repairs will be made and cracks in the roadway will be sealed.

During construction, traffic will be subject to delays. Access to businesses, homes and parking will be restricted at times on the day of slurry placement.

We will update you with another letter approximately two weeks prior to the start of construction. At that time, we will inform you of the Contractor's name and the anticipated work schedule. In addition to written communications like this, the City has created a special website where you can track the progress of this project. Simply go to www.srcity.org/CIP, view the map, and click on the blue map pin that corresponds to this project. You can also view the list of all Capital Improvement Program projects and find this project under Project ID No: 02206.

Please feel free to contact me at (707) 543-4508 or email gbailey@srcity.org if you feel you have any special access needs for your home or business during construction or for any other questions or concerns.

Sincerely,

GRANT BAILEY, P.E.
Associate Civil Engineer

Attachment: Project Limits

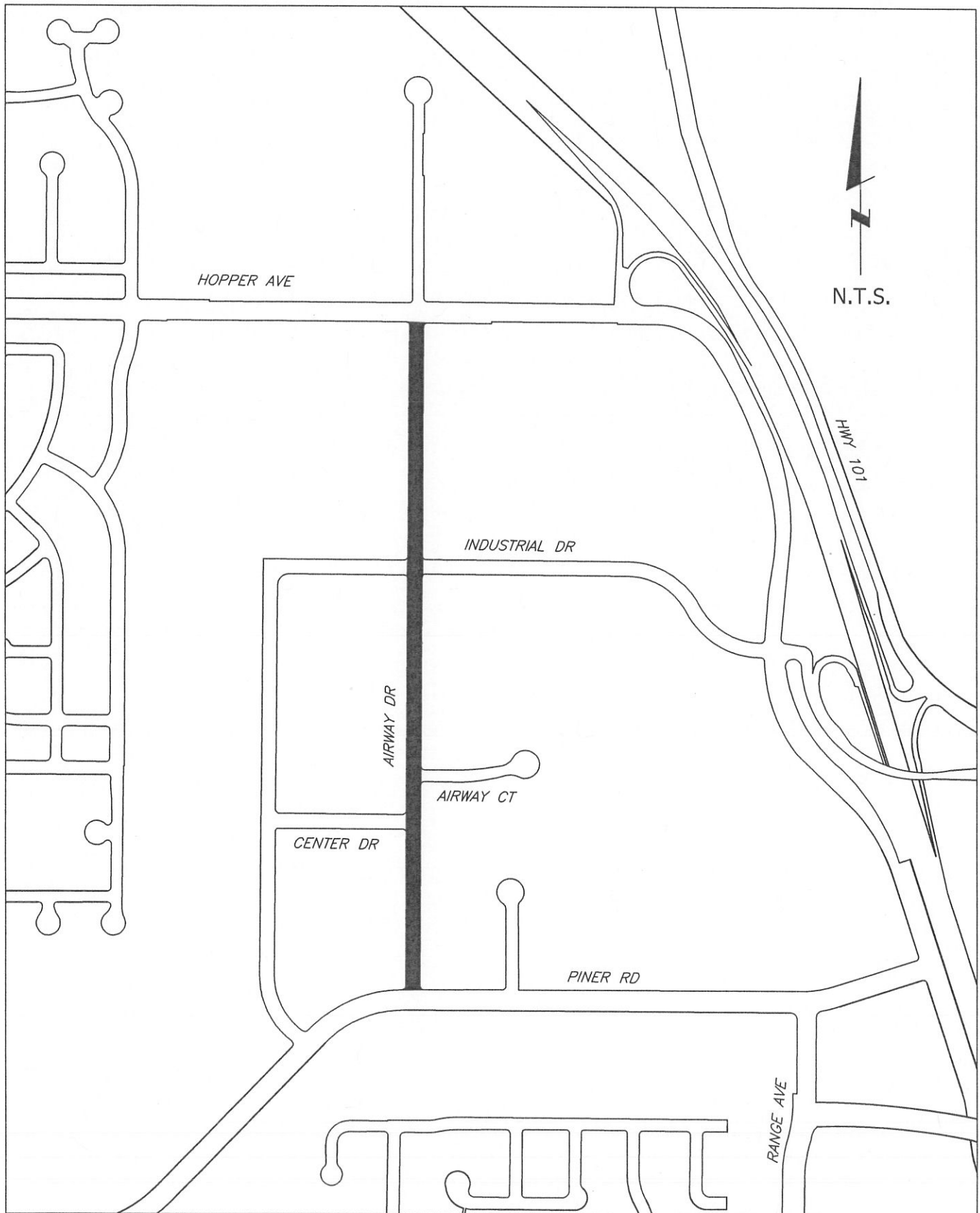

LEGEND:

————— STREETS TO BE SLURRY SEALED

AREA=99,000 S.F.

PAVEMENT REPAIRS=20 TONS

CITY OF SANTA ROSA
 PAVEMENT PREVENTIVE MAINTENANCE 2018
AREA 1 of 2

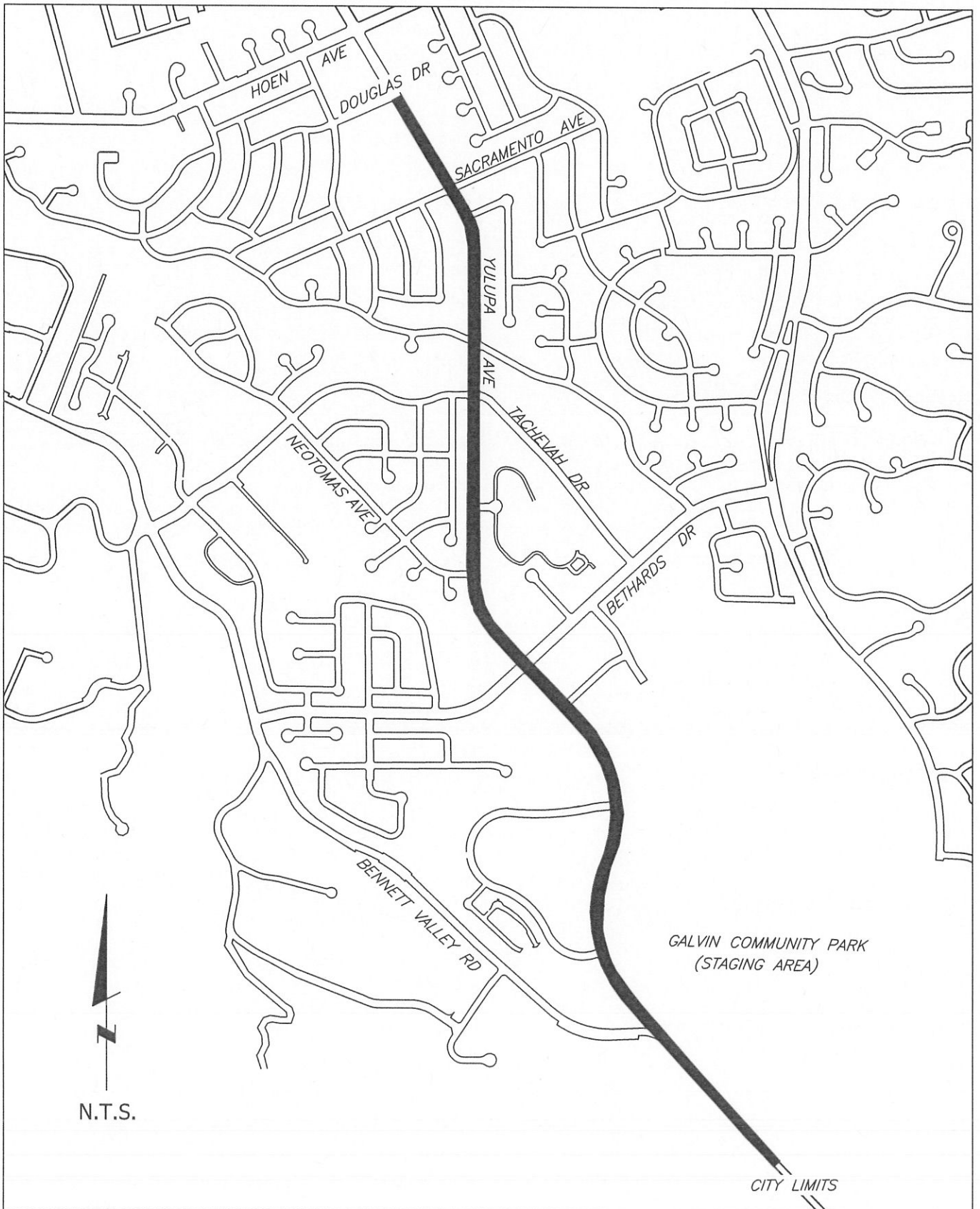

LEGEND:

————— STREETS TO BE SLURRY SEALED
 AREA=502,000 S.F.
 PAVEMENT REPAIRS=200 TONS

CITY OF SANTA ROSA
 PAVEMENT PREVENTIVE MAINTENANCE 2018
AREA 2 of 2