

Boring	AC (in)	AB (in)	Subgrade Material	AC + AB Composite R-Value	Subgrade R-Value
B-1	6	9	Clayey Sand (SC)	74	5
B-2	6	15	Clayey Sand with Gravel (SC)	74	5
B-3	6	13	Sandy Clay (CH)	74	5
B-4	7	15	Sandy Clay (CH)	74	5
B-5	7	11	Clayey Sand (SC)	74	5
B-6	7	13	Sandy Clay (CH)	74	4
B-7	7	16	Sandy Clay (CH)	74	4
B-8	8	15	Sandy Clay (CH)	74	4
B-9	6	18	Clayey Sand with Gravel (SC)	74	4
B-10	6	11	Sandy Clay (CH)	74	4
B-11	6	15	Clay with Sand (CH)	74	4
B-12A	6	18	Assumed cobbles	74	
B-12B	6	18	Cobbles with Clay	74	
B-13	6	18	Sandy Clay (CH)	74	

*Geotech Description of Borings
RGH Consultants, December 17, 2021*

TAB: 4 CALISTOGA ROAD PLAN & PROFILE STA.10+50-STA.19+40

11-11-21 Pathed: \\4827\dwg\4827_02\4827.02 PLAN-PROFILE.dwg

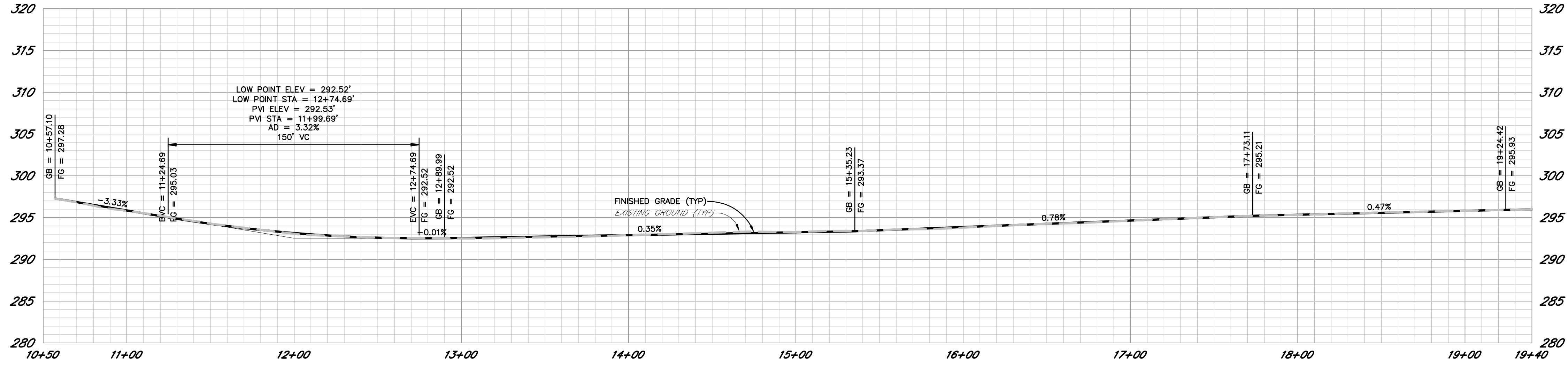

PROFILE
SCALE: HORZ. 1" = 40'
VERT. 1" = 8'

SEE SHEET 5

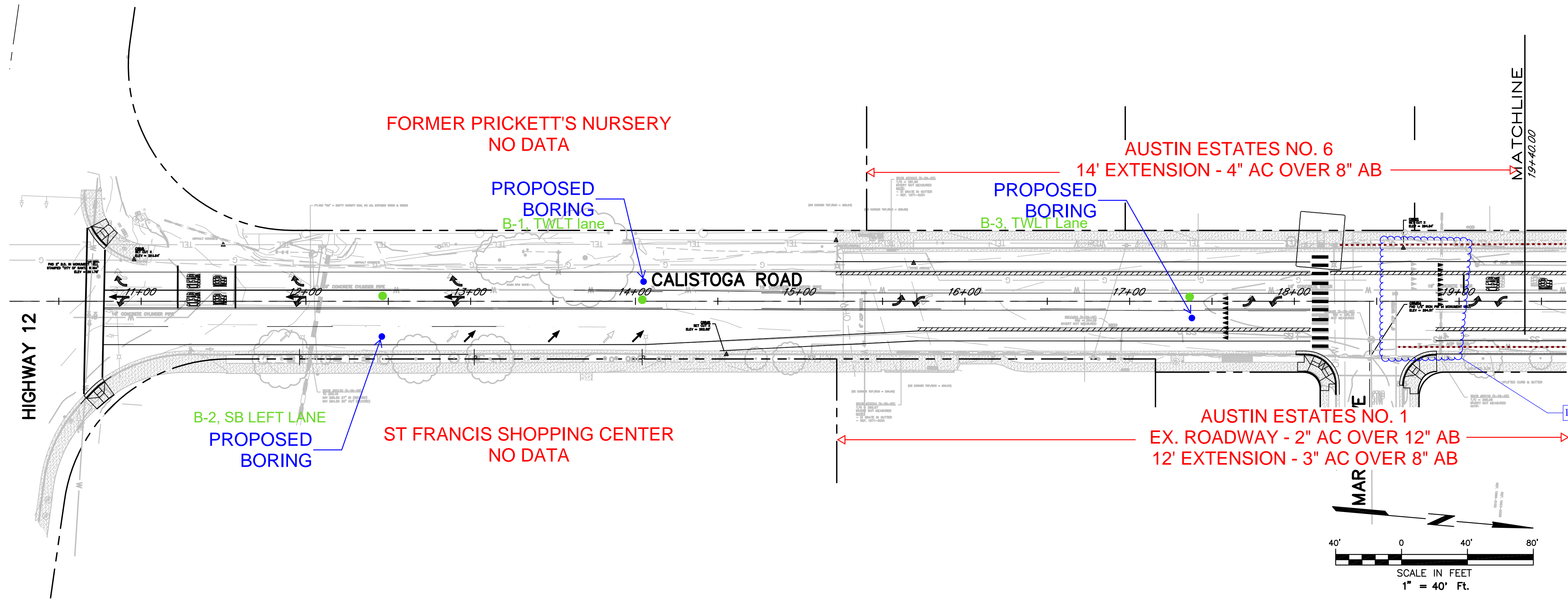

PLAN

SEE SHEET 4

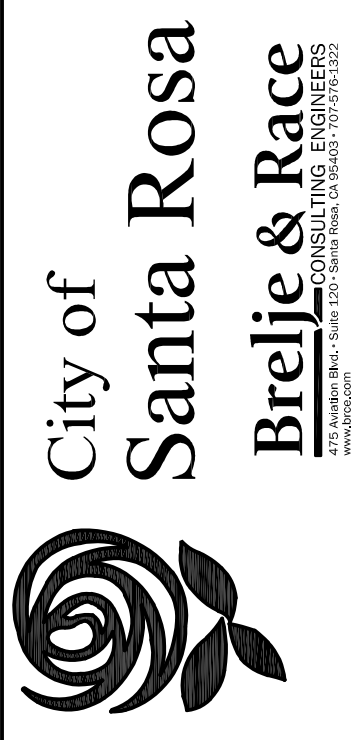
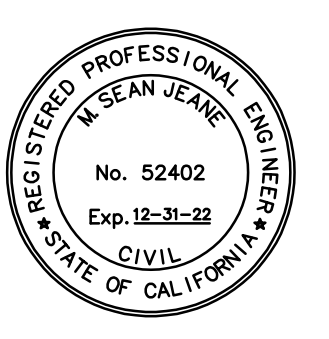

NO.	DATE	REVISION	BY

SCALE: AS SHOWN	DATE: NOVEMBER 2021
DWN BY: XX	CHK BY: JN

CALISTOGA ROAD PAVEMENT REHABILITATION MONTECITO AVENUE TO STATE ROUTE 12	
CALISTOGA ROAD PLAN & PROFILE	
STA.10+50-STA.19+40	
CONTRACT NO.	
SHEET 4 OF 33	
DATE 11-18-21	
FILE NO. 202X-XXXX	

PRELIMINARY
NOT FOR CONSTRUCTION
DATE 11-18-21

11-11-21 Pathed: \\4827\dwg\4827_02\4827.02 PLAN-PROFILE.dwg TAB: 5 CALISTOGA ROAD PLAN & PROFILE STA.19+40-STA.28+35

SEE SHEET 4

SEE SHEET 4

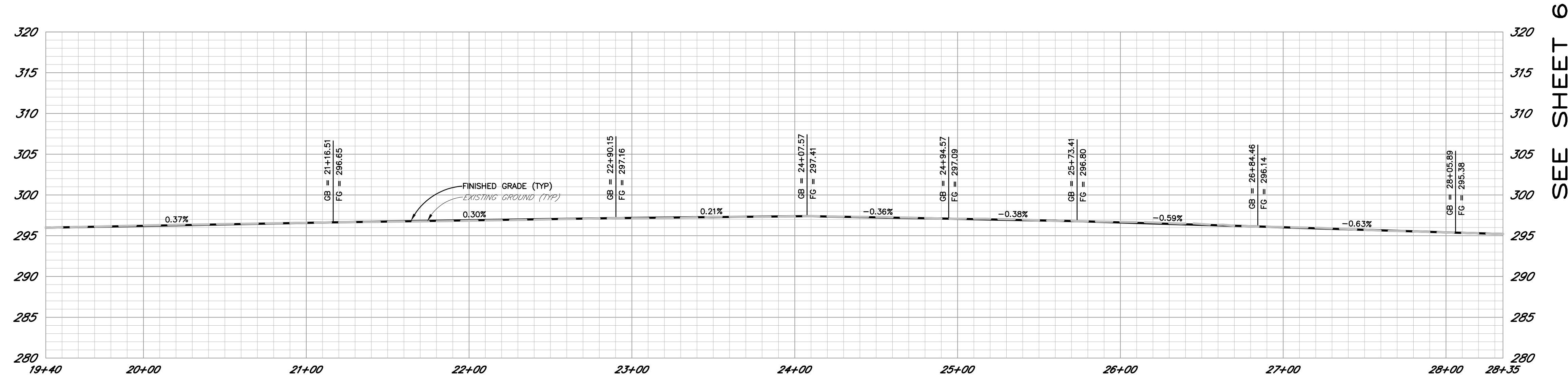

SEE SHEET 6

PROFILE
SCALE: HORZ. 1" = 40'
VERT. 1" = 8'

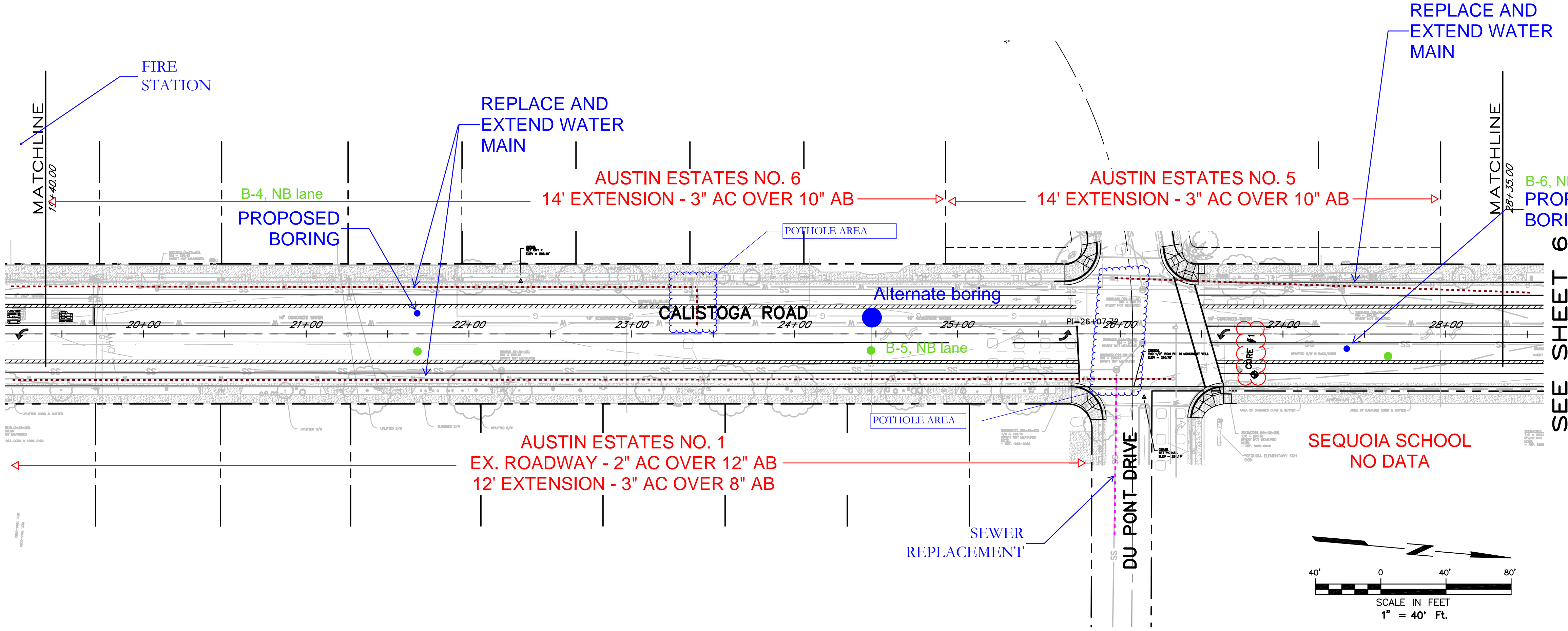

SEE SHEET 6

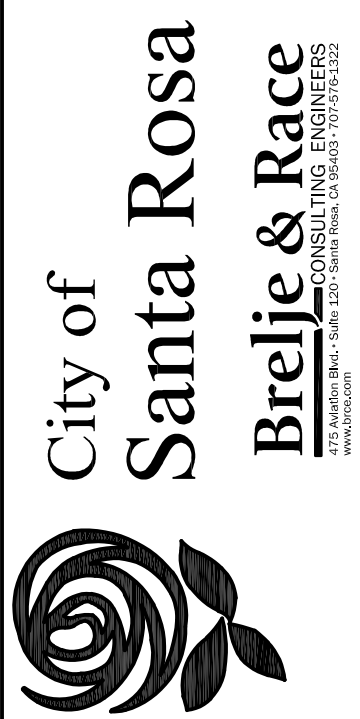
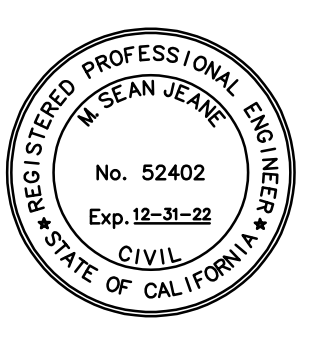

NO.	DATE	REVISION	BY

SCALE: AS SHOWN	DATE: NOVEMBER 2021
DWN BY: JLP	CHK BY: JN

CALISTOGA ROAD PAVEMENT REHABILITATION MONTECITO AVENUE TO STATE ROUTE 12	
CALISTOGA ROAD PLAN & PROFILE	
STA.19+40-STA.28+35	
CONTRACT NO.	
SHEET 5 OF 33	
DATE 11-18-21	
FILE NO. 202X-XXXX	

PRELIMINARY
NOT FOR CONSTRUCTION
DATE 11-18-21

TAB: 6 CALISTOGA ROAD PLAN & PROFILE STA.28+35-STA.37+30

11-11-21 Pathed: \\4827\dwg\4827_02\4827.02 PLAN-PROFILE.dwg

SEE SHEET 5

SEE SHEET 5

SEE SHEET 7

SEE SHEET 7

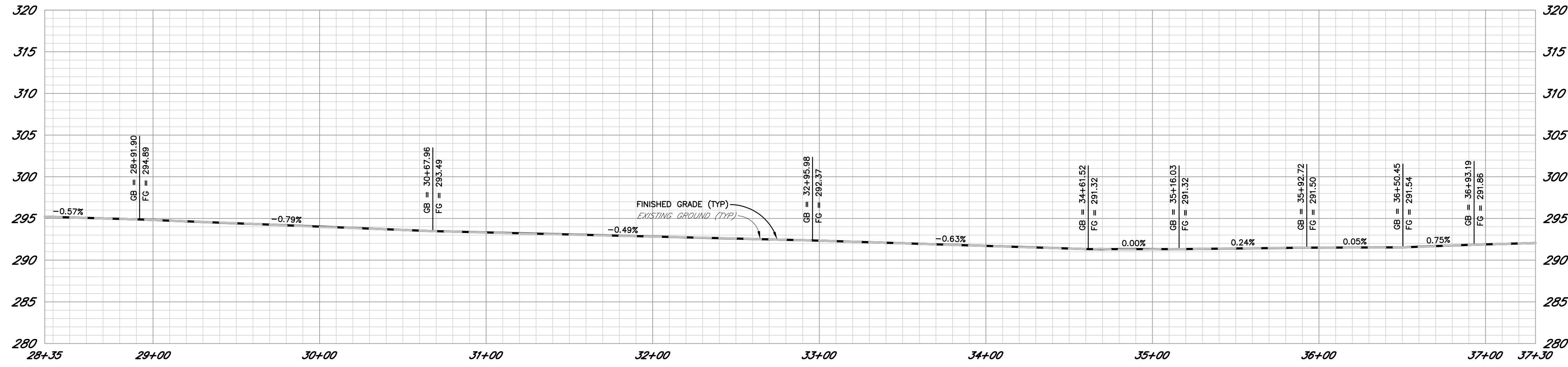

PROFILE
 SCALE: HORZ. 1" = 40'
 VERT. 1" = 8'

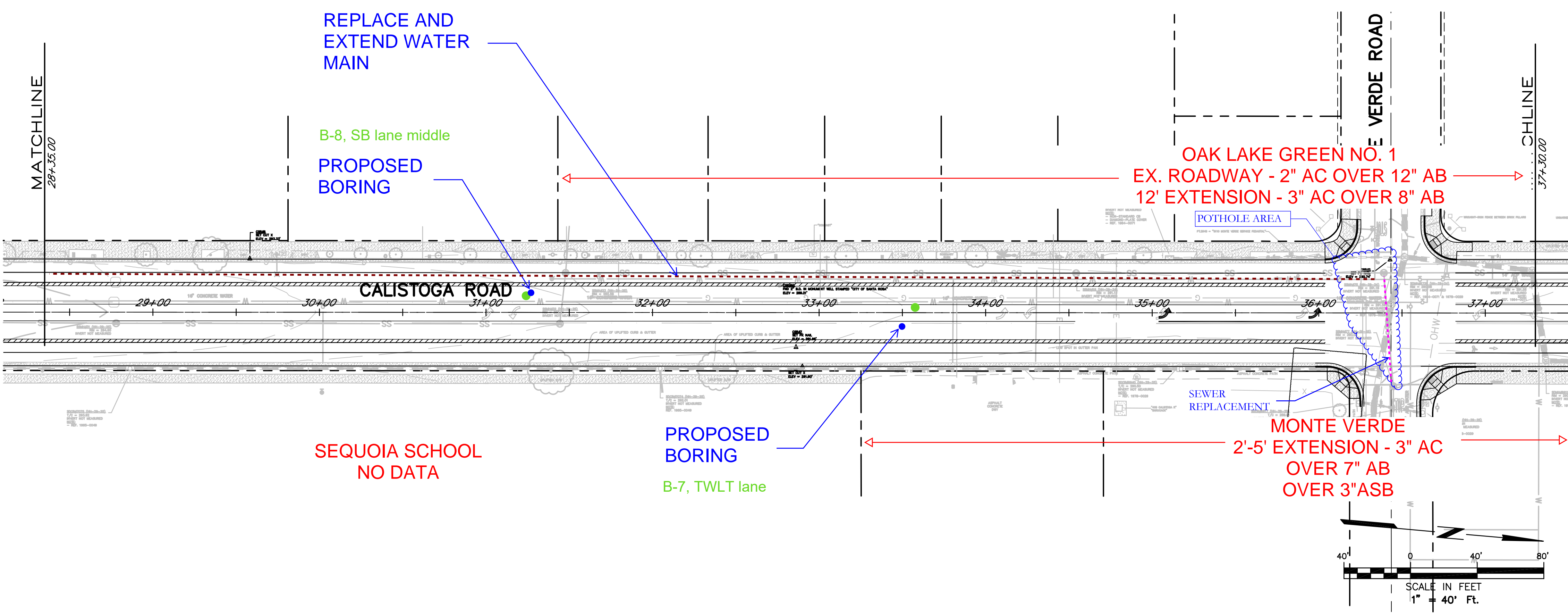

PLAN

PRELIMINARY
 NOT FOR CONSTRUCTION
 DATE 11-18-21

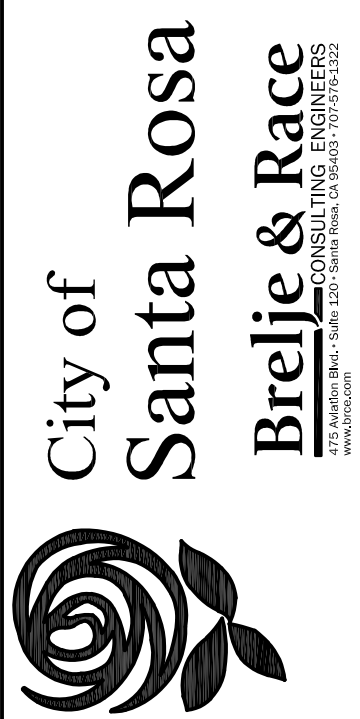
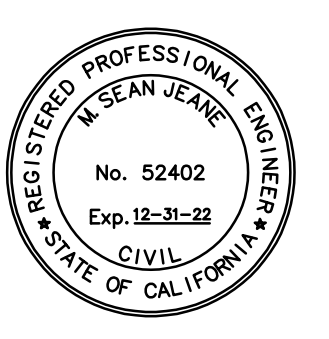

NO.	DATE	REVISION	BY

SCALE: AS SHOWN	DATE: NOVEMBER 2021
DWN BY: JLP	CHK BY: JN

**CALISTOGA ROAD PAVEMENT
 REHABILITATION MONTECITO AVENUE
 TO STATE ROUTE 12
 CALISTOGA ROAD
 PLAN & PROFILE
 STA.28+35-STA.37+30**

CONTRACT NO.
 SHEET 6 OF 33
 FILE NO. 202X-XXXX

TAB: 7 CALISTOGA ROAD PLAN & PROFILE STA.37+30-STA.46+25

11-11-21 Pathed: \\4827\dwg\4827_02\4827.02 PLAN-PROFILE.dwg

SEE SHEET 6

SEE SHEET 6

SEE SHEET 8

SEE SHEET 8

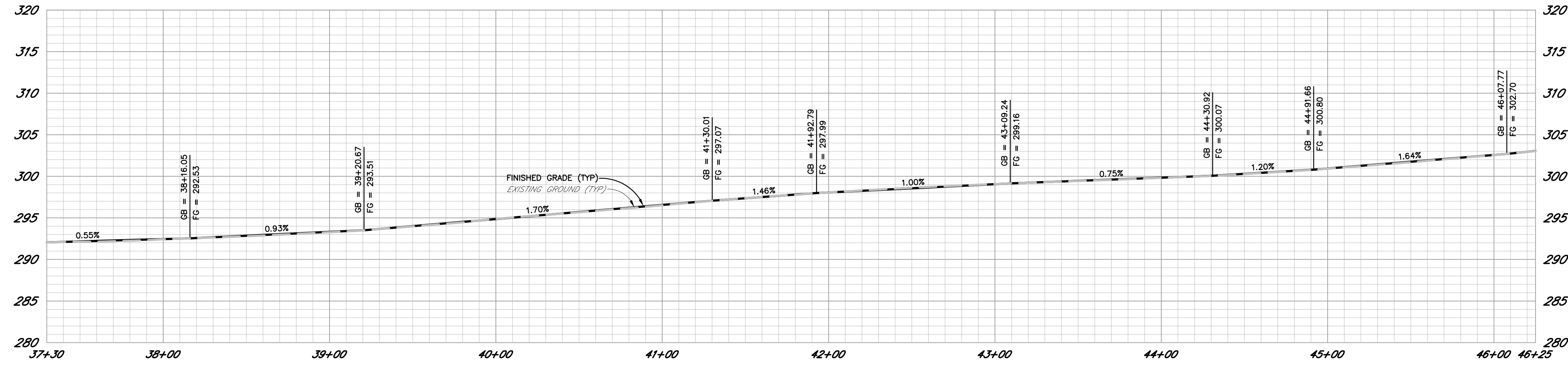

PROFILE
SCALE: HORZ. 1" = 40'
VERT. 1" = 8'

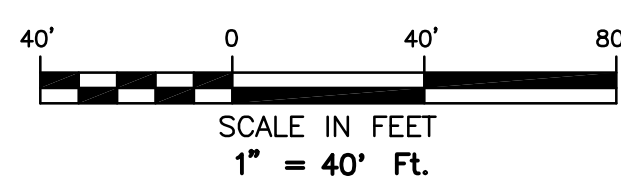
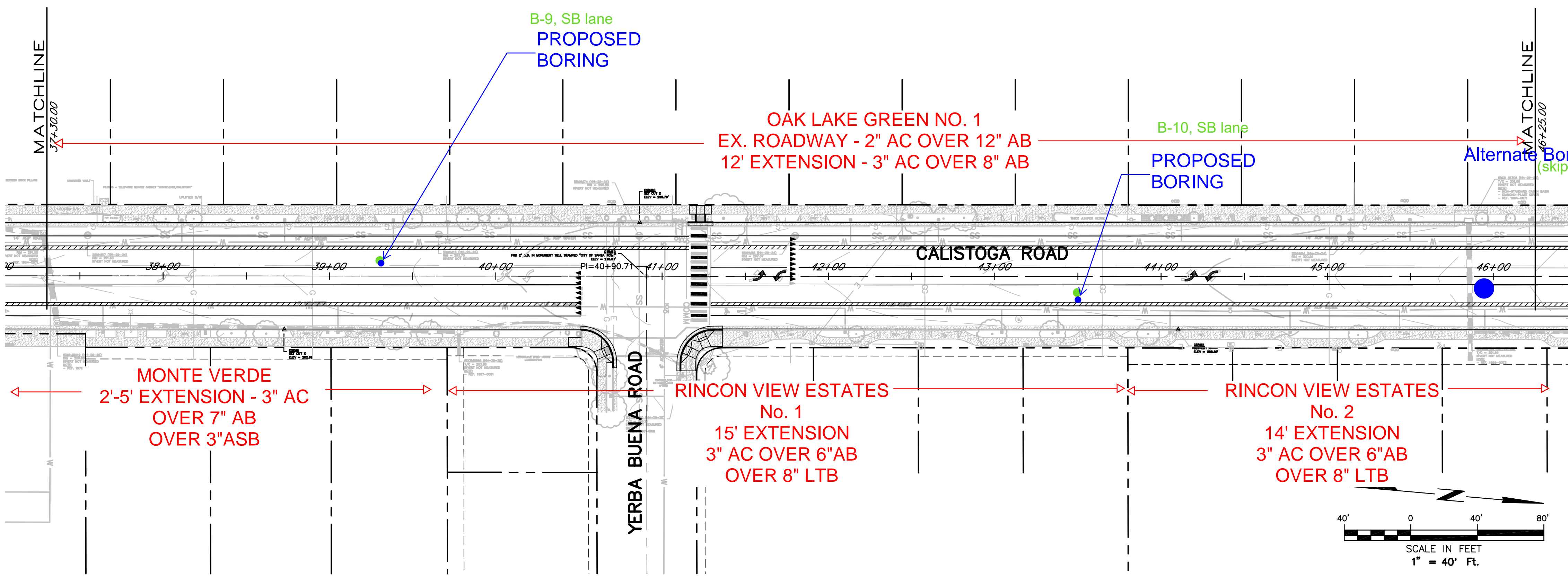

PLAN

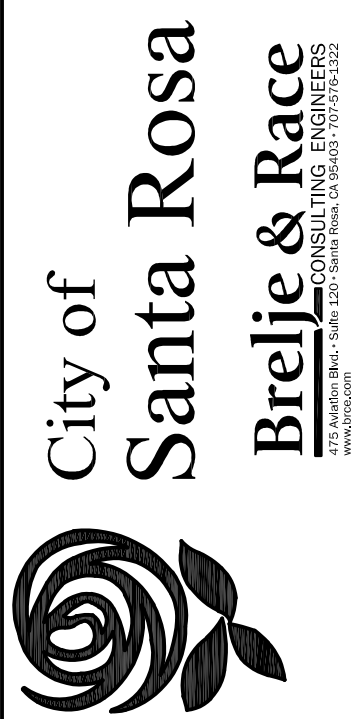
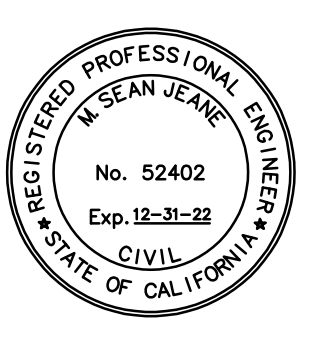

NO.	DATE	REVISION	BY

SCALE: AS SHOWN	DATE: NOVEMBER 2021
DWN BY: JLP	CHK BY: JN

CALISTOGA ROAD PAVEMENT REHABILITATION MONTECITO AVENUE TO STATE ROUTE 12 CALISTOGA ROAD PLAN & PROFILE STA.37+30-STA.46+25

PRELIMINARY
NOT FOR CONSTRUCTION

TAB: 8 CALISTOGA ROAD PLAN & PROFILE STA.46+25-STA.55+20

11-11-21 Pathool 4827.dwg 02_4827.02 PLAN-PROFILE.dwg

SEE SHEET 7

SEE SHEET 7

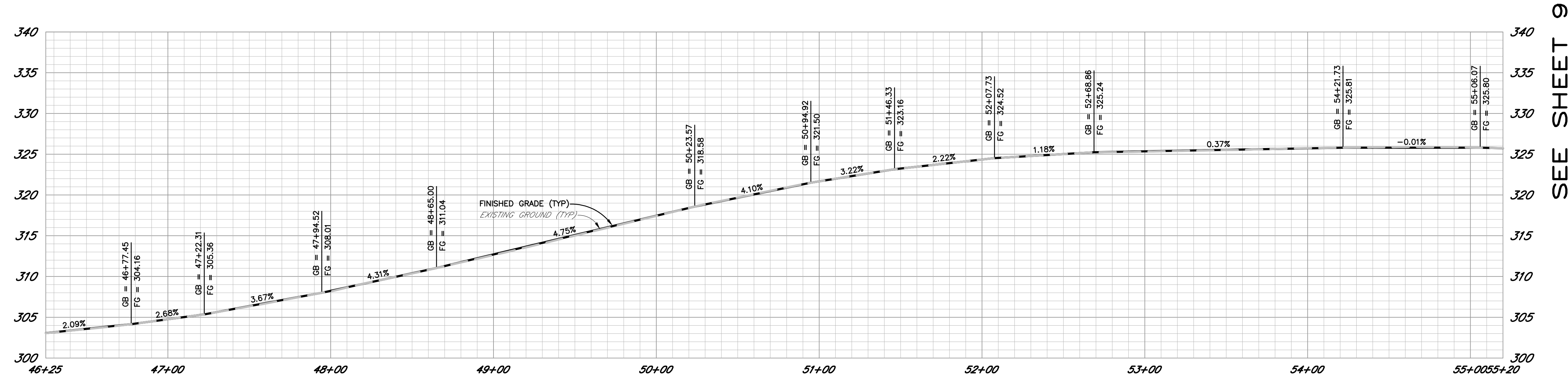

PROFILE
SCALE: HORZ. 1" = 100'
VERT. 1" = 10'

SEE SHEET 9

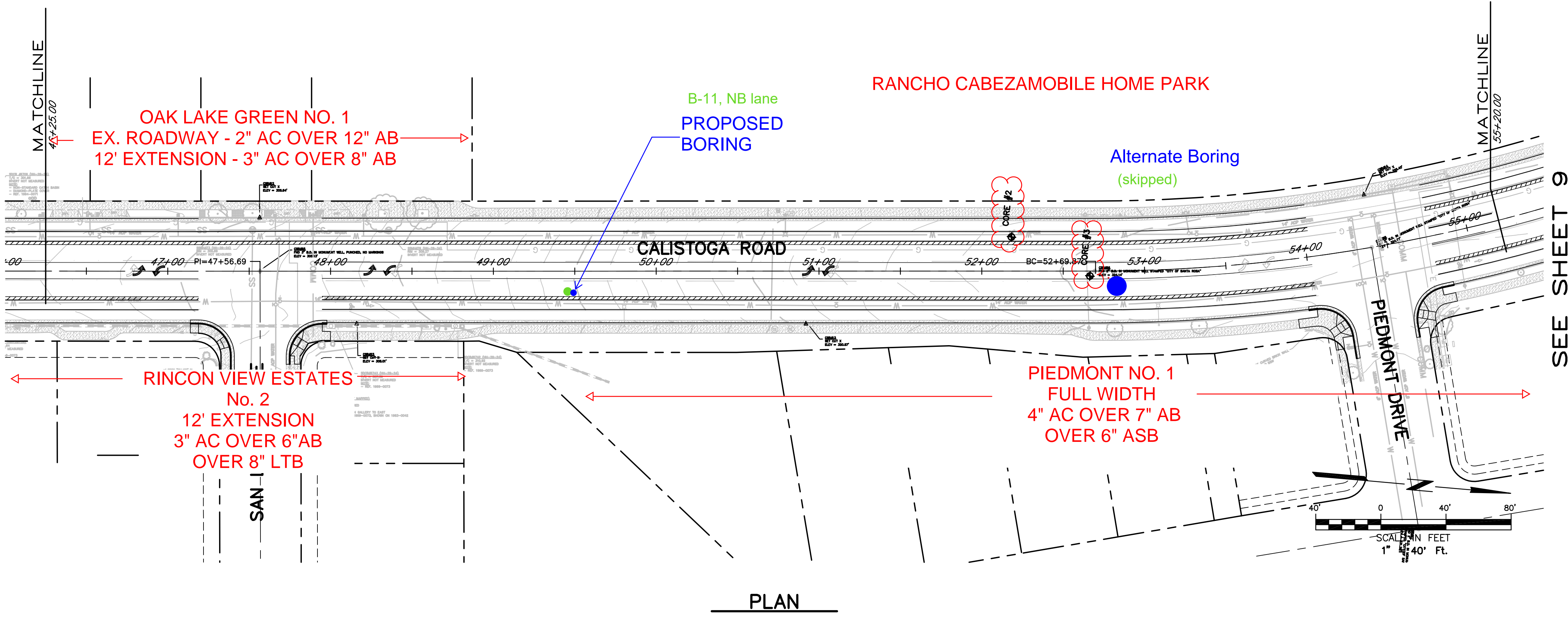

SEE SHEET 9

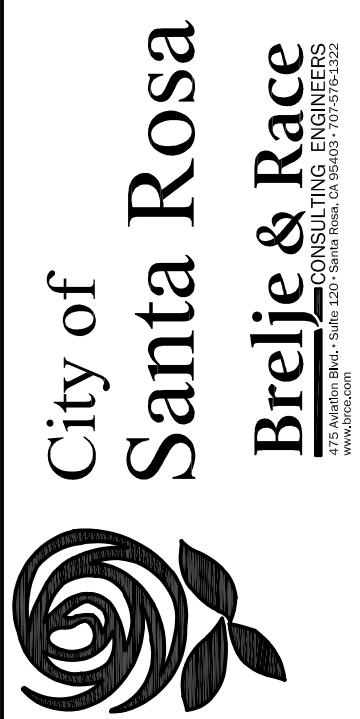

NO.	DATE	REVISION	BY

SCALE: AS SHOWN	DATE: NOVEMBER 2021
DWN BY: JLP	CHK BY: JN

CALISTOGA ROAD PAVEMENT REHABILITATION MONTECITO AVENUE TO STATE ROUTE 12 CALISTOGA ROAD PLAN & PROFILE STA.46+25-STA.55+20

CONTRACT NO. _____

SHEET 8 OF 33

DATE 11-18-21

FILE NO. 202X-XXXX

PRELIMINARY
NOT FOR CONSTRUCTION

11-11-21 Pathed: \\4827\dwg\4827_02\4827.02 PLAN-PROFILE.dwg TAB: 9 CALISTOGA ROAD PLAN & PROFILE STA.55+20-STA.64+15

SEE SHEET 8

SEE SHEET 8

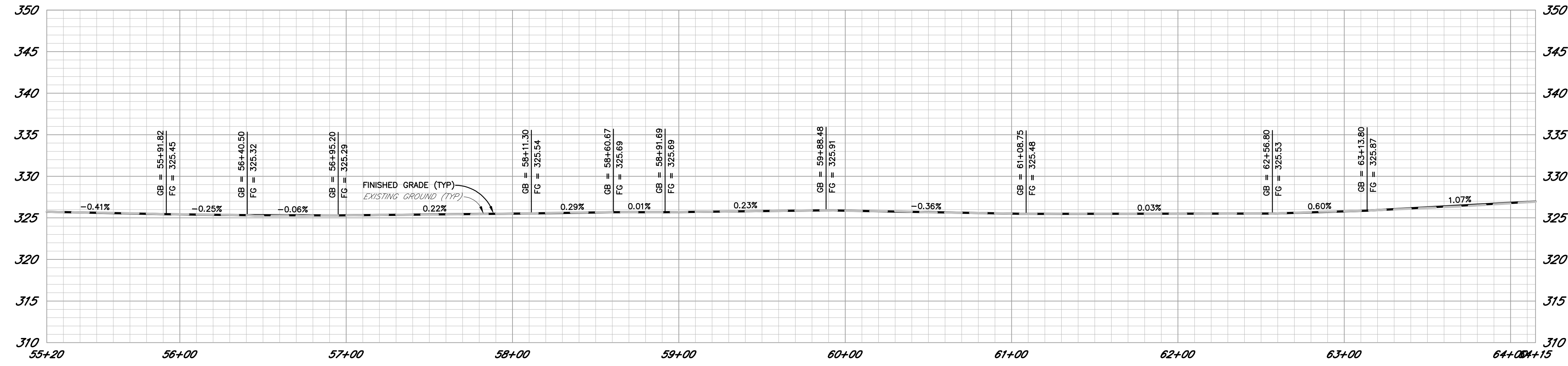

PROFILE
SCALE: HORZ. 1" = 20'
VERT. 1" = 8'

SEE SHEET 10

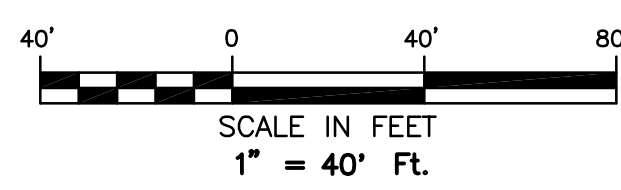
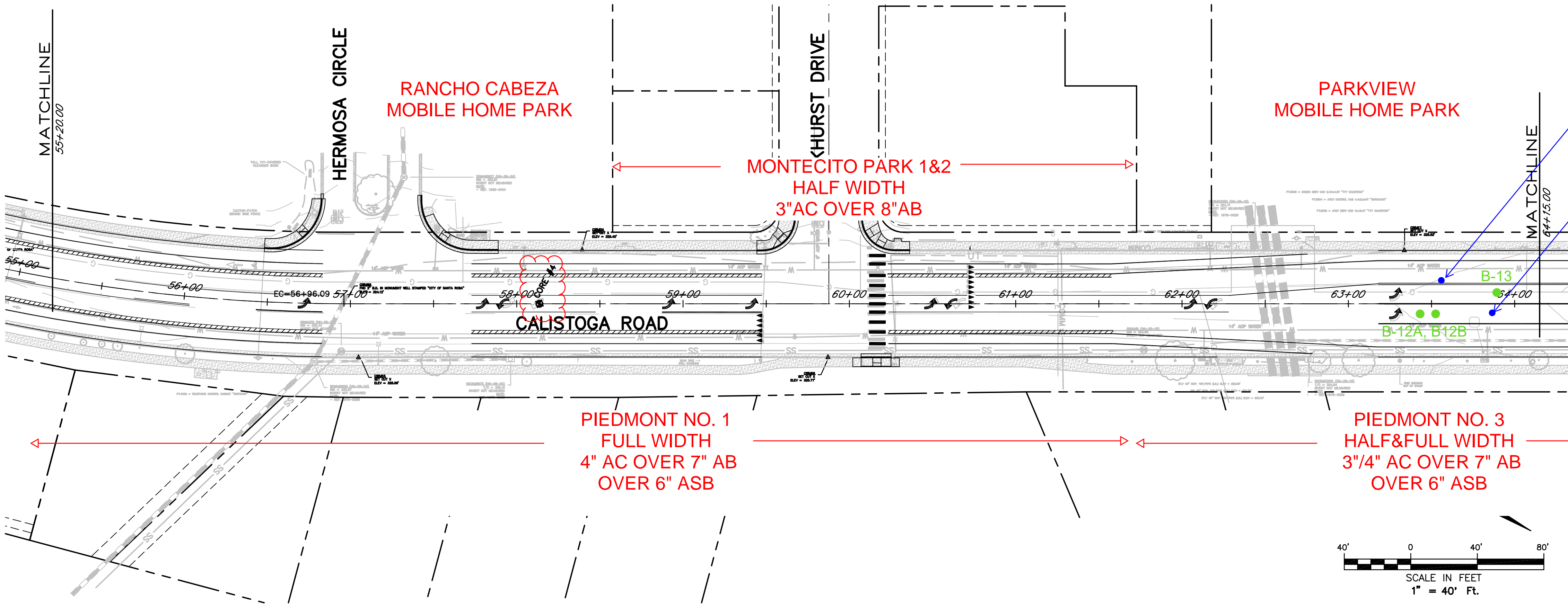

PLAN

SEE SHEET 10

PRELIMINARY
NOT FOR CONSTRUCTION
DATE 11-18-21

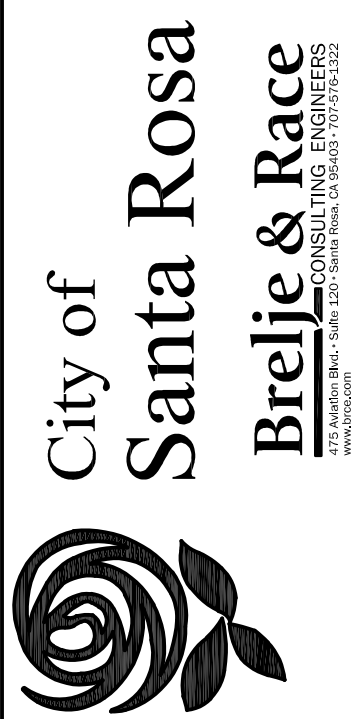
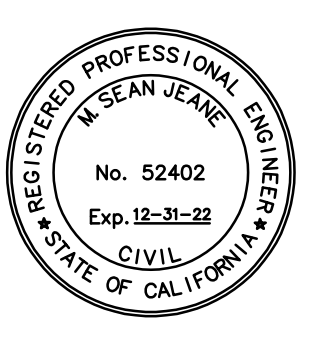

NO.	DATE	REVISION	BY

SCALE: AS SHOWN	DATE: NOVEMBER 2021
DWN BY: JLP	CHK BY: JN

**CALISTOGA ROAD PAVEMENT
REHABILITATION MONTECITO AVENUE
TO STATE ROUTE 12
CALISTOGA ROAD
PLAN & PROFILE
STA.55+20-STA.64+15**

CONTRACT NO.
SHEET 9 OF 33
FILE NO. 202X-XXXX

SEE SHEET 9

SEE SHEET 9

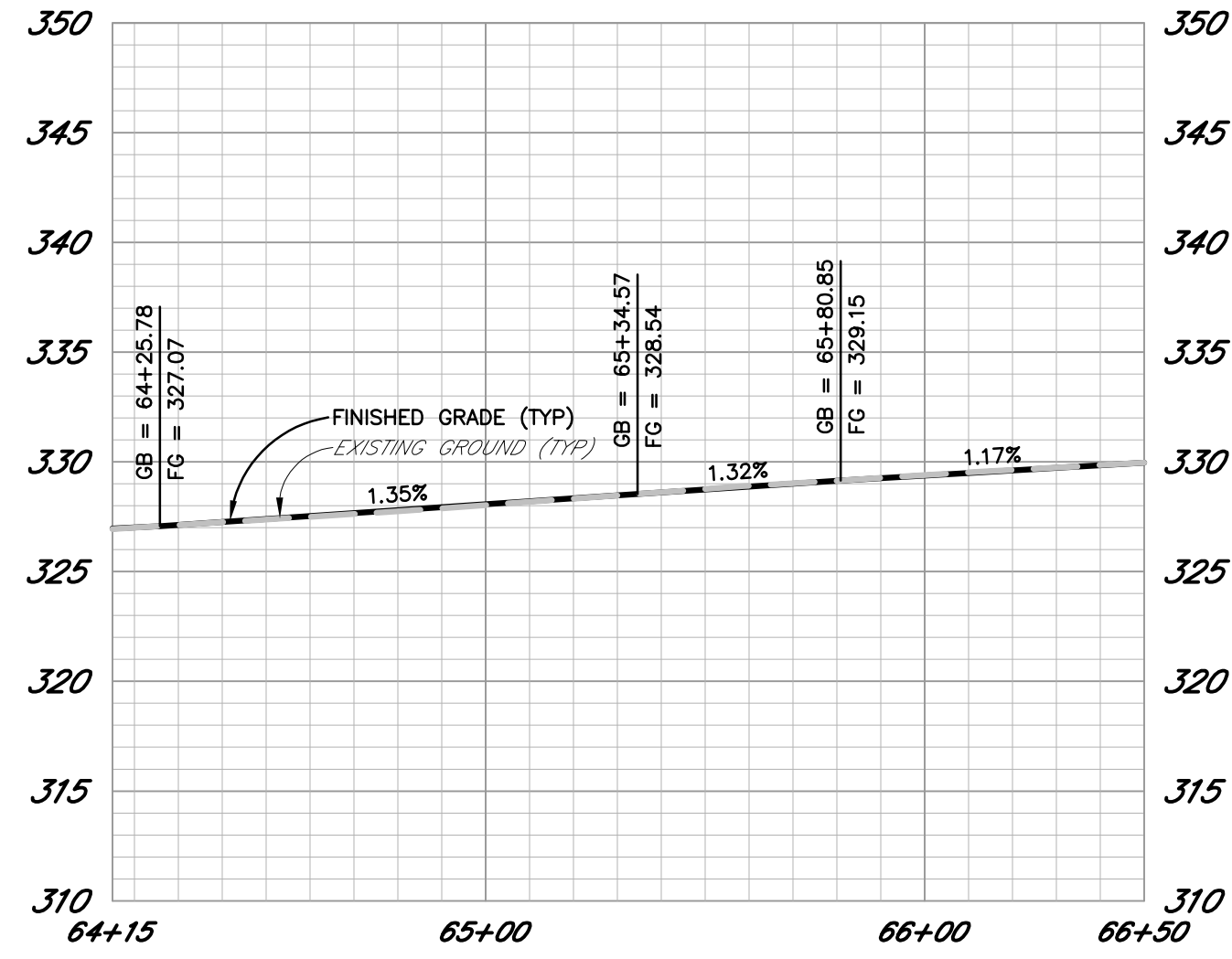

PROFILE

SCALE: HORZ. 1" = 40'
VERT. 1" = 8'

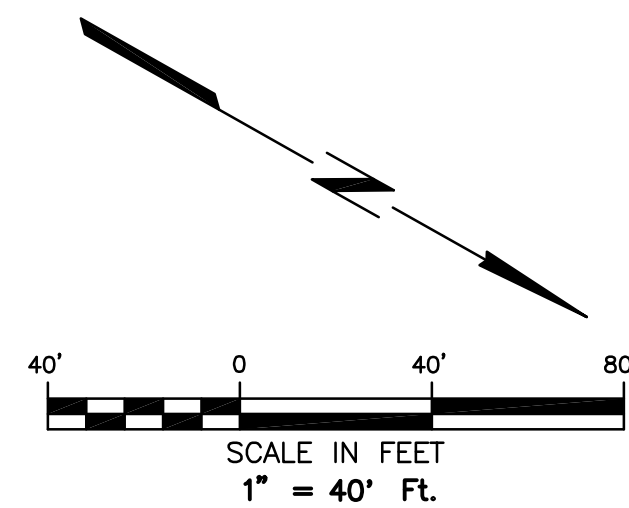
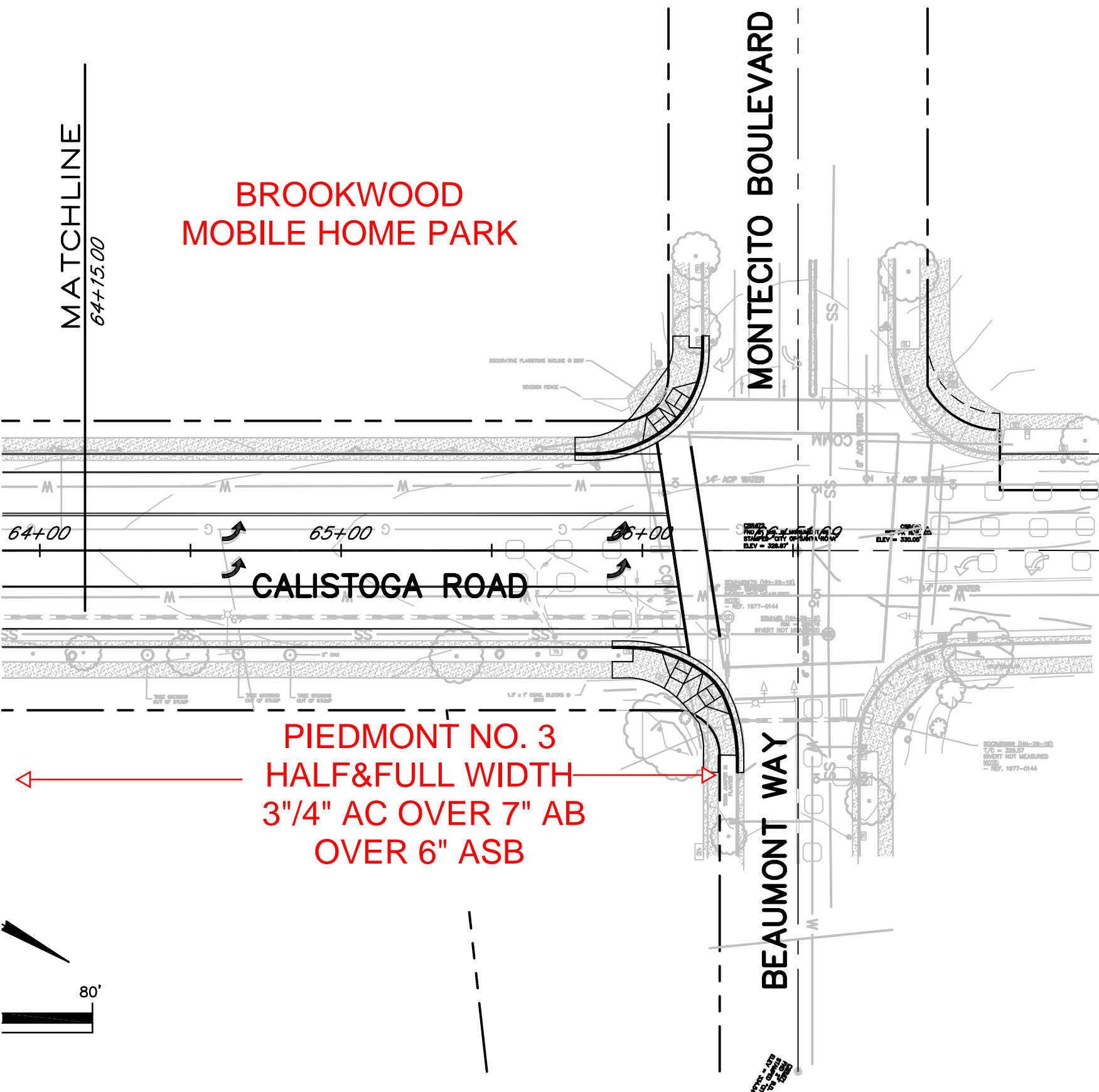

PLAN

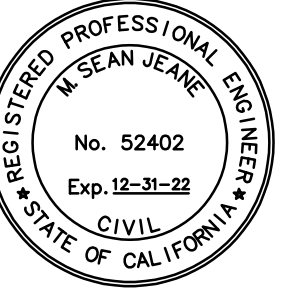

City of
Santa Rosa
Brelje & Race
CONSULTING ENGINEERS
110 Commercial Blvd., Suite 200, Santa Rosa, CA 95403-7070



NO.	DATE	REVISION	BY

SCALE: AS SHOWN	DATE: NOVEMBER 2021
DWN BY: JLP	CHK BY: JN

**CALISTOGA ROAD PAVEMENT
REHABILITATION MONTECITO AVENUE
TO STATE ROUTE 12
CALISTOGA ROAD
PLAN & PROFILE
STA.64+15-STA.66+50**

PRELIMINARY
NOT FOR CONSTRUCTION

R-VALUE TEST REPORT

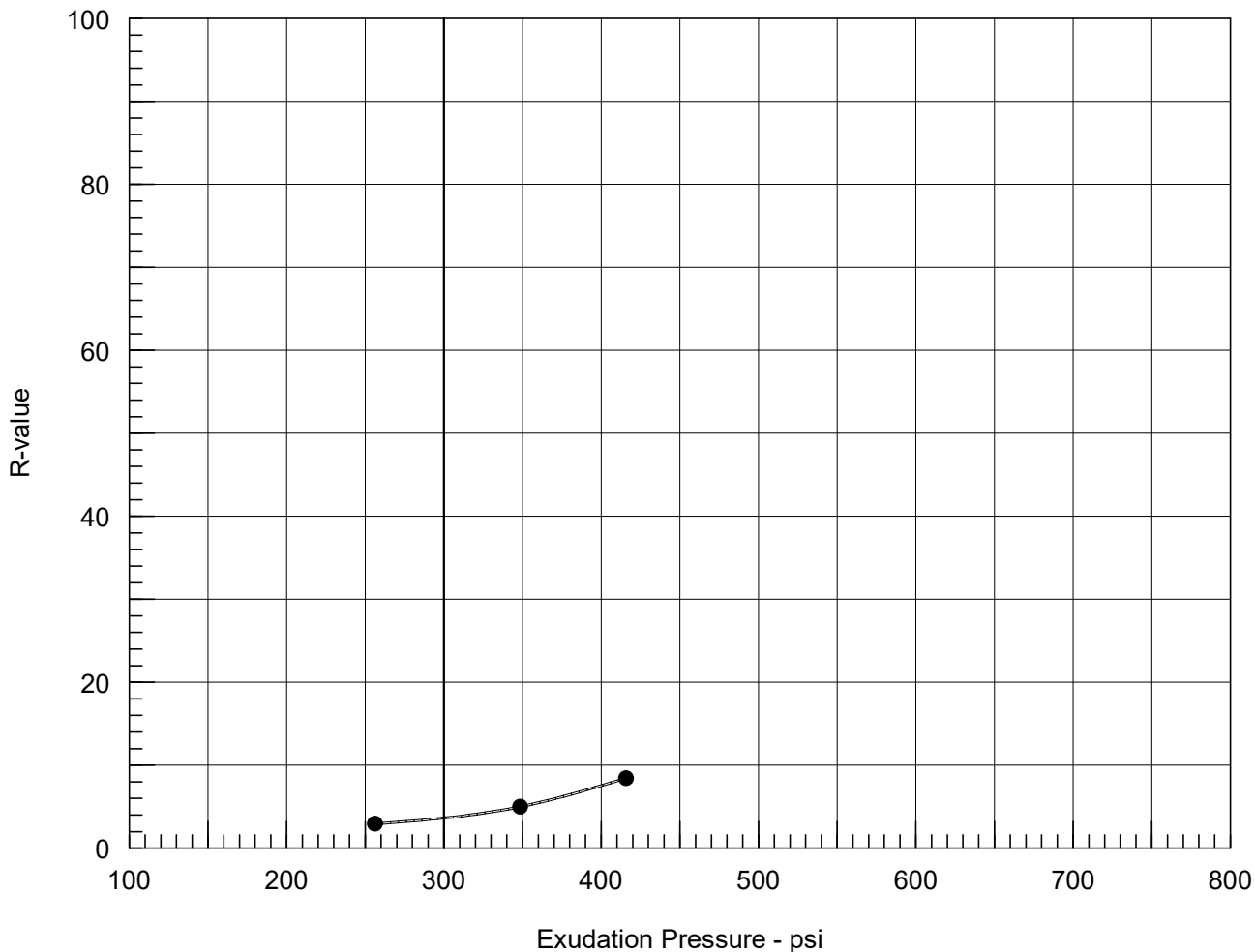

Resistance R-Value and Expansion Pressure - ASTM D2844

No.	Compact. Pressure psi	Density pcf	Moist. %	Expansion Pressure psf	Horizontal Press. psi @ 160 psi	Sample Height in.	Exud. Pressure psi	R Value	R Value Corr.
1	30	95.4	27.2	0	150	2.54	256	3	3
2	30	96.6	24.5	0	145	2.59	348	5	5
3	50	102.7	22.4	0	139	2.56	416	8	8

Test Results	Material Description
R-value at 300 psi exudation pressure = 4	Brown Clay W/ Sand (CH)
Project No.: 1148.61.PW.1 Project: Santa Rosa CIP Projects Source of Sample: Bucket 3A Depth: Subgrade Date: 12/17/2021	Tested by: SAM Checked by: SEF Remarks: Reported 12/17/21
	Figure _____

R-VALUE TEST REPORT

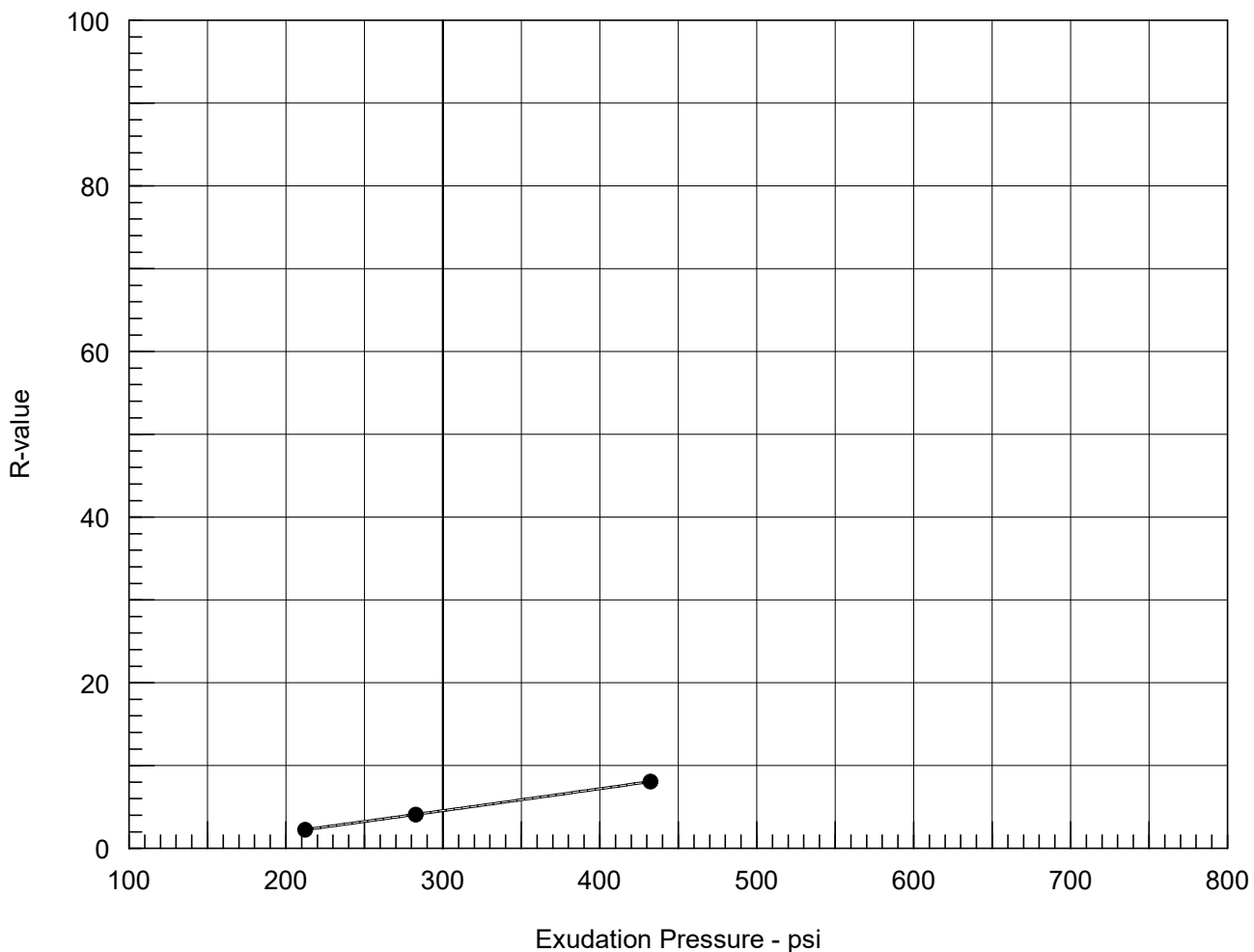

Resistance R-Value and Expansion Pressure - ASTM D2844

No.	Compact. Pressure psi	Density pcf	Moist. %	Expansion Pressure psf	Horizontal Press. psi @ 160 psi	Sample Height in.	Exud. Pressure psi	R Value	R Value Corr.
1	30	98.4	23.7	0	153	2.58	212	2	2
2	30	106.2	21.2	0	148	2.54	283	4	4
3	30	111.0	18.5	0	139	2.53	432	8	8

Test Results	Material Description
<p>R-value at 300 psi exudation pressure = 5</p>	<p>Brown Clay W/ Sand (CH)</p>
<p>Project No.: 1148.61.PW.1 Project: Santa Rosa CIP Projects Source of Sample: Bucket 3 Depth: Subgrade Date: 12/17/2021</p>	<p>Tested by: SAM Checked by: SEF Remarks: Reported 12/17/21</p>
	<p>Figure _____</p>

R-VALUE TEST REPORT

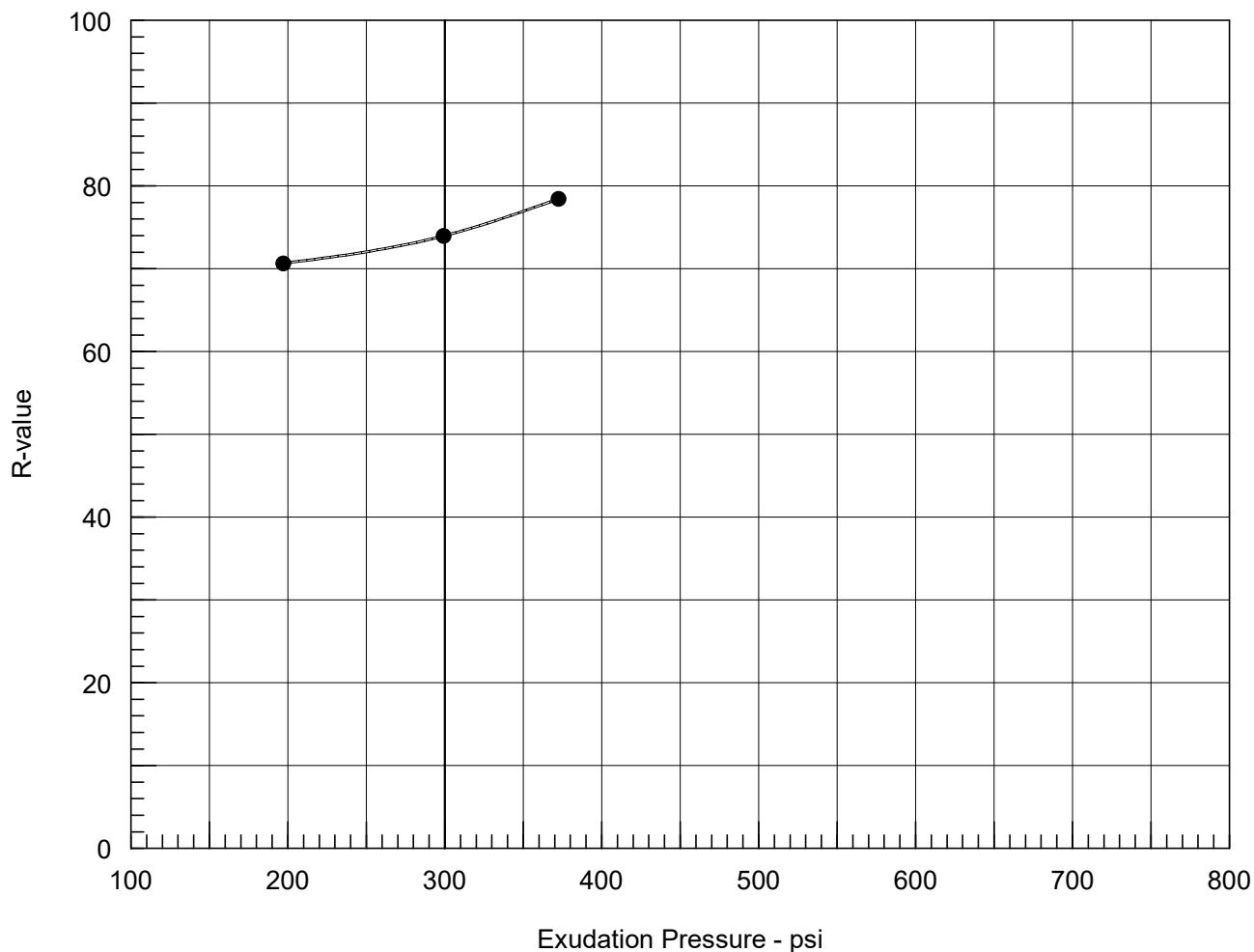

Resistance R-Value and Expansion Pressure - ASTM D2844

No.	Compact. Pressure psi	Density pcf	Moist. %	Expansion Pressure psf	Horizontal Press. psi @ 160 psi	Sample Height in.	Exud. Pressure psi	R Value	R Value Corr.
1	250	129.7	9.1	0	31	2.50	197	71	71
2	350	128.4	8.6	0	28	2.52	299	74	74
3	350	131.3	8.2	0	22	2.41	372	80	78

Test Results	Material Description
R-value at 300 psi exudation pressure = 74	Gray Silty Sand W/ Gravel (SM)
Project No.: 1148.61.PW.1 Project: Santa Rosa CIP Projects Source of Sample: Bucket 1, 1A, 2, 2A, & 2B Composite Sample Number: AC & AB Date: 12/17/2021	Tested by: SAM Checked by: SEF Remarks: Sampled 12/1/21 Received 12/7/21 Reported 12/17/21
	Figure _____

Particle Size Distribution Report

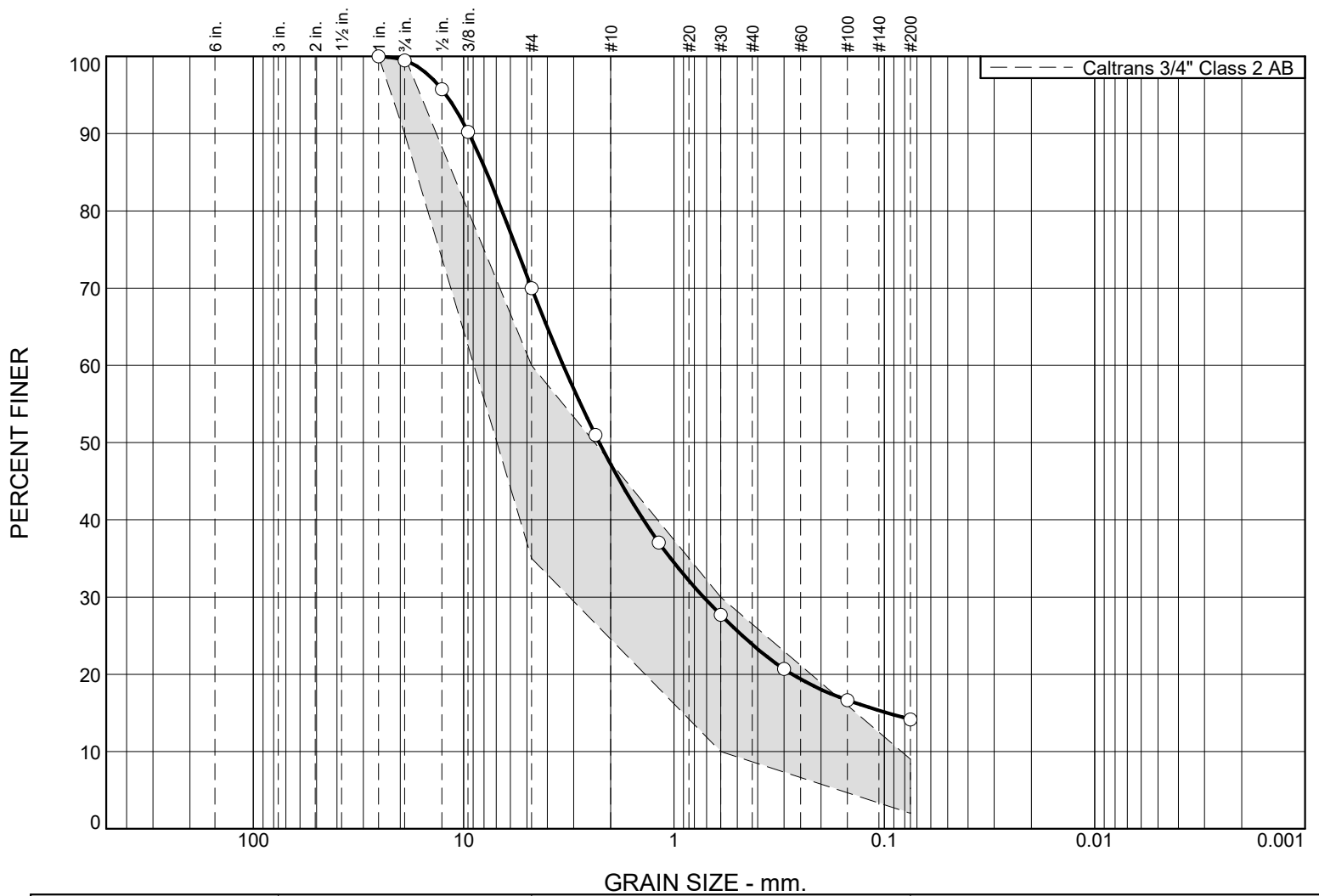

% +3"	% Gravel		% Sand			% Fines	
	Coarse	Fine	Coarse	Medium	Fine	Silt	Clay
0.0	0.5	29.5	22.8	23.3	9.7	14.2	

SOIL DATA					
SYMBOL	SOURCE	SAMPLE NO.	DEPTH (ft.)	Material Description	USCS
○	Bucket 1, 1A, 2, 2A, & 2B	AC & AB		Gray Silty Sand W/ Gravel (SM)	SM
	Composite			Sampled 12/1/21	
				Received 12/7/21	
				Reported 12/17/21	



Client: RGH Consultants
Project: Santa Rosa CIP Projects
Project No.: 1148.61.PW.1

Figure

Tested By: SAM

Checked By: SEF