

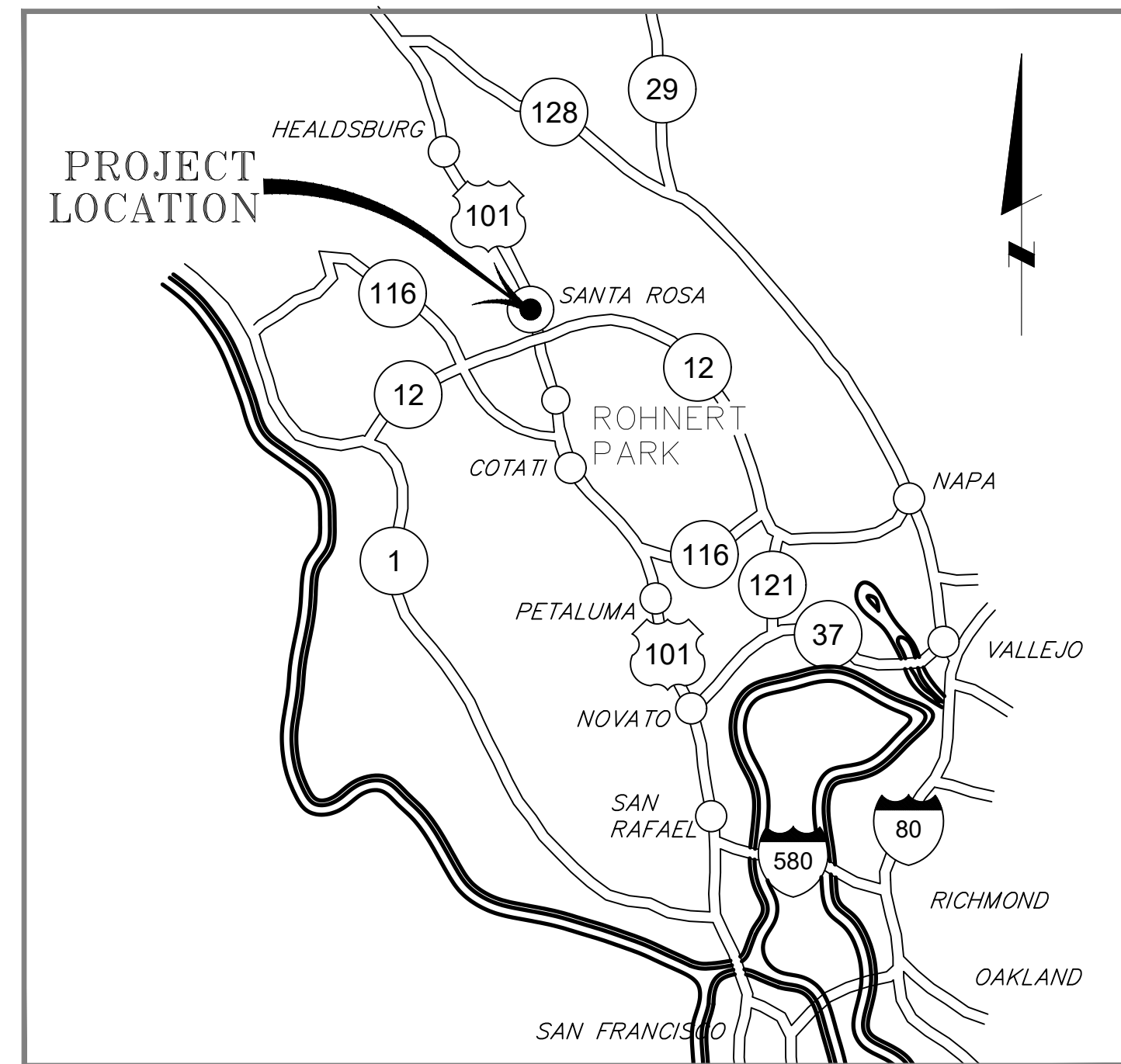

CITY OF SANTA ROSA
IMPROVEMENT PLANS FOR

SANTA ROSA AVENUE AT BELLEVUE AVENUE TRAFFIC SIGNAL INSTALLATION

CONTRACT No. C02283



VICINITY MAP
NOT TO SCALE

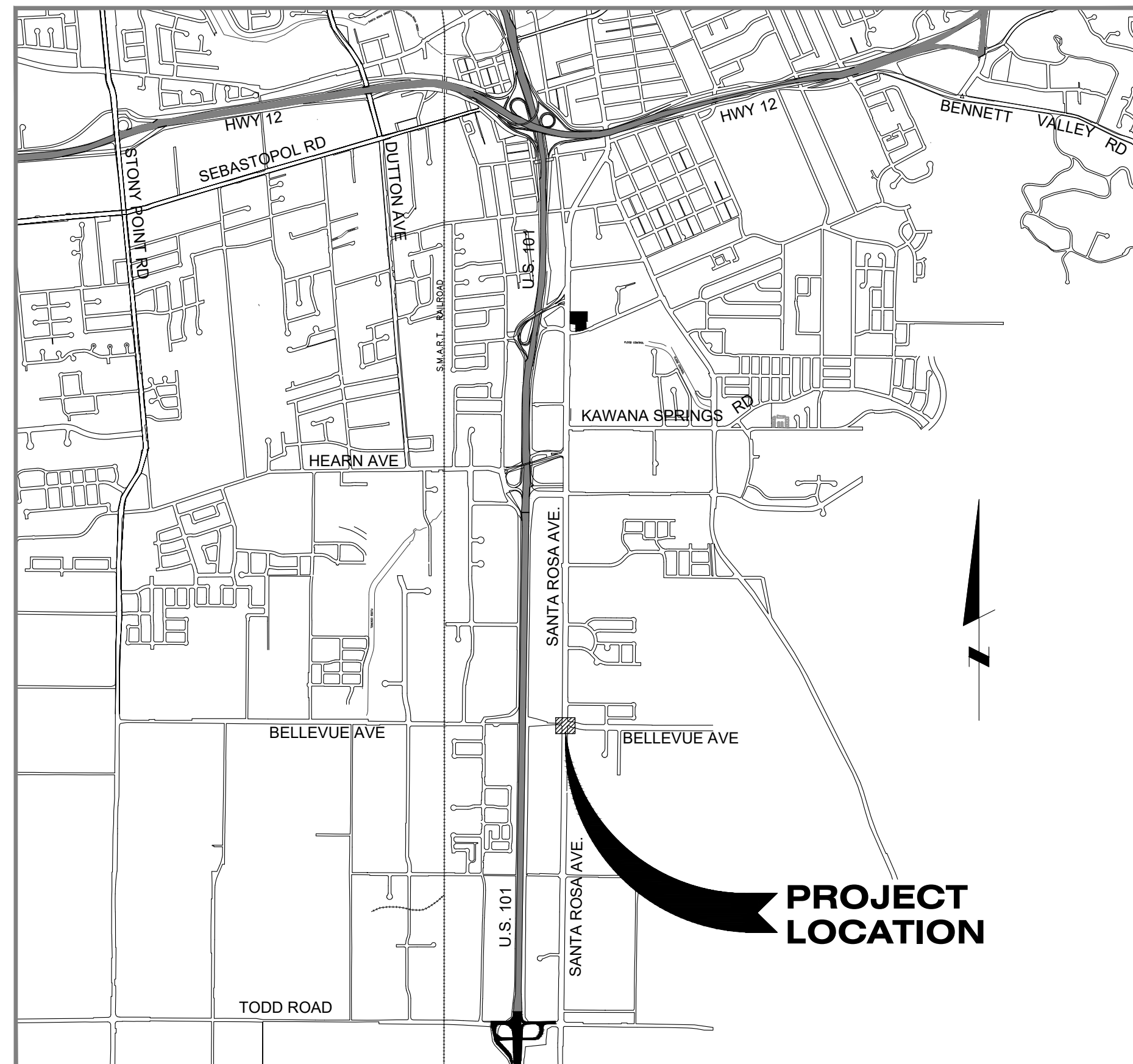

LOCATION MAP
NOT TO SCALE

INDEX TO SHEETS

| SHEET NO. | TITLE |
|-----------|--|
| 1. | C0.0 COVER SHEET |
| 2. | C0.1 SURVEY, ABBREVIATIONS, & LEGENDS |
| 3. | C1.0 EXISTING CONDITIONS & DEMOLITION PLAN |
| 4. | C2.0 IMPROVEMENT PLAN |
| 5. | C2.1 CURB RAMP DETAILS |
| 6. | C3.0 SIGNING AND STRIPING PLAN |
| 7. | TS1.0 TRAFFIC SIGNAL PLAN |
| 8. | TS2.0 TRAFFIC SIGNAL |

GENERAL NOTES:

- ALL WORKMANSHIP, MATERIALS, AND CONSTRUCTION SHALL CONFORM TO THE CITY OF SANTA ROSA STANDARDS AND SPECIFICATIONS, THE INVITATION FOR BIDS FOR THIS PROJECT, PERMITS, AND THE STATE STANDARD SPECIFICATIONS AND STANDARD PLANS. THE CONTRACTOR IS RESPONSIBLE FOR UNDERSTANDING ALL STANDARDS PERTAINING TO THIS PROJECT.
- THE CONTRACTOR SHALL CALL UNDERGROUND SERVICE ALERT (USA *NORTH*) AT 811 NO LESS THAN 2 WORKING DAYS PRIOR TO ANY EXCAVATION FOR MARK OUTS OF EXISTING UNDERGROUND FACILITIES IN ACCORDANCE WITH ARTICLE 7.13 OF THE GENERAL CONDITIONS.
- THE LOCATIONS OF UNDERGROUND UTILITIES AND OTHER OBSTACLES SHOWN ON THE PLANS ARE BASED ON THE BEST AVAILABLE INFORMATION. THE CONTRACTOR SHALL POTHOLE AND DETERMINE THE EXACT LOCATION OF ALL POTENTIAL CONFLICTS IN ACCORDANCE WITH U.S.A. LAWS AND THE INVITATION FOR BIDS. IF ANY UNMARKED UTILITIES ARE ENCOUNTERED, OR IF UNABLE TO LOCATE A MARKED UTILITY AFTER POT HOLING, THE CONTRACTOR SHALL IMMEDIATELY NOTIFY THE OWNER OF THAT UTILITY AND THE ENGINEER.
- ALL SEWER MANHOLES, MAINLINE CLEANOUTS AND WATER VALVES THAT ARE ON ACTIVE SYSTEMS SHALL BE ACCESSIBLE TO CITY PERSONNEL AT ALL TIMES AND SHALL BE BROUGHT TO GRADE WITHIN 48 HOURS OF PAVING.
- THE CONTRACTOR SHALL PROTECT AND PRESERVE CITY MONUMENTS. THE CONTRACTOR SHALL COORDINATE WITH THE CITY ENGINEER 10 WORKING DAYS IN ADVANCE FOR REFERENCING OF EXISTING MONUMENTS TO BE DISTURBED. THE CONTRACTOR SHALL RECONSTRUCT DISTURBED MONUMENTS IN ACCORDANCE WITH CITY STANDARD 280.
- OVERHEAD UTILITY SERVICE DROPS ARE NOT SHOWN ON THE PLANS. THE CONTRACTOR SHALL INVESTIGATE THE SITE AND BE AWARE OF LIMITED CLEARANCES UNDER OVERHEAD UTILITY LINES AND LOW HANGING TREE BRANCHES. THE CONTRACTOR'S TRUCKS AND EXCAVATION EQUIPMENT SHALL BE SIZED SO THAT OVERHEAD WIRES AND TREE BRANCHES ARE NOT DAMAGED.
- ALL EXCAVATED MATERIAL SHALL BE DISPOSED OF AS GENERATED AND AT NO TIME SHALL THE CONTRACTOR PLACE EXCAVATED MATERIAL AT THE WORK SITE.
- THE CONTRACTOR SHALL ONLY REMOVE EXISTING TREES OR SHRUBS AS NOTED ON THE PLANS OR AS DIRECTED BY THE ENGINEER.
- FOR CLARITY OF EXISTING SUBSURFACE CONDITIONS, NOT ALL CROSSWALKS, STOP BARS, OR EXISTING PAVEMENT MARKINGS ARE SHOWN ON THE PLANS. TRAFFIC STRIPES, RAISED PAVEMENT MARKERS AND PAVEMENT MARKINGS DAMAGED DUE TO THE CONTRACTOR'S OPERATIONS SHALL BE REPLACED PER CITY OF SANTA ROSA TRAFFIC STANDARDS PART III, TRAFFIC MARKINGS. PATCHING OF DAMAGED MARKINGS WILL NOT BE ALLOWED WITHOUT PRIOR APPROVAL FROM THE ENGINEER. ALL DAMAGED RAISED PAVEMENT (NON-REFLECTIVE) MARKERS MUST BE CERAMIC.

RECORD PLAN DATA

| | |
|------------------------------|-----------------------|
| PROJECT START: | WATER SERVICE TYPE: |
| PROJECT END: | MANUFACTURER: |
| GEN. CONTRACTOR: | FIRE HYDRANT TYPE: |
| SUPERINTENDENT: | MANUFACTURER: |
| UNDERGROUND CONTRACTOR: | INSPECTOR: |
| FOREMAN: | CONSTRUCTION MANAGER: |
| SEWER PIPE TYPE: | RECORD PLANS BY: |
| MANUFACTURER: | ADDITIONAL INFO: |
| SEWER FITTINGS MANUFACTURER: | |
| M.H. MANUFACTURER: | |
| WATER PIPE TYPE: | |
| MANUFACTURER: | |
| WATER VALVE MANUFACTURER: | |
| WATER FITTINGS MANUFACTURER: | |

BEFORE EXCAVATING
CALL U.S.A NORTH.
UNDERGROUND SERVICE ALERT
CALL 811
NO LESS THAN TWO WORKING
DAYS BEFORE ALL PLANNED
WORK OPERATIONS

| | | |
|---|------------------|------------|
| APPROVED: DIRECTOR OF TRANSPORTATION AND PUBLIC WORKS | | |
| BY: | DATE: 05/19/2026 | |
| DAN HENNESSEY | | |
| DEPT. | SIGNATURE | DATE |
| DESIGN/CONST | | 05/19/2026 |
| MATERIALS LAB | | 05/20/2026 |
| PARKS & REC | | |
| SURVEY | | 05/21/2026 |
| TRAFFIC | | 05/21/2026 |
| TRANSIT | | 05/21/2026 |
| WATER - ENG | | |
| WATER - OPS | | |



City of Santa Rosa



CITY OF SANTA ROSA
SANTA ROSA AVE AT BELLEVUE AVE TRAFFIC SIGNAL

COVER SHEET

| | |
|--------------|-----------|
| CHK BY: | GAM |
| DATE: | MAY 2026 |
| DWN BY: | CDA |
| SCALE: | AS SHOWN |
| CONTRACT NO. | C02283 |
| SHEET | 1 OF 8 |
| FILE NO. | 2025-0026 |
| C0.0 | |



5/18/2026

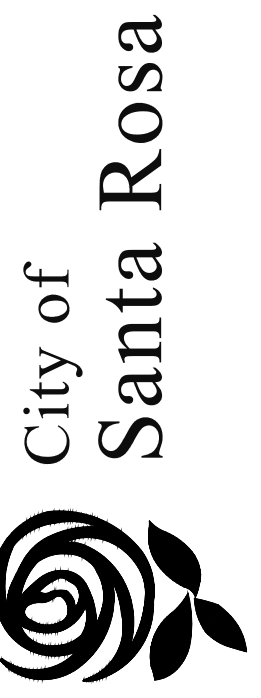

| NO. | DATE | REVISION | BY |
|-----|------|----------|----|
| | | | |
| | | | |
| | | | |
| | | | |

CITY OF SANTA ROSA
 SANTA ROSA AVE AT BELLEVUE AVE TRAFFIC SIGNAL
**EXISTING CONDITIONS
 AND DEMOLITION PLAN**

CHK BY: GAM
 DATE: MAY 2026
 DWN BY: CDA
 SCALE: AS SHOWN
 CONTRACT NO. C02283
 SHEET 3 OF 8
 FILE NO. 2025-0026

C1.0

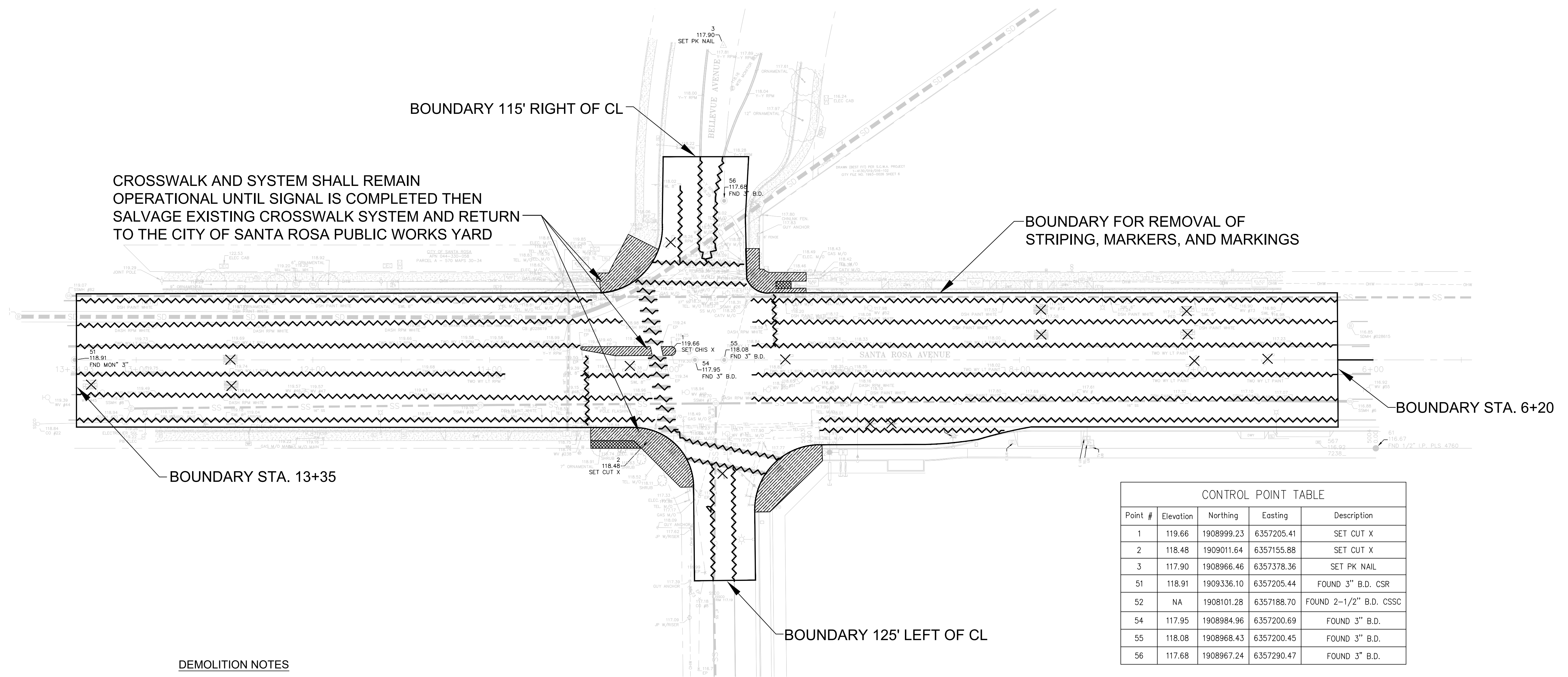

CROSSWALK AND SYSTEM SHALL REMAIN OPERATIONAL UNTIL SIGNAL IS COMPLETED THEN SALVAGE EXISTING CROSSWALK SYSTEM AND RETURN TO THE CITY OF SANTA ROSA PUBLIC WORKS YARD

BOUNDARY FOR REMOVAL OF STRIPING, MARKERS, AND MARKINGS

BOUNDARY STA. 13+35

BOUNDARY STA. 6+20



BOUNDARY 125' LEFT OF CL

| Point # | Elevation | Northing | Easting | Description |
|---------|-----------|------------|------------|------------------------|
| 1 | 119.66 | 1908999.23 | 6357205.41 | SET CUT X |
| 2 | 118.48 | 1909011.64 | 6357155.88 | SET CUT X |
| 3 | 117.90 | 1908966.46 | 6357378.36 | SET PK NAIL |
| 51 | 118.91 | 1909336.10 | 6357205.44 | FOUND 3" B.D. CSR |
| 52 | NA | 1908101.28 | 6357188.70 | FOUND 2-1/2" B.D. CSSC |
| 54 | 117.95 | 1908984.96 | 6357200.69 | FOUND 3" B.D. |
| 55 | 118.08 | 1908968.43 | 6357200.45 | FOUND 3" B.D. |
| 56 | 117.68 | 1908967.24 | 6357290.47 | FOUND 3" B.D. |

DEMOLITION NOTES

- ITEMS REMOVED FOR CLEARING AND GRUBBING SHALL BECOME PROPERTY OF THE CONTRACTOR AND DISPOSED OF.
- CONTRACTOR TO PROTECT ALL EXISTING TREES WITHIN APPROXIMATELY 5 FEET OF DEMOLITION LIMITS NOT INDICATED FOR REMOVAL.
- CONTRACTOR SHALL BE RESPONSIBLE FOR DAMAGE DUE TO CONTRACTOR OPERATIONS.
- REMOVE AND SALVAGE EXISTING SIGNS IN CONSTRUCTION AREA.
- PROTECT MANHOLE AND UTILITY BOX/COVERS DURING ALL OPERATIONS. ADJUST ALL COVERS TO FINISHED GRADE.
- COORDINATE WITH THE APPROPRIATE UTILITY COMPANY TO ADJUST PULL BOXES TO GRADE IN CONCRETE REPLACEMENT AREAS.
- FOR ADDITIONAL INFORMATION ABOUT UTILITY DEMO, REPLACEMENT, OR INSTALLATION CONTACT THE APPROPRIATE UTILITY OWNER.
- FOR NEW TRAFFIC SIGNAL LOCATIONS SEE TRAFFIC SIGNAL DRAWINGS.
- ALL TREES WITH ROOTS OR BRANCHES WITHIN THE AREA OF IMPROVEMENT SHALL BE TRIMMED UNDER DIRECTION OF CONTRACTORS ARBORIST.
- R1-1 STOP SIGNS SHALL BE TEMPORARILY MOUNTED ON BARRICADES OR SIGN POLES UNTIL SIGNALS ARE IN PLACE AND OPERATIONAL.

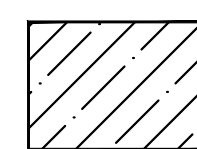
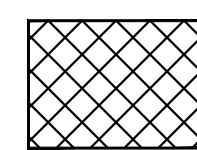
LEGEND

-  REMOVE ALL EXISTING SURFACE IMPROVEMENTS, INCLUDING, BUT NOT LIMITED TO, ASPHALT AND CONCRETE, CURBS, BASE MATERIAL, WITHIN THE LIMITS OF THE HATCHING IDENTIFIED AND PROPERLY DISPOSE OF OFFSITE, UNLESS OTHERWISE NOTED.
-  REMOVE ALL EXISTING VEGETATION, INCLUDING, BUT NOT LIMITED TO GRASS, PLANTS, SHRUBS, ETC, WITHIN THE LIMITS OF THE HATCHING IDENTIFIED AND PROPERLY DISPOSE OF OFFSITE, UNLESS OTHERWISE NOTED.
-  REMOVE STRIPING AND MARKERS
-  REMOVE MARKINGS

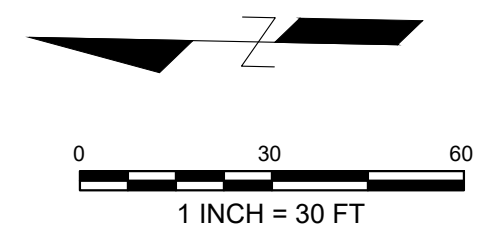



5/18/2026



SIGN LEGEND (NEW OR RELOCATED SIGNS ONLY)



R3-4

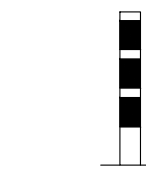

TYPE Q (CA)

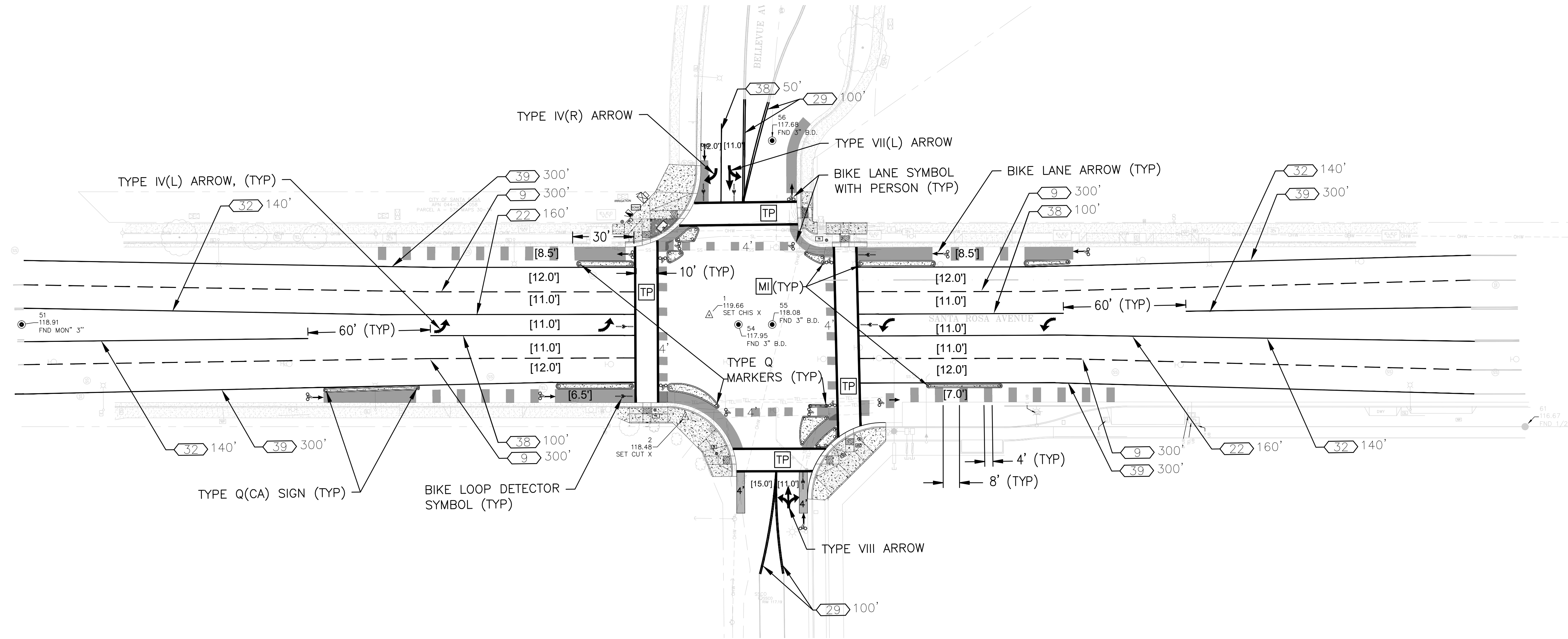

LEGEND

- INSTALL NEW SIGN ON EXISTING POST/POLE
- NEW SIGN POST, SIGNS PER PLAN
- EXISTING SIGN TO REMAIN
- REMOVE SIGN, DISPOSITION PER PLAN
- INSTALL TYPE IV(L) ARROW PER CSP A24A
- NEW STREET LIGHT
- EXISTING STREET LIGHT TO BE REMOVED
- INSTALL BIKE LOOP DETECTOR SYMBOL PER CSP A24C
- INSTALL BIKE LANE SYMBOL WITH PERSON AND BIKE LANE ARROW PER CSP A24A AND A24C
- INSTALL MEDIAN ISLAND TREATMENT PER CITY STANDARD 721
- INSTALL 12" THERMOPLASTIC CROSSWALK, WHITE UNLESS OTHERWISE NOTED
- XXX' INSTALL PAVEMENT MARKERS AND TRAFFIC LINES PER CALTRANS A20 TYPICAL DETAILS AND DISTANCE

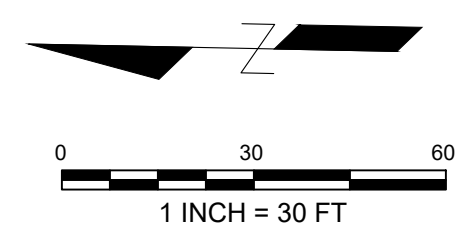

| NO. | DATE | REVISION | BY |
|-----|------|----------|----|
| | | | |
| | | | |
| | | | |

CITY OF SANTA ROSA
 SANTA ROSA AVE AT BELLEVUE AVE TRAFFIC SIGNAL
SIGNING AND STRIPING

CHK BY: GAM
 DATE: MAY 2026
 DWN BY: CDA
 SCALE: AS SHOWN
 CONTRACT NO. C02283
 SHEET 6 OF 8
 FILE NO. 2025-0026

C3.0

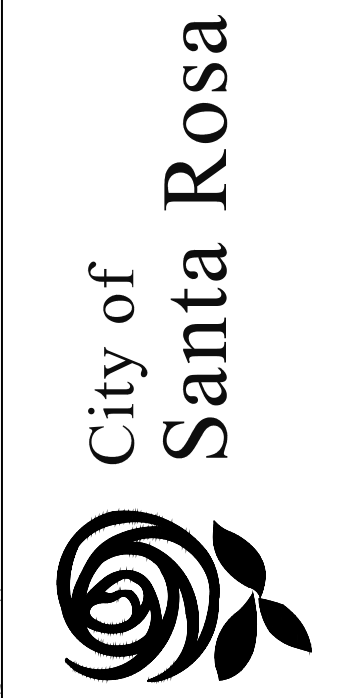

| NO. | DATE | REVISION | BY |
|-----|------|----------|----|
| | | | |
| | | | |
| | | | |
| | | | |
| | | | |
| | | | |
| | | | |
| | | | |
| | | | |

CITY OF SANTA ROSA
 SANTA ROSA AVE AT BELLEVUE AVE TRAFFIC SIGNAL
TRAFFIC SIGNAL PLAN
 CHK BY: GAM
 DATE: MAY 2026
 DWN BY: CDA
 SCALE: AS SHOWN
 CONTRACT NO. C02283
 SHEET 7 OF 8
 FILE NO. 2025-0026
TS1.0

| LOC. | STANDARD | | VEHICLE SIGNAL | | VEHICLE SIGNAL | | VEHICLE SIGNAL | | VEHICLE SIGNAL | | VEHICLE SIGNAL | | LED LUMIN. | ADDITIONAL EQUIPMENT | NOTES |
|------|----------|-----|----------------|-----|----------------|-------|----------------|-----|----------------|-----|----------------|--------|------------|--------------------------|---|
| | TYPE | HT | SMA | LMA | MTG | DIR | MTG | DIR | MTG | DIR | MTG | DIR | | | |
| (A) | 18-1-100 | 17' | 20' | | | | | | | | | | | EVA, G7 "SANTA ROSA AVE" | |
| (B) | 1-B | 10' | | | | | | | | | | | | | MOUNT ON TOP OF CURB |
| (C) | 1-B | 10' | | | | | | | | | | | | | |
| (D) | 29-5-100 | 30' | 55' | 15' | MAT MAS MAS | 7 4 4 | SV-1-T | | | 4 | 2P | SP-1-T | | 87W | EVB, G7 "BELLEVUE AVE", AND MIOVISION CAMERA |
| (E) | 1-B | 10' | | | | | | | | 6 | 2 | 4P | SP-1-T | | |
| (F) | 17-2-100 | 30' | 15' | 8' | MAS | 6 | SV-1-T | | | 6 | 4P | SP-1-T | 4P | 87W | EVC, G7 "SANTA ROSA AVE" |
| (G) | 1-B | 10' | | | | | | | | 3 | 4 | 6P | SP-1-T | | |
| (H) | PBAP | 6' | | | | | | | | | | | 6P | --> | |
| (I) | 29-5-100 | 30' | 50' | 15' | MAT MAS MAS | 3 8 8 | | | | | | | | 87W | EVD, G7 "BELLEVUE AVE", MIOVISION CAMERA, AND WIRELESS BRIDGE |
| (J) | 1-B | 10' | | | | | | | | 2 | 2P | SP-2-T | 2P 8P | --> <-- | MOUNT ON TOP OF CURB AND REMOVE EX PBAP |

ALL NEW POLE LOCATIONS ARE APPROXIMATE. CONTRACTOR TO VERIFY CLEARANCES TO UNDERGROUND UTILITIES. POLES WITH PEDESTRIAN PUSH BUTTONS TO BE CONFIRMED FOR ADA, CA MUTCD COMPLIANCE.

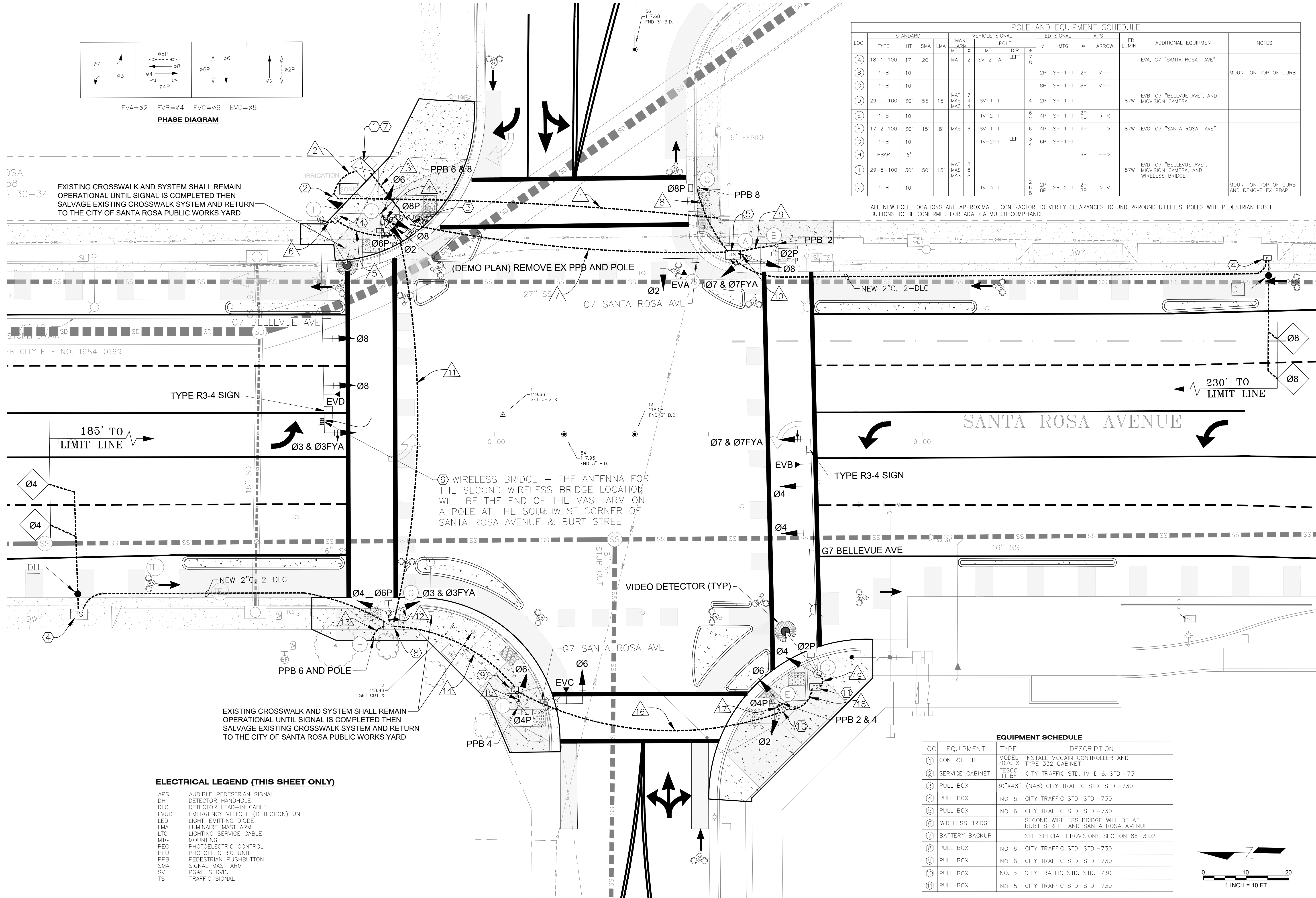
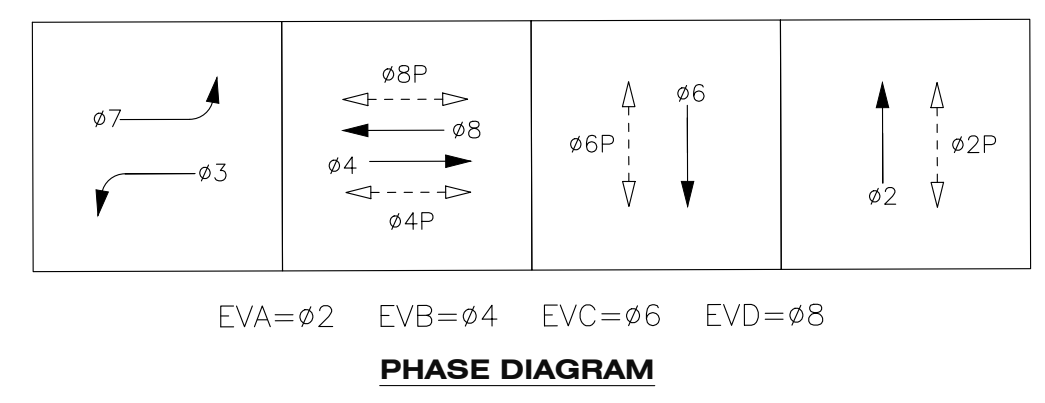

ELECTRICAL LEGEND (THIS SHEET ONLY)

- APS AUDIBLE PEDESTRIAN SIGNAL
- DH DETECTOR HANDHOLE
- DLC DETECTOR LEAD-IN CABLE
- EVUD EMERGENCY VEHICLE (DETECTION) UNIT
- LED LIGHT-EMITTING DIODE
- LMA LUMINAIRE MAST ARM
- LTG LIGHTING SERVICE CABLE
- MTG MOUNTING
- PEC PHOTOELECTRIC CONTROL
- PEU PHOTOELECTRIC UNIT
- PPB PEDESTRIAN PUSHBUTTON
- SMA SIGNAL MAST ARM
- SV PG&E SERVICE
- TS TRAFFIC SIGNAL

| LOC | EQUIPMENT | TYPE | DESCRIPTION |
|-----|-----------------|--------------|---|
| 1 | CONTROLLER | MODEL 2070LX | INSTALL MCCAIN CONTROLLER AND TYPE 332 CABINET |
| 2 | SERVICE CABINET | TESCO III BF | CITY TRAFFIC STD. IV-D & STD.-731 |
| 3 | PULL BOX | 30"X48" | (N48) CITY TRAFFIC STD. STD.-730 |
| 4 | PULL BOX | NO. 5 | CITY TRAFFIC STD. STD.-730 |
| 5 | PULL BOX | NO. 6 | CITY TRAFFIC STD. STD.-730 |
| 6 | WIRELESS BRIDGE | | SECOND WIRELESS BRIDGE WILL BE AT BURT STREET AND SANTA ROSA AVENUE |
| 7 | BATTERY BACKUP | | SEE SPECIAL PROVISIONS SECTION 86-3.02 |
| 8 | PULL BOX | NO. 6 | CITY TRAFFIC STD. STD.-730 |
| 9 | PULL BOX | NO. 6 | CITY TRAFFIC STD. STD.-730 |
| 10 | PULL BOX | NO. 5 | CITY TRAFFIC STD. STD.-730 |
| 11 | PULL BOX | NO. 5 | CITY TRAFFIC STD. STD.-730 |

